



Century Court

Grove End Road, NW8

Asking Price £1,395,000

A lovely 3 bedroom, 2 bathroom balcony apartment situated on the second floor (with lifts) of this portered building just behind Lord's Cricket Ground.

The apartment is offered in good decorative condition throughout and boasts an 18ft kitchen/breakfast room.

Century Court is located close to the junction of Grove End Road and St John's Wood Road.

CHESTERTONS



Century Court

Grove End Road, NW8

- 3 Bedrooms, 2 Bathrooms
- Share of Freehold
- 1,203 sq. ft.
- Balcony
- Lift
- Porter
- Close to Lord's Cricket Ground



Tenure: Share of Freehold

Service Charge: £15,736pa Includes £2,896pa into the sinking fund.

Ground Rent: £0

Local Authority: City of Westminster

Council Tax Band: G

Energy Efficiency Rating		
	Current	Potential
Very energy efficient - lower running costs		
A (94-100)		
B (81-93)		
C (69-80)	71	73
D (55-68)		
E (39-54)		
F (21-38)		
G (1-20)		
Not energy efficient - higher running costs		
England, Scotland & Wales EU Directive 2002/91/EC		

Chestertons St John's Wood Sales

105 St. John's Wood Terrace

London

NW8 6PL

stjohnswood@chestertons.co.uk

020 3040 8611

chestertons.co.uk

Century Court,
Grove End Road, NW8

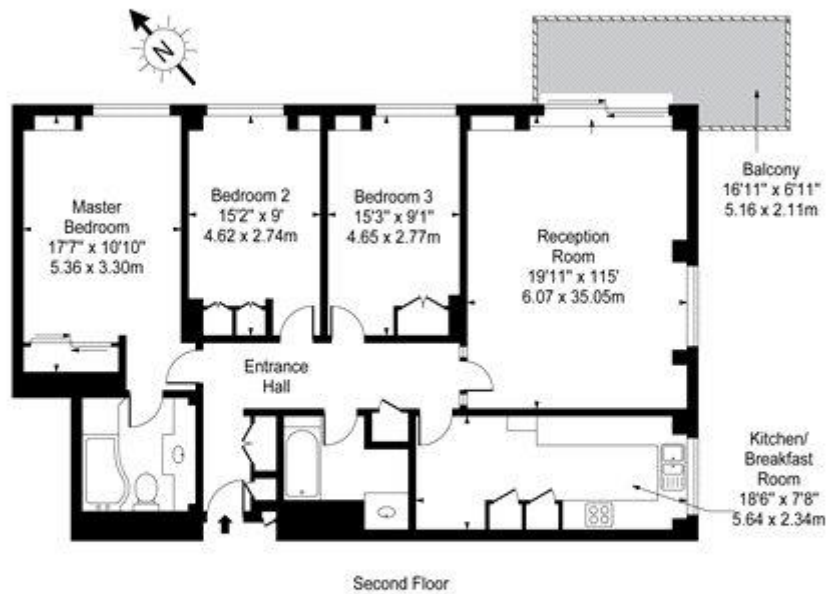

Approx Gross Internal Area 1203 Sq Ft - 111.76 Sq M

For Illustration Purposes Only - Not To Scale Floor Plan by www.nogaphotostudio.com Ref: No.19619

This floor plan should be used as a general outline for guidance only. Any intending purchaser or lessee should satisfy themselves by inspection searches, enquiries and full survey as to the correctness of each statement. Any areas, measurements or distances quoted are approximate and should not be used to value a property or be the basis of any sale or let.

