



Regents Plaza Apartments

8 Greville Road, NW6

Asking Price £825,000

An extremely large (1,172 sq. ft.) 2 bedroom, 2 bathroom apartment situated on the 1st floor of this portered apartment building.

The property is presented in excellent decorative condition throughout and has an amazing and bright 25ft open plan reception room and kitchen. The apartment further benefits from one underground parking space.

Regents Plaza has 24 hour portage and is perfectly located for multiple transport links into central London.



Regents Plaza Apartments

8 Greville Road, NW6

- 2 Bedrooms, 2 Bathrooms
- 1172 sq. ft.
- 970 Year Leasehold
- Parking
- Porter
- Passenger Lift



Tenure: Leasehold

Service Charge: £6,800pa (Includes C/H & H/W)

Ground Rent: £400pa

Local Authority: Camden

Council Tax Band: G

Energy Efficiency Rating		
	Current	Potential
Very energy efficient - lower running costs		
A (94-100)		
B (81-93)		
C (69-80)	80	81
D (55-68)		
E (39-54)		
F (21-38)		
G (1-20)		
Not energy efficient - higher running costs		
England, Scotland & Wales EU Directive 2002/91/EC		

Chestertons St John's Wood Sales

105 St. John's Wood Terrace

London

NW8 6PL

stjohnswood@chestertons.co.uk

020 3040 8611

chestertons.co.uk

**Regents Plaza Apartments,
Greville Road, NW6**

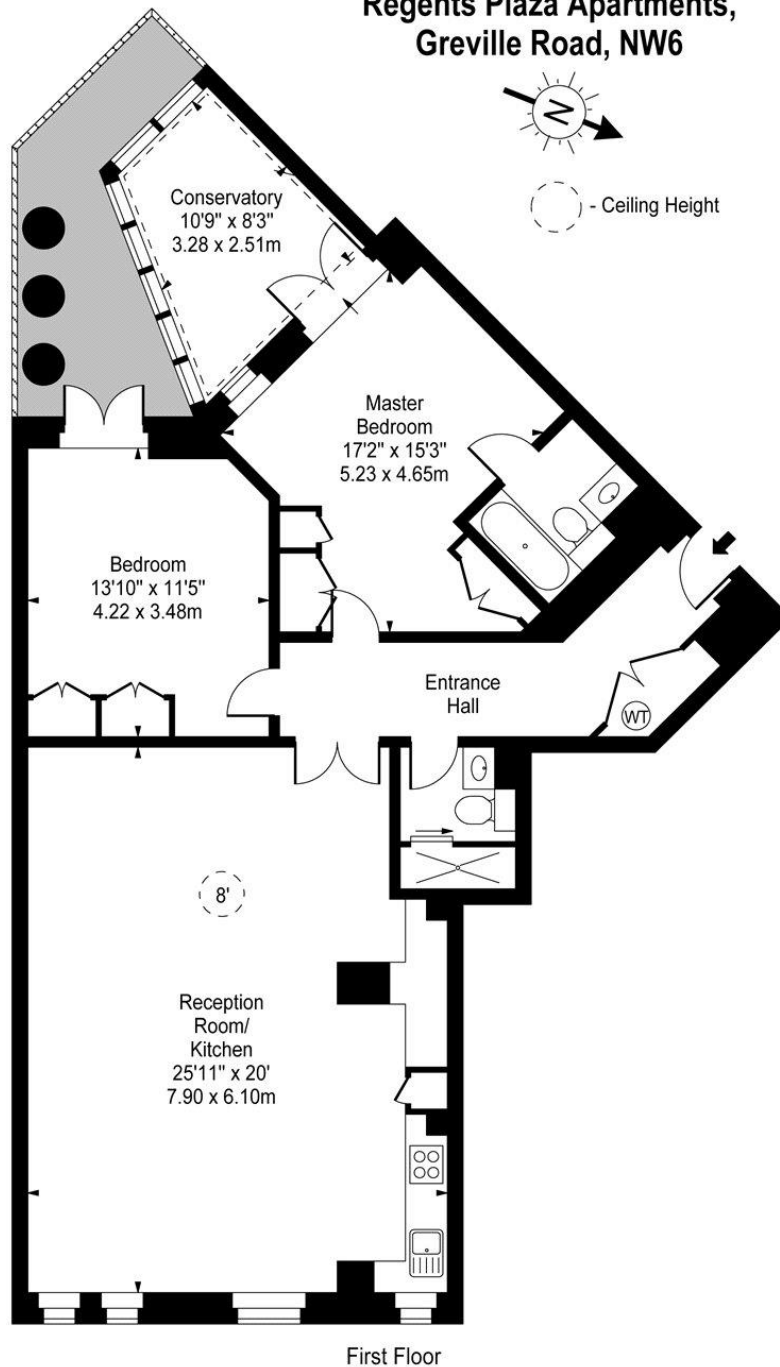

Approx Gross Internal Area 1172 Sq Ft - 108.88 Sq M

For Illustration Purposes Only - Not To Scale

www.goldlens.co.uk

Produced for Chestertons

Ref. No. 009731K

