



# Randolph Court

25-27 Belgrave Gardens, NW8

Asking Price £485,000

Sole Agent. A bright and spacious one bedroom apartment on the 2<sup>nd</sup> floor of a purpose-built block.

The property comprises, reception room, separate kitchen, double bedroom and a bathroom.

Randolph Court is located on Belgrave Gardens, a residential road in St John's Wood close to the shops and cafés of Boundary Road, and the transport links of Maida Vale and St John's Wood (Jubilee Line).





# Randolph Court

25-27 Belgrave Gardens, NW8

- One Bedroom Apartment
- Share of Freehold
- 493 sq. ft.
- Good Condition
- Close to Abbey Road



**Tenure:** Share of Freehold  
**Service Charge:** £2,025pa  
**Ground Rent:** £0  
**Local Authority:** City of Westminster  
**Council Tax Band:** D

Energy Efficiency Rating		
	Current	Potential
Very energy efficient - lower running costs		
<b>A</b> (92-100)		
<b>B</b> (81-91)		
<b>C</b> (69-80)	75	80
<b>D</b> (55-68)		
<b>E</b> (39-54)		
<b>F</b> (21-38)		
<b>G</b> (1-20)		
Not energy efficient - higher running costs		
England, Scotland & Wales		EU Directive 2002/91/EC

### *Chestertons St John's Wood Sales*

105 St. John's Wood Terrace  
 London  
 NW8 6PL  
 stjohnswood@chestertons.co.uk  
 020 3040 8611  
 chestertons.co.uk

# Randolph Court, Belgrave Gardens, NW8

○ - Ceiling Height

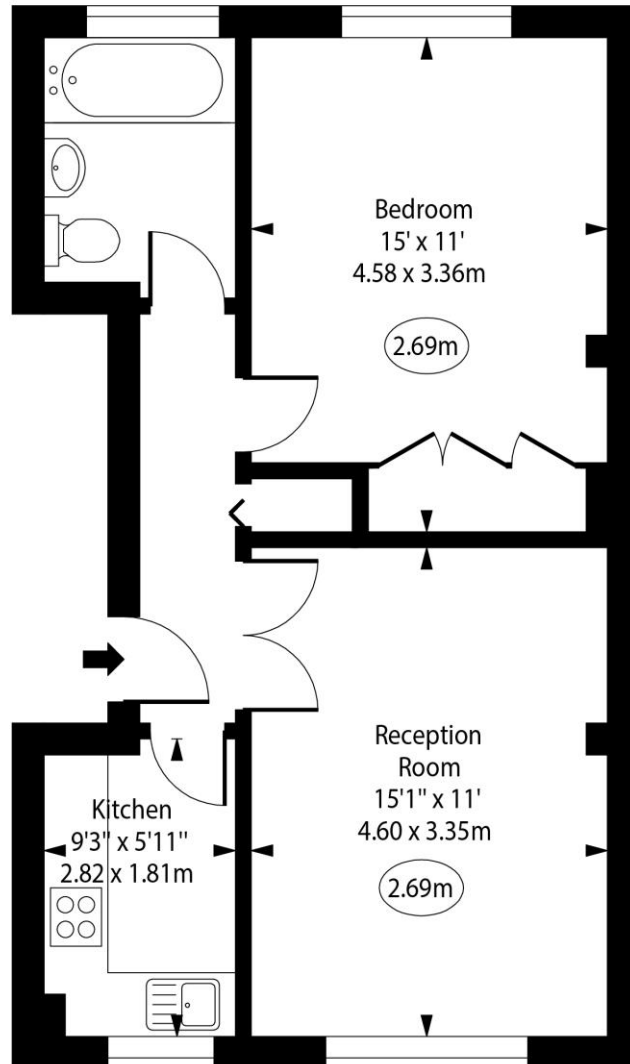

Second Floor

Approx Gross Internal Area      493 Sq Ft - 45.80 Sq M

For Illustration Purposes Only - Not To Scale

[www.goldlens.co.uk](http://www.goldlens.co.uk)

Produced for Chestertons

Ref. No. 026137J

