



Abbey Lodge

Park Road, NW8

Asking Price £8,825,000

A truly magnificent 6 bedroom, 6 bathroom apartment with stunning views over Regent's Park, set in a secure portered mansion block.

This luxurious apartment offers 3,690 sq. ft. of lateral accommodation and comprises; double reception room, dining room, large fully fitted kitchen with Gaggenau appliances, 6 bedrooms, 6 bathrooms, study, guest WC and a utility room.

The building benefits from 24 hour concierge and off street parking on a first come, first served basis and is ideally located for Regent's Park, St John's Wood & Marylebone.



Abbey Lodge

Park Road, NW8

- 6 Bedroom, 6 Bathroom Apartment
- 114 Year Leasehold
- 3,690 sq. ft.
- Superb Condition
- 24 Hour Porter
- Communal Garden
- Very Close to Regent's Park



Tenure: Leasehold
Service Charge: £35,356pa
Ground Rent: TBC
Local Authority: Westminster
Council Tax Band: H

Energy Efficiency Rating		Current	Potential
Very energy efficient - lower running costs			
(92-100)	A		
(81-91)	B		
(69-80)	C	74	85
(55-68)	D		
(39-54)	E		
(21-38)	F		
(1-20)	G		
Not energy efficient - higher running costs			
England, Scotland & Wales		EU Directive 2002/91/EC	

Chestertons St John's Wood Sales

105 St. John's Wood Terrace
London
NW8 6PL
stjohnswood@chestertons.co.uk
020 3040 8611
chestertons.co.uk

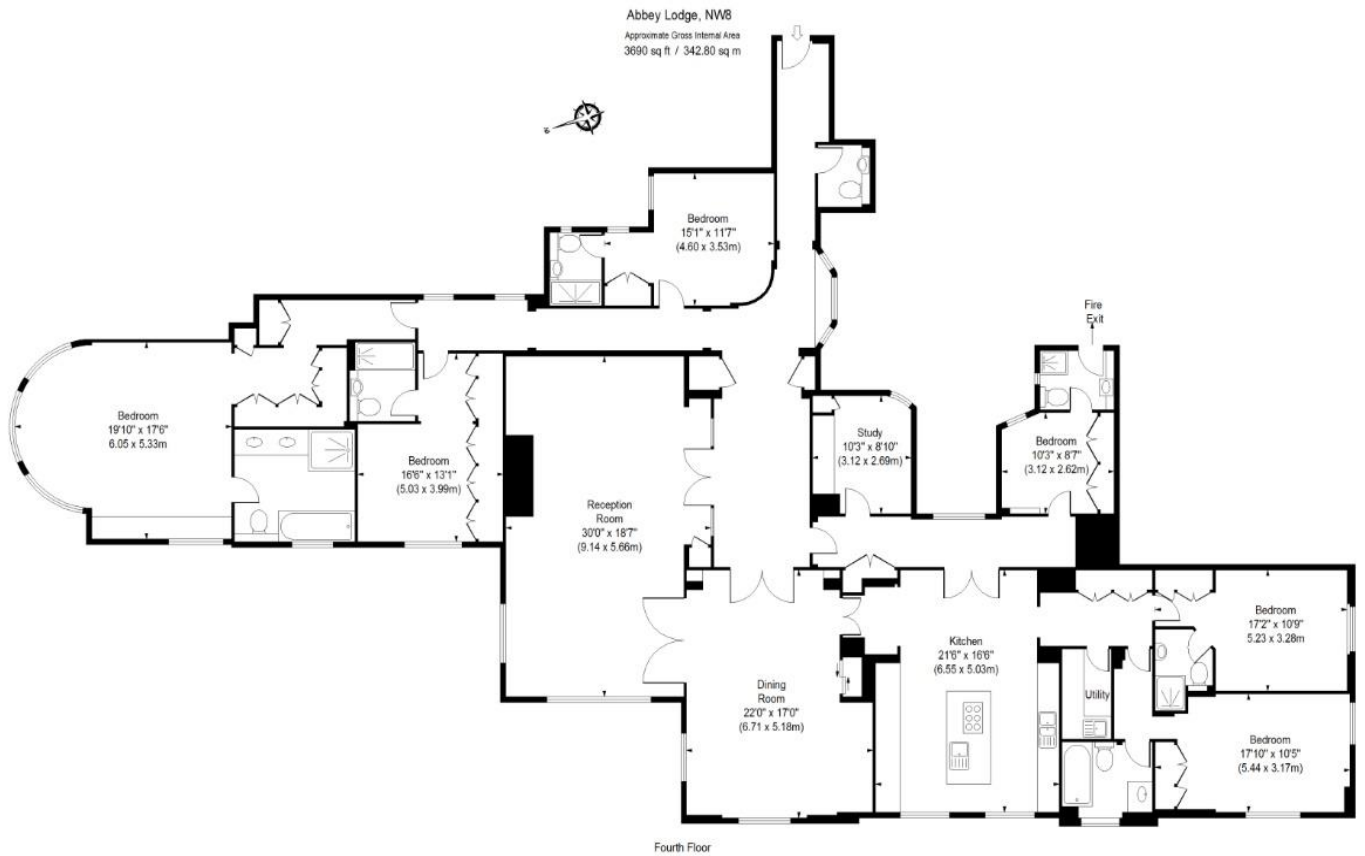

ILLUSTRATION FOR IDENTIFICATION PURPOSES ONLY

ALL MEASUREMENTS ARE MAXIMUM AND INCLUDE WINDOW BAYS AND WARDROBES WHERE APPLICABLE
THIS PLAN MUST NOT BE REPRODUCED BY ANY OTHER PERSON WITHOUT PERMISSION

