



Grove End House

Grove End Road, NW8

Asking Price £645,000

A very bright 2 bedroom apartment positioned on the 3rd floor (with lift) of this period building on Grove End Road.

The apartment is offered in good decorative condition throughout and boasts 2 double bedrooms and a bright reception room with very good ceiling height.

Grove End House is approximately half a mile from St John's Wood Underground station (Jubilee Line) and less than 200m from Lord's Cricket Ground.



Grove End House

Grove End Road, NW8

- 2 Bedroom Apartment
- Long Leasehold
- 659 sq. ft.
- Porter
- Communal Garden
- Lift



Tenure: Leasehold 124 years remaining.

Service Charge: £5,100 pa.

Ground Rent: £0

Local Authority: Westminster

Council Tax Band: E

Energy Efficiency Rating		Current	Potential
Very energy efficient - lower running costs			
(92-100)	A		82
(81-91)	B		
(69-80)	C	72	
(55-68)	D		
(39-54)	E		
(21-38)	F		
(1-20)	G		
Not energy efficient - higher running costs			
England, Scotland & Wales		EU Directive 2002/91/EC	

Chestertons St John's Wood Sales

105 St. John's Wood Terrace

London

NW8 6PL

stjohnswood@chestertons.co.uk

020 3040 8611

chestertons.co.uk

Grove End House,
Grove End Road,
St John's Wood, NW8

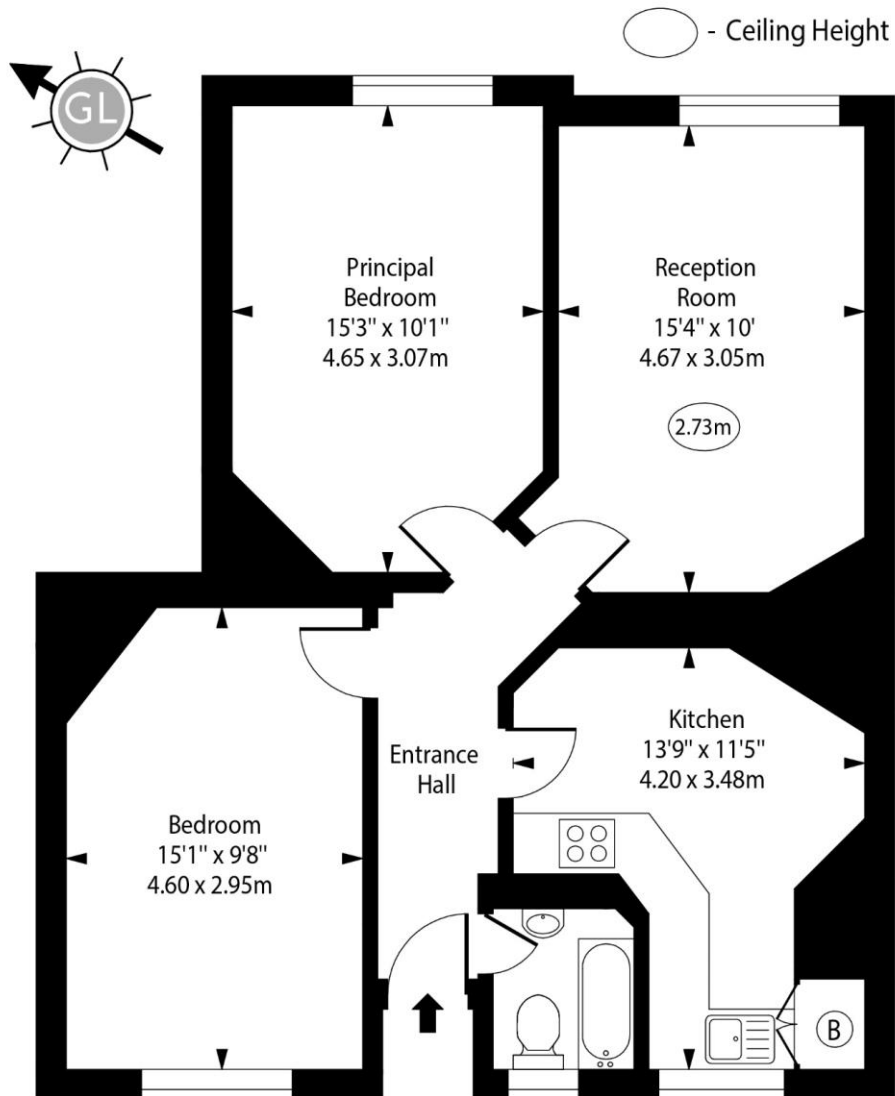

Third Floor

Approx Gross Internal Area 659 Sq Ft - 61.22 Sq M

For Illustration Purposes Only - Not To Scale

www.goldlens.co.uk

Produced for Chestertons

Ref. No. 023428J

