



67 Blackheath Road, Pakefield, Suffolk, NR33 7JE

Introducing a charming semi-detached family home featuring three separate bedrooms, an open plan lounge/diner and a modern kitchen and bathroom. Enjoy the comforts of gas central heating and double glazing throughout in this sought-after location. This beautiful property boasts a fully enclosed rear garden and is conveniently situated close to local shops and amenities.

- Semi-detached family home
- 3 separate bedrooms
- Open plan lounge/diner
- Modern kitchen & bathroom
- Gas central heating
- Double glazing throughout
- Sought after location
- Close to local shops & amenities
- Fully enclosed rear garden with log cabin
- Available to rent now!

£900 Per Calendar Month

GROUND FLOOR

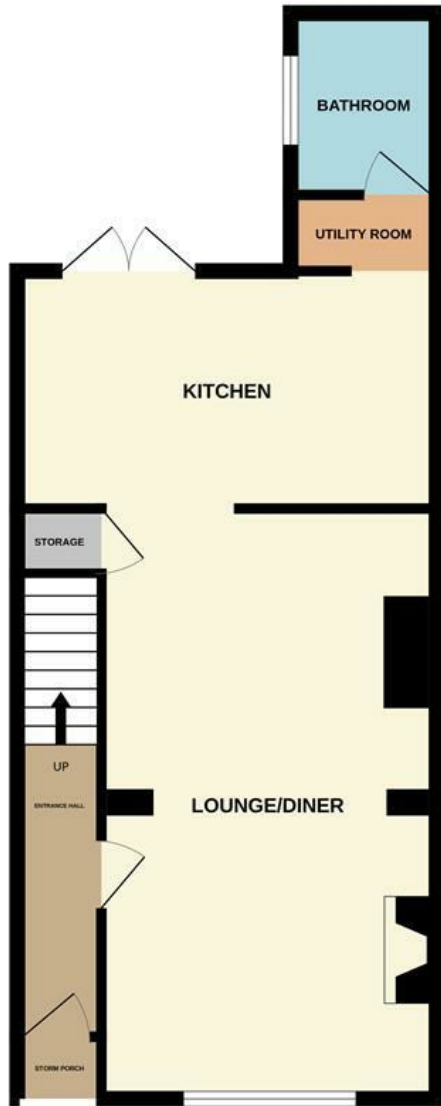

1ST FLOOR

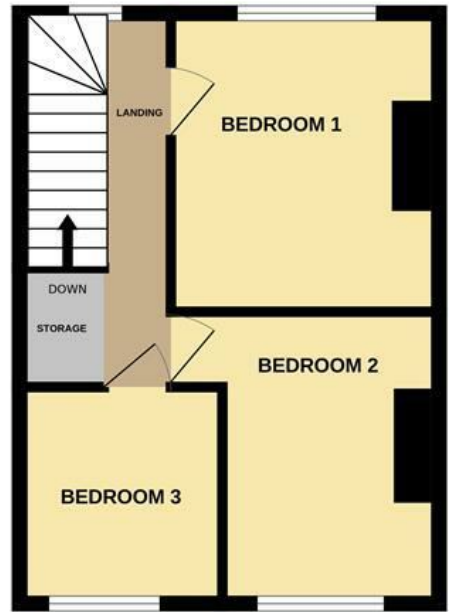

Whilst every attempt has been made to ensure the accuracy of the floorplan contained here, measurements of doors, windows, rooms and any other items are approximate and no responsibility is taken for any error, omission or mis-statement. This plan is for illustrative purposes only and should be used as such by any prospective purchaser. The services, systems and appliances shown have not been tested and no guarantee as to their operability or efficiency can be given.
Made with Metropix ©2024

Energy Efficiency Rating		Current	Potential
Very energy efficient - lower running costs			
(92 plus) A			86
(81-91) B			
(69-80) C			
(55-68) D		63	
(39-54) E			
(21-38) F			
(1-20) G			
Not energy efficient - higher running costs			
England & Wales		EU Directive 2002/91/EC	