

Tenure: Freehold
 Council Tax Band: A
 EPC Rating:
 Local Authority: East Suffolk Council

Energy Efficiency Rating		
	Current	Potential
Very energy efficient - lower running costs		
(92 plus) A		
(81-91) B		
(69-80) C		
(55-68) D		
(39-54) E		
(21-38) F		
(1-20) G		
Not energy efficient - higher running costs		
England & Wales	EU Directive 2002/91/EC	

£105,000
 Offers In Excess Of

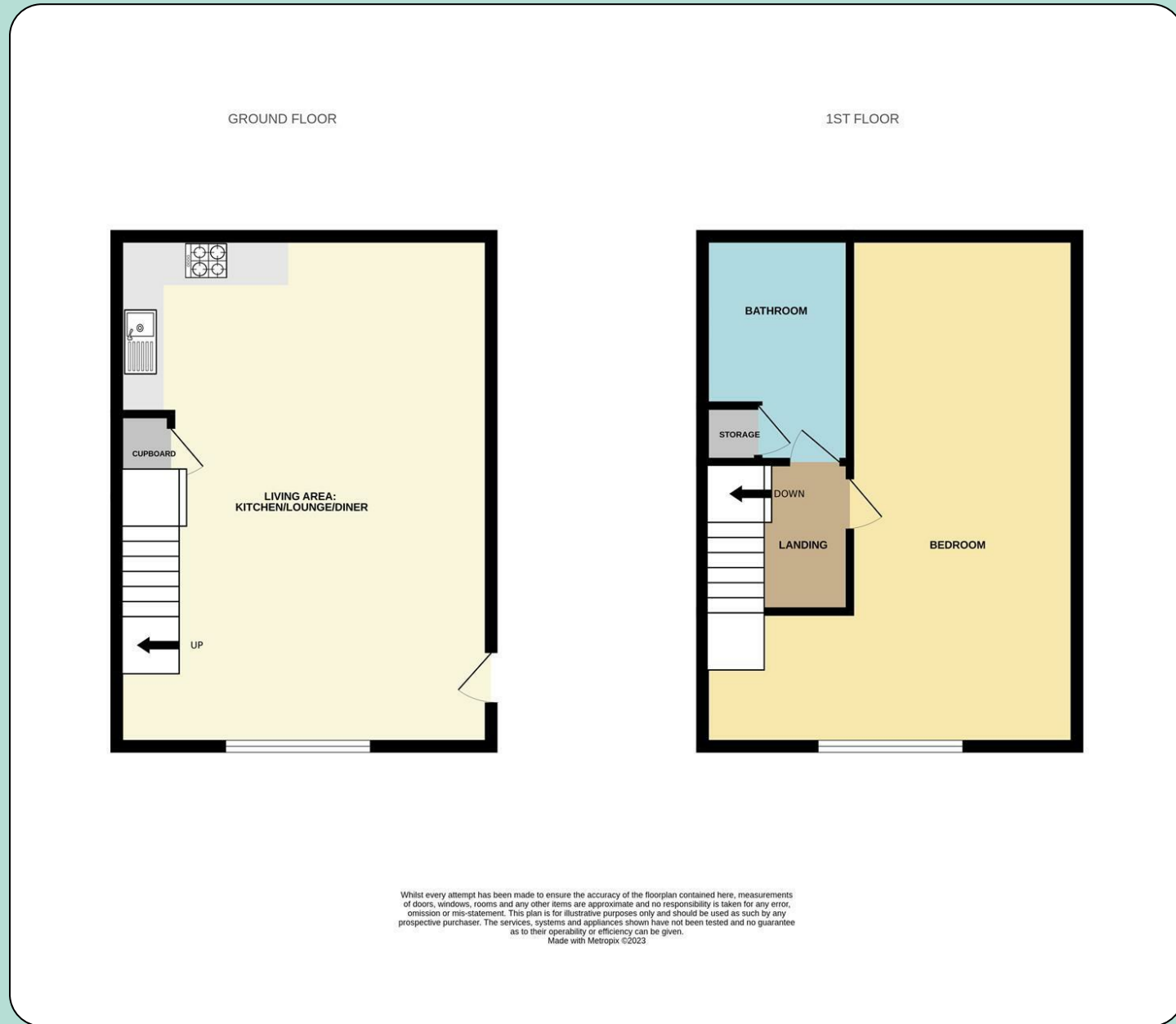

Stanley Street
 , NR32 2DY

- Stunning Historic Maisonette Conversion
- Chain Free And Ready To Go
- Stunning Mix Of Modern And Original Features
- Fantastic Capital Growth And Yield Potential
- Close To Town Centre & Transport Links
- 1 Double Bedroom
- Light & Spacious Throughout
- Ideal Location
- Open Plan Living Space
- Currently tenanted and receiving £625.00 pcm



Paul Hubbard Estate Agents
 178-180 London Road South
 Lowestoft
 Suffolk
 NR33 0BB

Contact Us
www.paulhubbardonline.com
 01502 531218
info@paulhubbardonline.com

Agents Note: Whilst every care has been taken to prepare these sales particulars, they are for guidance purposes only. All measurements are approximate and for general guidance purposes only and whilst every care has been taken to ensure their accuracy, they should not be relied upon and potential buyers are advised to recheck the measurements

e - info@paulhubbardonline.com

t - 01502 531218



Location

This historic maisonette is located just walking distance from the main town centre and close to other local amenities within the heart of North Lowestoft, an English Coastal Town nestled in the most easterly point of the British Isles. With award-winning sandy beaches and breath-taking Victorian seafront gardens. Explore the Royal Plain Fountains, two piers, and a variety of independent eateries that will tantalise your taste buds. Education is a top priority here, with excellent schools for all ages. Commuting is a breeze with a bus station and train station that offer regular services to Norwich and surrounding areas. Located just 110 miles north-east of London, 38 miles north-east of Ipswich, and 22 miles south-east of Norwich.

Entrance

Charming timber front door opening into entrance hall.

Main Living Area

5.9 x 5.6

Front door opening into living area with timber window to side, laminate flooring throughout, stairs leading to first floor landing and door opening to under stair storage cupboard.

Modern kitchen units above and below laminate work surfaces and tiled splashback. Stainless steel sink with drainer, integrated oven, induction hob and extractor fan with spaces for fridge and washing machine.

First Floor Landing

Carpet flooring throughout with doors opening to bedroom and bathroom.

Bathroom

2.7 x 2.0

Modern bathroom suite comprising of a panel bath with shower attachment, toilet and vanity sink, tiled splashbacks and heated towel rail. Door opening to airing cupboard and vinyl flooring throughout.

Bedroom

7.3 x 5.4

Timber window to side with carpet flooring throughout and original beam features throughout.

Financial Services

If you would like to know if you can afford this

property and how much the monthly repayments would be, Paul Hubbard Estate Agents can offer you recommendations on financial/mortgage advisors, who will search for the best current deals for first time buyers, buy to let investors, upsizers and relocators. Call or email in today to arrange your free, no obligation quote.

