



14 Celandine Close, Carlton Colville, Suffolk, NR33 8EU

This well-presented, fully furnished home offers a comfortable stay with two bedrooms. The tasteful décor complements the open-plan layout and the fully equipped kitchen includes appliances. Enjoy a private west-facing rear garden in a convenient Carlton Colville location, close to local shops and amenities. It's the perfect home away from home. Available from MAY 1ST 2024 from £2000 per month including bills for lets between 1 - 12 months

- Well presented property
- 2 bedrooms
- Fully furnished
- Private west facing rear garden
- Close proximity to local shops and amenities
- Tastefully decorated throughout
- Convenient Carlton Colville location
- Open plan layout
- Appliances provided
- Fully equipped kitchen

£2,000 Per Calendar Month

GROUND FLOOR

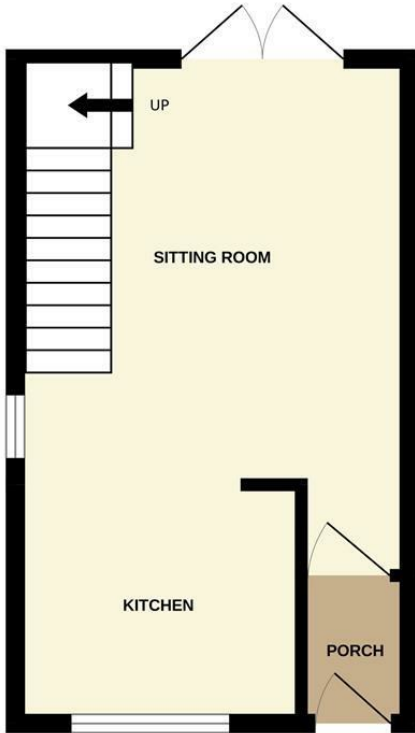

1ST FLOOR

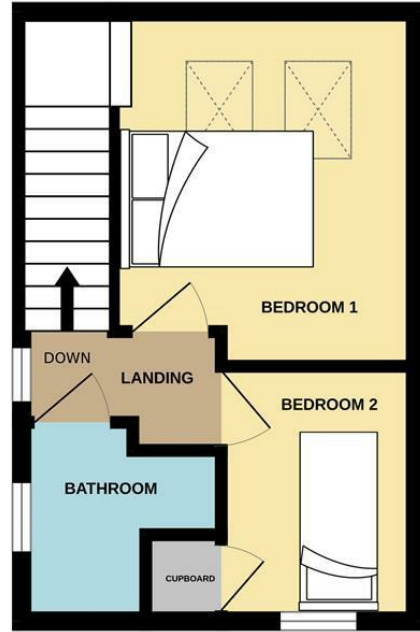

Whilst every attempt has been made to ensure the accuracy of the floorplan contained here, measurements of doors, windows, rooms and any other items are approximate and no responsibility is taken for any error, omission or mis-statement. This plan is for illustrative purposes only and should be used as such by any prospective purchaser. The services, systems and appliances shown have not been tested and no guarantee as to their operability or efficiency can be given.
Made with Metropix ©2023

Energy Efficiency Rating		Current	Potential
<i>Very energy efficient - lower running costs</i>			
(92 plus) A			
(81-91) B			
(69-80) C			
(55-68) D			
(39-54) E			
(21-38) F			
(1-20) G			
<i>Not energy efficient - higher running costs</i>			
England & Wales	EU Directive 2002/91/EC		