



Sarre Avenue, Hornchurch, RM12 6TP
Offers over £225,000

Jenkins
Property

T: 01277228620

E: SALES@JENKINS-PROPERTY.COM

WWW.JENKINS-PROPERTY.COM

Jenkins
Property

OFFERS OVER £225,000 ** REALISTICALLY PRICED** In need of refurbishment ** One bedroom first floor maisonette located in a cul-de-sac with local shops close by. This first floor maisonette enjoys its own private back garden and favours from being share of freehold. The property requires a new kitchen and bathroom which is reflected in the lower guide price.

- First Floor
- Own Private Rear Garden
- Close to Local Shops
- One Bedroom
- Realistically Priced For Quick Sale
- Long Lease
- Alocated Parking
- Share of Freehold
- Seperate Kitchen
- End Of Chain

Entrance area

Landing

Living Area 12'3" x 13' (3.73m" x 3.96m)

Kitchen 5'4" x 7'11" (1.63m" x 2.41m")

Bedroom 9'7" x 8'7" (2.92m" x 2.62m")

Bathroom 5'4" x 7'8" (1.63m" x 2.34m")

Exterior

Private rear garden approached via side gate.

Alocated Parking Space

Agents Note

Share of Freehold
Lease 172 years remaining
No Ground Rent
No Maintenance
Council tax band C
EPC C



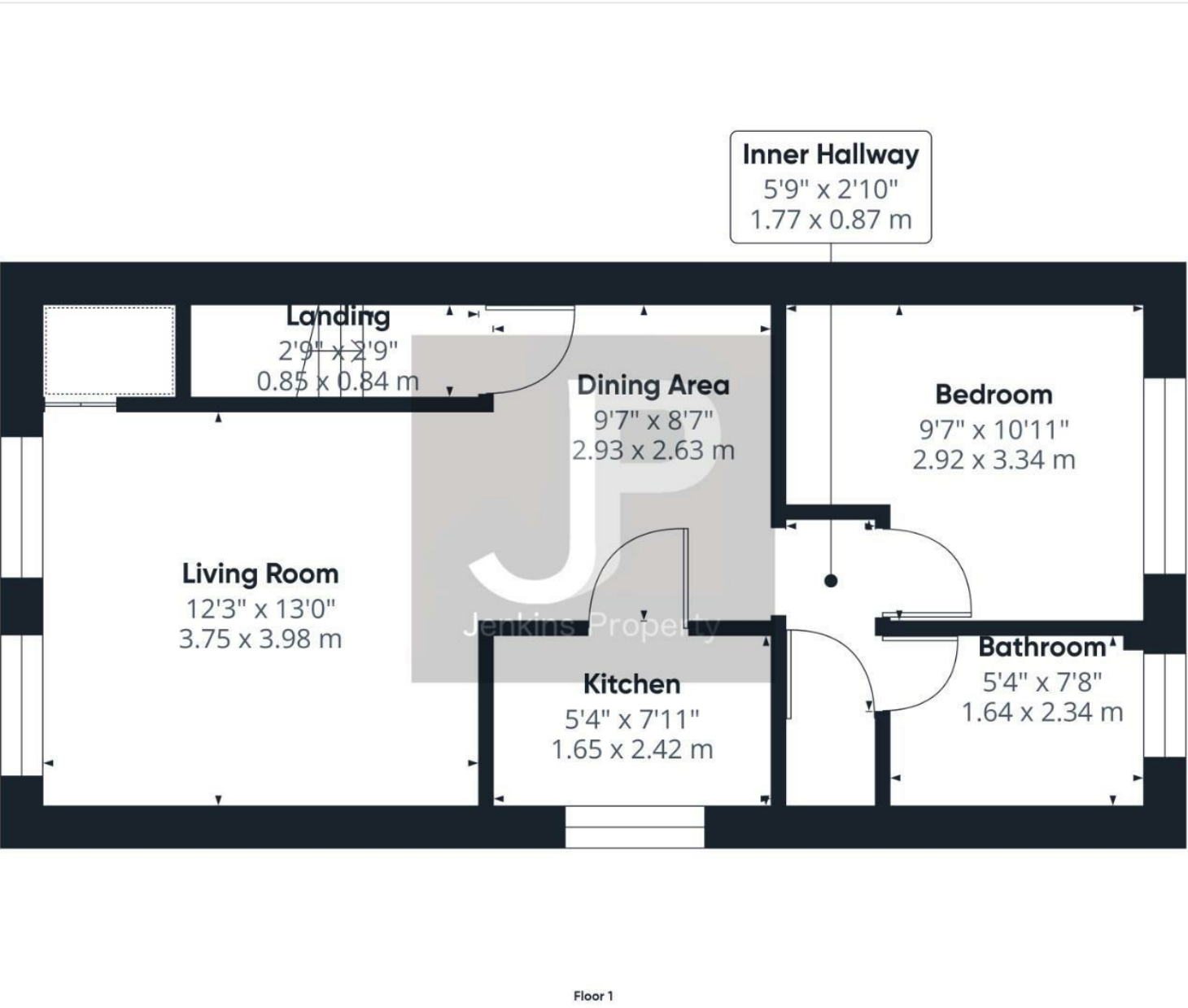

Approximate total area[®]
455.1 ft²
42.28 m²

(1) Excluding balconies and terraces

While every attempt has been made to ensure accuracy, all measurements are approximate, not to scale. This floor plan is for illustrative purposes only.

Calculations were based on RICS IPMS 3C standard. Please note that calculations were adjusted by a third party and therefore may not comply with RICS IPMS 3C.

GIRAFFE360

