



JP
Jenkins Property

Cromwell Road, Brentwood, CM14 5DZ
£415,000

Jenkins
Property

T: 01277228620

E: SALES@JENKINS-PROPERTY.COM

WWW.JENKINS-PROPERTY.COM

Charming Essex boarded semi-detached cottage favouring a predominant position in a popular Road. This delightful property boasts an open plan reception room, perfect for relaxing with family and friends or entertaining. With two inviting bedrooms, there is ample space for a small family or guests to stay comfortably. The cottage also features a well-appointed first floor bathroom. Enjoying being very close to Brentwood station and Town centre adding convenience to everyday living.

- Close to Station
- Open Plan Lounge/Diner
- Modern Kitchen
- Popular Location
- Character Cottage
- First floor Contemporary Bathroom
- Off Street Parking
- Two good Size Bedrooms

Entrance Hall 9'8" x 3'9" (2.95m" x 1.14m")

Kitchen 7'9" x 10" (2.36m" x 3.05m')

Living Room 17'8" x 15" (5.38m" x 4.57m')

Landing

Bedroom One 10'3" x 10'9" (3.12m" x 3.28m)

Bedroom Two 7'11" x 9'11" (2.41m" x 3.02m")

Bathroom 6'11" x 4'10" (2.11m" x 1.47m)

Exterior

Rear Garden

Front Garden

Off street parking





Ground Floor

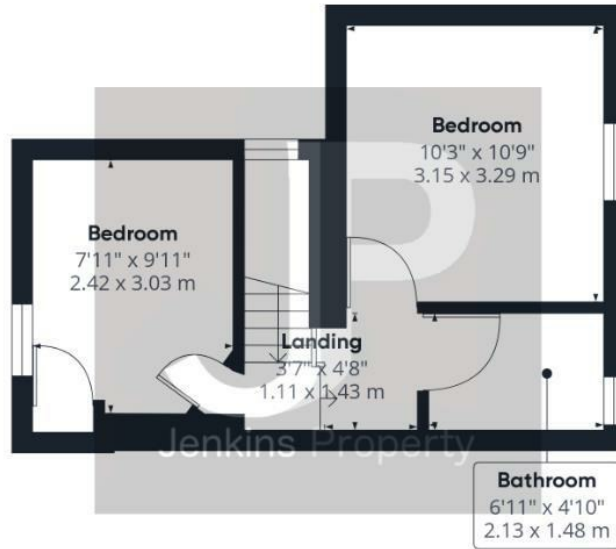

Floor 1



Approximate total area⁽¹⁾

654.45 ft²
60.8 m²

(1) Excluding balconies and terraces

While every attempt has been made to ensure accuracy, all measurements are approximate, not to scale. This floor plan is for illustrative purposes only.

Calculations are based on RICS IPMS 3C standard.

GIRAFFE 360

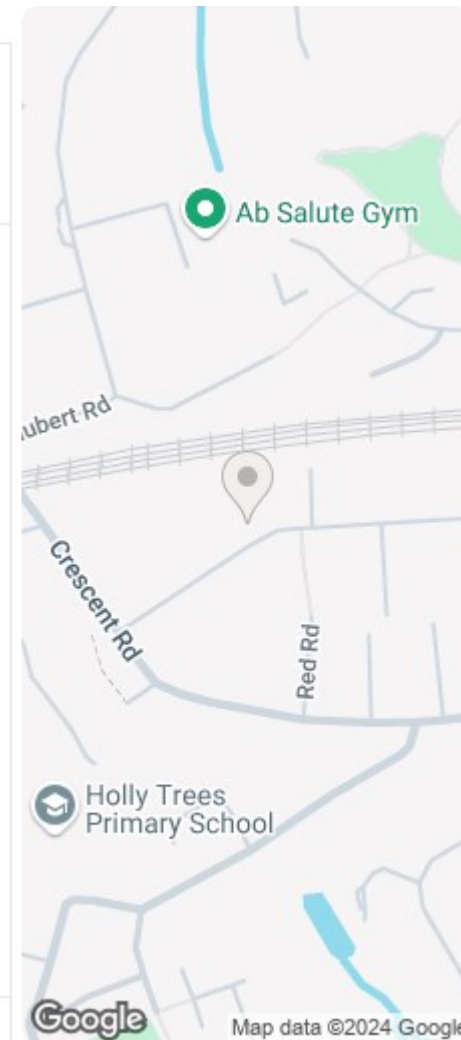

Energy Efficiency Rating		Environmental Impact (CO ₂) Rating	
Current	Potential	Current	Potential
87	87	A	A
67	87	B	A
		C	B
		D	C
		E	D
		F	E
		G	F
			G

Not energy efficient - higher running costs

Not energy efficient - higher running costs

Not environmentally friendly - lower CO₂ emissions

Not environmentally friendly - higher CO₂ emissions

England & Wales EU Directive 2002/91/EC

England & Wales EU Directive 2002/91/EC

