



Celeborn Street, Chelmsford, CM3 7AW
Best offers over £1,500,000

Jenkins
Property

T: 01277228620

E: SALES@JENKINS-PROPERTY.COM

WWW.JENKINS-PROPERTY.COM

Situated in one of if not the most desirable locations in town, backing on to 'Fenn Creek' and over looking the open fields and countryside beyond, enjoying an ever changing vista of the seasons, This house of dreams sits on a plot of 0.42 of an acre and has been owned by the current family since they commission the house be designed to their own specification by renowned local architect John Leighton, with the building constructed by Giles developments of Maldon, a true family home in every sense.

- Unique Detached Residence
- Four bedrooms
- Four bathrooms
- Three reception rooms
- Galleried First floor hallway
- Stunning views of 'Fenn Creek'
- Swimming Pool/Aquatrac cover
- Double garage

Ample driveway to front
Entrance Hallway 6'9" x 14'8" (5.12 x 4.49)
6'0" x 2'9" (5.12 x 0.85)

Guest Cloakroom Wc 5'4" x 3'8" (1.65 x 1.14)

Office 10'7" x 8'0" (3.25 x 2.44)

Kitchen 19'5" x 9'8" (5.92 x 2.97)

Breakfast room 11'2" x 9'3" (3.42 x 2.83)

Utility room 9'6" x 7'10" (2.92 x 2.39)

Formal dining room 15'7" x 12'7" (4.77 x 3.86)

Sun room conservatory 14'2" x 9'8" (4.33 x 2.97)

Living room 29'1" x 16'9" (8.89 x 5.12)

Galleried Hallway 16'9" x 14'4" (5.12 x 4.38)

Master bedroom 16'10" x 12'9" (5.14 x 3.89)

En-suite Dressing room 12'5" x 9'0" (3.80 x 2.76)

Landscaped gardens
En-suite Bathroom 9'10" x 7'6" (3.01 x 2.30)

Bedroom 16'10" x 8'11" (5.14 x 2.72)

Family bathroom 9'8" x 8'9" (2.96 x 2.69)

Bedroom 13'9" x 9'5" (4.20 x 2.88)

Jack & Jill En-suite shower room 8'11" x 3'10" (2.74 x 1.17)

Bedroom 13'9" x 8'3" (4.20 x 2.52)

Bedroom 15'5" x 9'3" (4.70 x 2.82)

En-suite shower room 9'2" x 3'10" (2.81 x 1.19)

Pool house / Shower room 10'9" x 7'10" (3.30 x 2.41)

Double garage 20'2" x 18'2" (6.17 x 5.55)



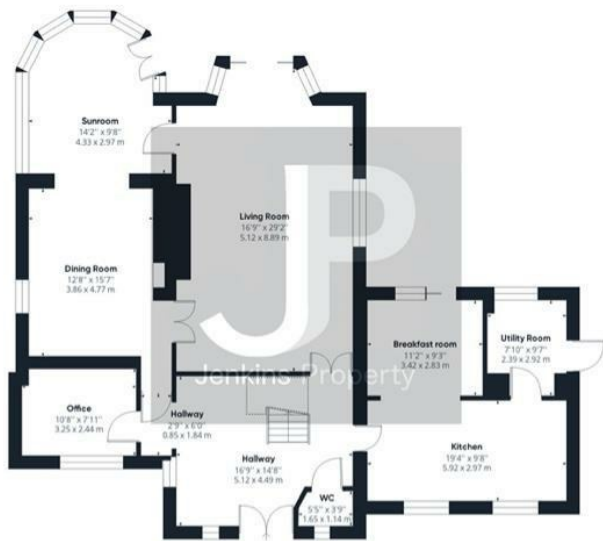

Ground Floor Building 1

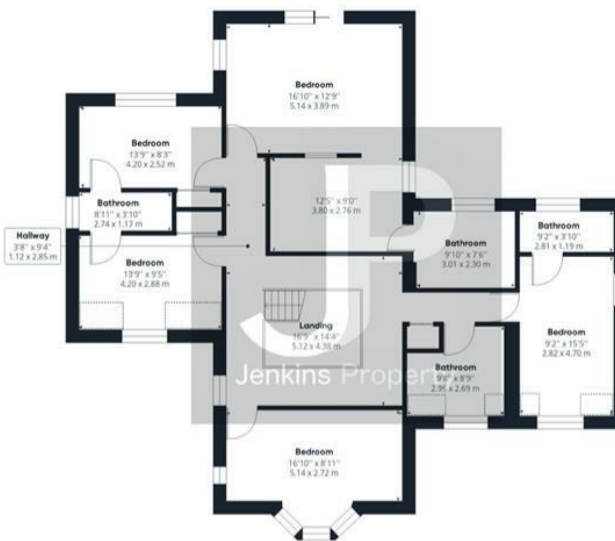

Floor 1 Building 1



Ground Floor Building 2



Ground Floor Building 3

Approximate total area⁽¹⁾

3517.91 ft²
326.82 m²

Reduced headroom

67.25 ft²
6.25 m²

(1) Excluding balconies and terraces

Reduced headroom (below 1.5m/4.92ft)

While every attempt has been made to ensure accuracy, all measurements are approximate, not to scale. This floor plan is for illustrative purposes only.

GIRAFFE360

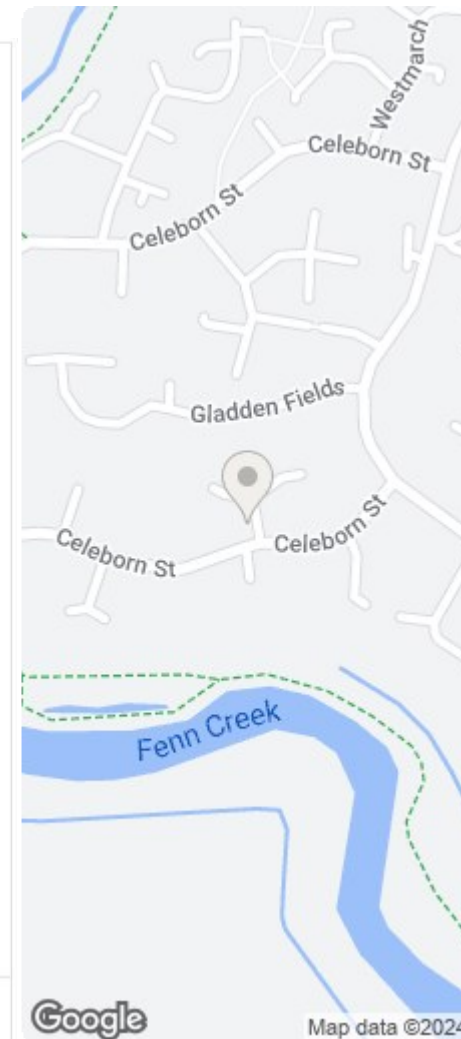

Google

Map data ©2024

Energy Efficiency Rating		Current	Target	Environmental Impact (CO ₂) Rating		Current	Target
Your energy efficient - lower running costs				Your environmentally friendly - lower CO ₂ emissions			
78-91	A			78-91	A		
69-77	B			71-77	B		
55-68	C			62-70	C		
48-54	D			55-61	D		
35-47	E			48-54	E		
21-34	F			41-47	F		
1-20	G			35-40	G		
Not energy efficient - higher running costs				Not environmentally friendly - higher CO ₂ emissions			
EU Directive 2002/91/EC				EU Directive 2002/91/EC			

England & Wales

EU Directive 2002/91/EC

England & Wales

EU Directive 2002/91/EC

