



High Road, Stanford-Le-Hope, SS17 9JJ
Offers in excess of £795,000

Jenkins
Property

T: 01277228620

E: SALES@JENKINS-PROPERTY.COM

WWW.JENKINS-PROPERTY.COM

Jenkins
Property

Beautifully presented property dating back to the 1800's in a beautiful village setting behind secure gates on a private shingle drive that also serves a further charming character property. This impressive former coach house offers versatile accommodation favouring a ground floor Master suite if desired. Additional outbuildings have been added in keeping with the existing dwelling incorporating a home office and summer house to further compliment this welcoming home.

- Solid Wood Shaker Style Kitchen
- Home Office and External Outbuildings
- Ground Floor Bedroom/Separate Reception
- Utility Room
- Luxury Family Bathroom
- Integrated Appliances
- Part Marble Flooring and Staircase
- Ground Floor Luxury Bathroom En Suite
- Three Further First Floor Bedrooms
- En-Suite to Master First Floor bedroom

Ground Floor

Porch 9'8" x 4'9" (2.95m x 1.45m)

Open Plan Living Kitchen / Dining Area 25'4" x 34'5" (7.74 x 10.50m)

Utility Room 4'8" x 15'2" (1.44m x 4.63m)

Ground Floor Bedroom 19'1" x 14'9" (5.82m x 4.52m)

Ground Floor En-suite 9'7" x 9'3" (2.94m x 2.82m)

Floor 1

Landing 12'9" x 10'8" (3.91m x 3.26m)

Bedroom 1 12'8" x 13'6" (3.88m x 4.12m)

Luxury En-suite Bathroom 6'9" x 8'10" (2.08m x 2.71m)

Bedroom 2 9'10" x 11'9" (3.00m x 3.59m)

Bedroom 3 9'9" x 11'10" (2.99m x 3.63m)

Luxury Family Bathroom 6'7" x 8'0" (2.03m x 2.44m)

Exterior

Summer House 12'1" x 17'1" (3.70m x 5.21m)

Out Buildings

Home Office 9'3" x 18'8" (2.83m x 5.70m)

Storage Room 10'4" x 12'7" (3.17m x 3.85m)

Storage Cupboard 5'1" x 3'2" (1.57m x 0.98m)



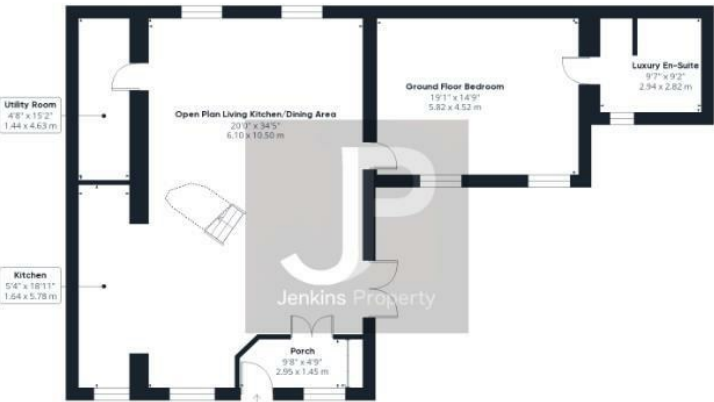

Ground Floor Building 1



Ground Floor Building 2

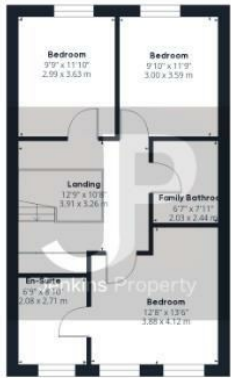

Floor 1 Building 1



Ground Floor Building 3



Approximate total area⁽¹⁾

2421.52 ft²
224.97 m²

Reduced headroom

18.03 ft²
1.67 m²

(1) Excluding balconies and terraces

Reduced headroom
(below 1.5m/4.92ft)

While every attempt has been made to ensure accuracy, all measurements are approximate, not to scale. This floor plan is for illustrative purposes only.

GIRAFFE360

