



**Highland Avenue, Brentwood, CM15 9DF**  
**£285,000**

**Jenkins**  
Property



Located within easy access to Brentwood town centre and station in a desirable residential turning with favourable schools close by, this ground floor two bedroom apartment offers 721.18 square feet of living space, ideally organised on a single ground level. Favoured by its own private patio garden accessed from the living area, this warm and inviting property extends to embrace five versatile rooms that can be moulded according to your needs, catering to the demands of work-from-home and individual lifestyle. Additionally, a utility room facilitates much convenience. This property garners attention with its versatile floor plan and thoughtful detailing, creating a perfect canvas for its future owner. Ideal investment opportunity. No chain.

- Garage
- Two Bedrooms
- Share Of Freehold
- Low Maintenance Charges
- Easy Access to Station
- Close to Supermarket and Town Centre
- Favourable Schools nearby
- Chain Free

**Hallway 15'3" x 3'5" (4.65m" x 1.04m")**

Maintenance £594.75 per quarter.  
EPCC  
Gas central heating and double glazing.  
Chain free

**Utility Room 4'2" x 3'6" (1.27m" x 1.07m")**

**Living Room 15'10" x 13'4" (4.83m" x 4.06m")**

Doors to Private patio area

**Kitchen 9'10" x 9'6" (3.00m" x 2.90m")**

**Bedroom 12'8" x 13'6" (3.86m" x 4.11m")**

**Bedroom 10'10" x 7' (3.30m" x 2.13m)**

**Shower Room 5'6" x 5'11 (1.68m" x 1.80m)**

#### Exterior

Communal tended gardens and car park area, own private patio garden.

#### Garage

#### Agents note

Share of freehold  
Lease 98 Years



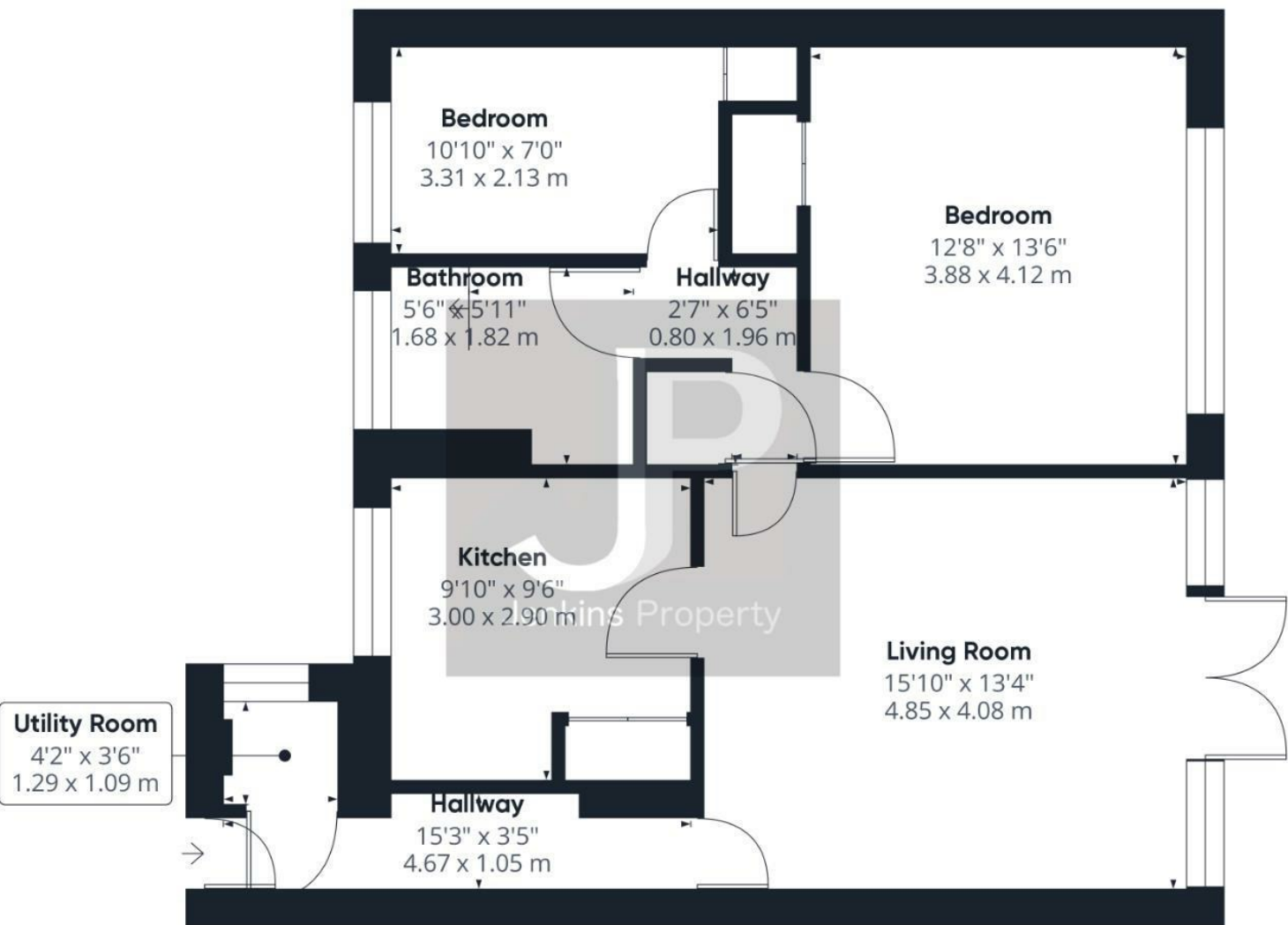

Approximate total area<sup>1)</sup>  
724.25 ft<sup>2</sup>  
67.28 m<sup>2</sup>

(1) Excluding balconies and terraces

While every attempt has been made to ensure accuracy, all measurements are approximate, not to scale. This floor plan is for illustrative purposes only.

GIRAFFE 360

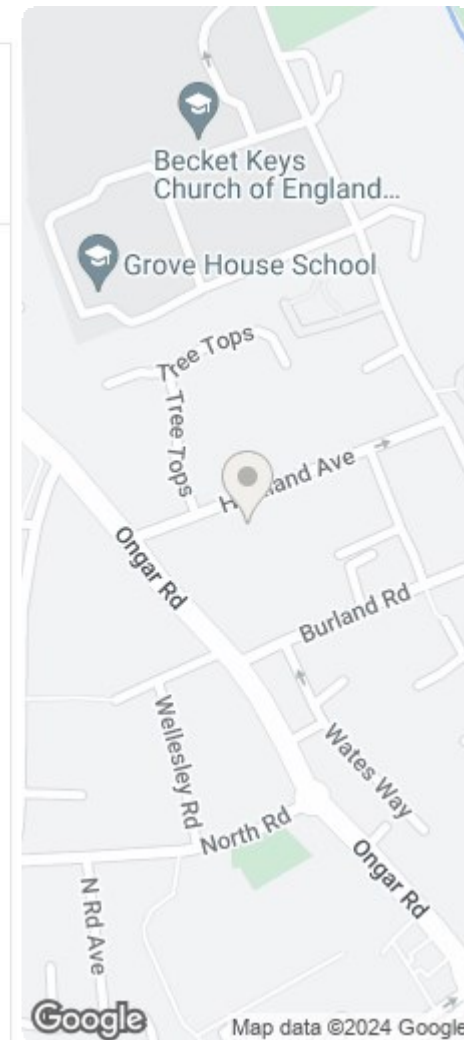

Energy Efficiency Rating	
Current	Potential
70	77

Environmental Impact (CO <sub>2</sub> ) Rating	
Current	Potential



