



**Meadowside Road, Upminster, RM14 3YT**  
**Price guide £600,000**

**Jenkins**  
Property

\*Guide Price £600,000-£625,000 \*Situating in a most desirable turning and enjoying a lovely long mature established garden this three bedroom 1930's family home offers scope for further improvement and extension (stpp). Popular school's and local shops are close by with Upminster town centre and station easily accessible.

- Presigious turning
- Favourabe Schools Nearby
- Three Bedrooms
- Laundry Room
- Ground Floor Shower Room
- First Floor Bathroom
- Lounge Diner
- Off Street Parking
- Garage Space At Rear
- Large Garden

#### Porch

Hallway 14'1" x 5'4" (4.29m" x 1.63m")

#### Living/Dining Room

Laundry Room 6'6" x 8'8" (1.98m" x 2.64m")

Ground Floor Shower Room 4'11 x 6'7" (1.50m x 2.01m")

Kitchen 6'11" x 8'4" (2.11m" x 2.54m")

#### Landing

Bedroom One 13'8" x 11'8" (4.17m" x 3.56m")

Bedroom Two 10'5" x 9'3" (3.18m" x 2.82m")

Bedroom Three 13'8" x 11'8" (4.17m" x 3.56m")

Bathroom 5'10"x 5'6" (1.78m"x 1.68m")

#### Exterior

#### Rear Garden

Side access leading to rear garage space.

#### Front Garden

Off street parking

Awaiting EPC



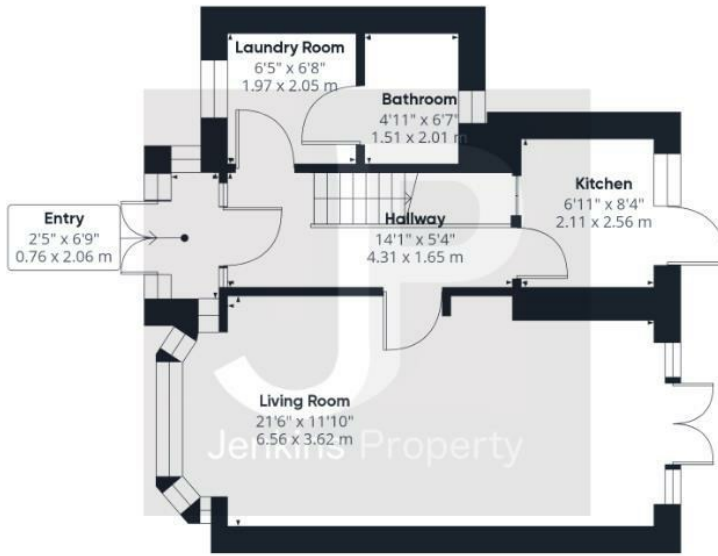

Ground Floor



Floor 1



Approximate total area<sup>1)</sup>

915.08 ft<sup>2</sup>

85.01 m<sup>2</sup>

Excluding balconies and terraces

While every attempt has been made to ensure accuracy, all measurements are approximate, not to scale. This floor plan is for illustrative purposes only.

GIRAFFE 360

