



5 Elwick Avenue

, Middlesbrough, TS5 8NR

£165,000



5 Elwick Avenue

, Middlesbrough, TS5 8NR

£165,000



ENTRANCE HALLWAY

13'5" x 6'3" (4.09m x 1.91m)

Step into the inviting entrance hallway, where the modern carpet cushions your feet and the gentle warmth of the central heating radiator envelops you. The staircase ascends gracefully to the first floor, while on the ground level, inviting doors lead to the spacious reception room and the well-equipped kitchen.

RECEPTION ROOM

24'8" x 11'2" (7.52m x 3.40m)

The reception room is bathed in natural light that streams in through the bow window to the front elevation and French doors to the rear. The easy-to-clean wood laminate floor adds to the room's welcoming ambiance. The room plays host to both a cosy living area and dining area perfect for formal dinners or casual family meals. An electric fireplace serves as the room's centerpiece, casting a warm, inviting glow and is accompanied by central heating radiators for further warmth.

KITCHEN

10'10" x 8'1" (3.30m x 2.46m)

Step into this sleek, modern kitchen. The base, wall, and drawer units provide ample storage for all your kitchen essentials. The marble-style worktop adds a touch of luxury and elegance, perfect for presenting a beautifully plated dish.

The integrated oven and extractor fan blend seamlessly into the design, while the large window overlooking the rear garden bathes the space in natural light, creating a warm and inviting atmosphere. Further enhancing the light are ceiling spotlights, which cast a warm, flattering glow.

LANDING

9'5" x 2'6" (2.87m x 0.76m)

Step onto the landing and be greeted by a bright, airy space that leads to the three well-appointed bedrooms. The window to the side elevation bathes the space in natural light, creating a welcoming atmosphere. From here, you also have easy access to the family bathroom and the loft space above.

BEDROOM ONE

13'3" x 7'4" (4.04m x 2.24m)

Imagine waking up to the soft morning light streaming in through the generously-sized uPVC double glazed window. The carpet underfoot and neutral decor create a serene and calming atmosphere. Picture your king-sized bed and matching dresser elegantly arranged in the spacious layout, with the cosy central heating radiator keeping you warm on chilly mornings. This front bedroom offers ample space for all your furniture and relaxation needs.

BEDROOM TWO

10'11" x 10'4" (3.33m x 3.15m)

Escape to this peaceful rear bedroom, where you can unwind and enjoy the soothing view of the garden through the large uPVC window. The neutral decor and carpet provide a calming backdrop, while the central heating radiator ensures a comfortable temperature. This room would be perfect for a tranquil bedroom set, including a plush double bed, nightstands, and a dresser.

BEDROOM THREE

9'3" x 7'4" (2.82m x 2.24m)

To the front of the home, this compact yet charming bedroom features a built-in wardrobe for ample

Tel: 01642 462153

storage. The large uPVC window lets in plenty of natural light and provides a pleasant view of the street. The central heating radiator keeps this room snug, while the carpet underfoot adds to the warm, inviting feel. This room would be ideal for a single bed, desk, and a small dresser, making it a great space for a child, guest room, or home office.

FAMILY BATHROOM

8'4" x 7'3" (2.54m x 2.21m)

The family bathroom features a four-piece suite and includes a spacious shower cubicle, bath with chrome faucets, a modern toilet and sink. The room is illuminated by soft ceiling spotlights that highlight the glistening chrome fixtures. A large frosted window allows for plenty of natural light, while a chrome ladder-style towel warmer keeps towels toasty warm. The walls, tiled in a classic neutral tone, are easy to clean and give the room a fresh, crisp feel

EXTERNAL

The front driveway provides ample parking, leading to the detached garage - a fantastic bonus for storing vehicles, tools, or extra belongings. The small front garden adds curb appeal and a touch of

greenery. Venture to the rear and discover a paved patio area, perfect for outdoor lounging and al fresco dining, surrounded by a lush, well-maintained lawn. This outdoor space is a true oasis, inviting you to relax and enjoy the fresh air.

Imagine the possibilities. This could be your home.

Contact us today to schedule a viewing and experience these wonderful spaces for yourself.



Road Map

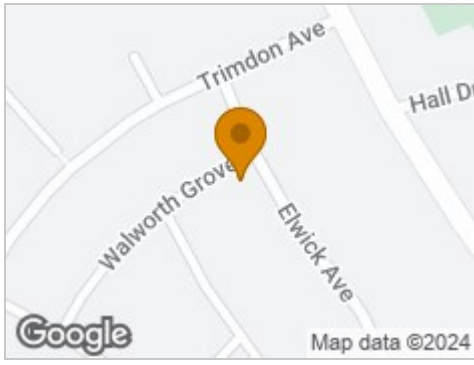

Hybrid Map



Terrain Map



Floor Plan

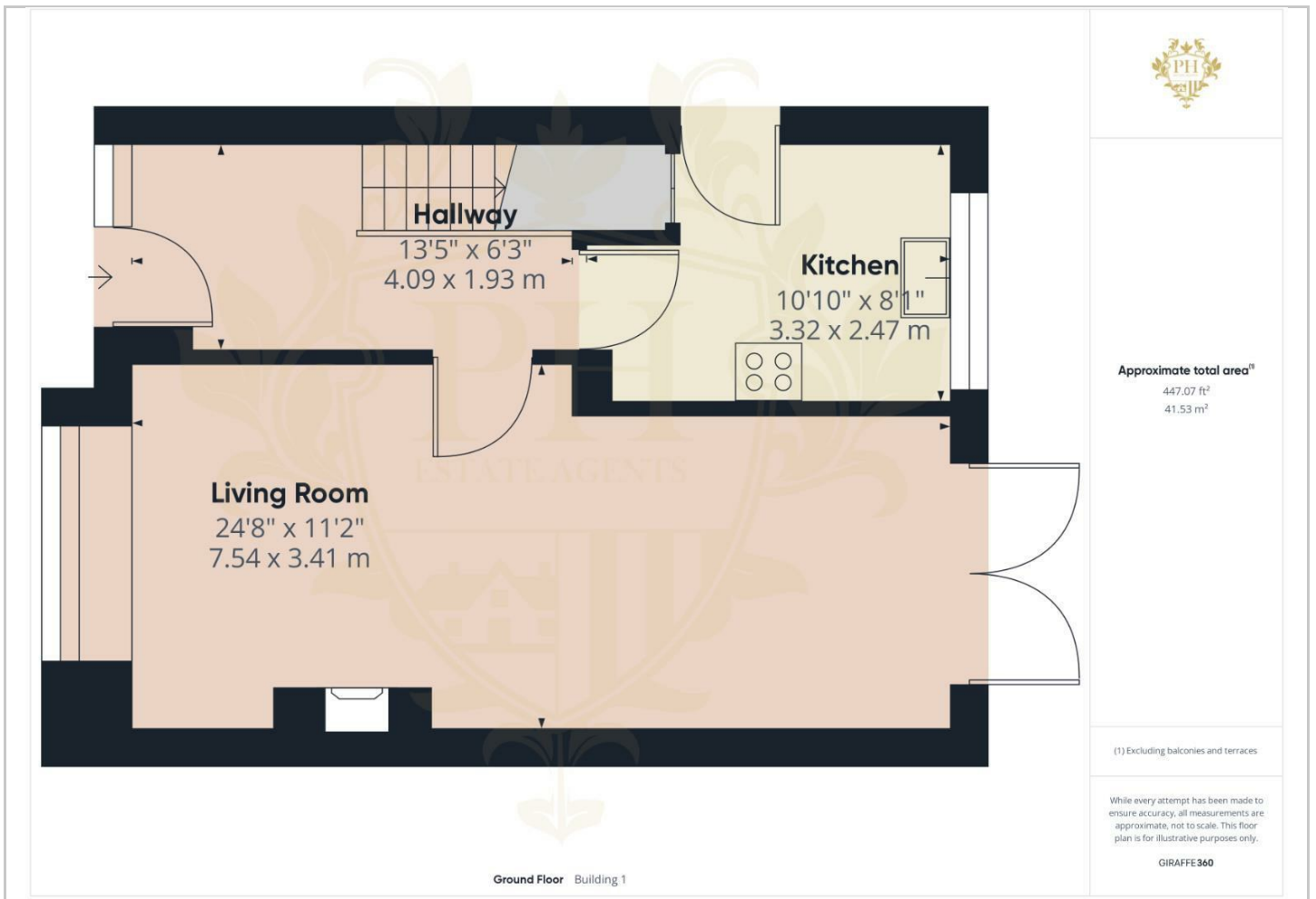

Viewing

Please contact our Middlesbrough Office on 01642 462153 if you wish to arrange a viewing appointment for this property or require further information.

Energy Efficiency Graph

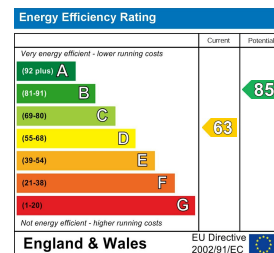

These particulars, whilst believed to be accurate are set out as a general outline only for guidance and do not constitute any part of an offer or contract. Intending purchasers should not rely on them as statements of representation of fact, but must satisfy themselves by inspection or otherwise as to their accuracy. No person in this firm's employment has the authority to make or give any representation or warranty in respect of the property.