



Wood Road, Halewood, Liverpool, L26 0UL

- Two Bedroom Semi Detached Property
- Offered For Sale With No Onward Chain
- Substantial Reception Room & Kitchen
- Sizable Three-Piece Family Bathroom
- Located In Favoured Area Of Halewood
- An Exciting Opportunity For Renovation
- Two Generously Proportioned Bedrooms
- Garden To Rear & Off-Road Parking



Offers Over £120,000









Description

Located on Wood Road in the popular residential area of Halewood, L26, is this promising two bedroom semi detached home, introduced to the sales market by appointed agents Move Residential. Boasting generous living proportions which are bursting with potential throughout, this presents an exciting renovation opportunity for those searching for a property they can put their own stamp on. The property comprises in brief of a spacious lounge and kitchen to the ground floor, with two generously sized bedrooms and a family bathroom suite to the first floor. To the front, a driveway provides ample off-road parking. Externally, the property further benefits from a sizable garden to the rear. A viewing is recommended to fully appreciate the scope that this property has to offer.

Location

Halewood is part of the Metropolitan Borough of Knowsley, to the south east of the City, close to Hunts Cross and Woolton. Its industrial heritage is still evident today in the form of the Jaguar Land Rover production facility and the Getrag gearbox factory. Halewood Railway Station and the nearby M57 and M62 motorways offer easy links into and out of the City, while Halewood Shopping Centre, Halewood Leisure Centre and the Green Flag accredited Halewood Park provide weekend amenities.

EPC Summary

Awaiting Image.

Additional Information

These particulars are thought to be materially correct though their accuracy is not guaranteed and they do not form part of any contract. All measurements are approximate and we have not tested any fitted appliances, electrical or plumbing installation or central heating systems. Floor plans are for illustration purposes only and their accuracy is not guaranteed.

Floor Plan

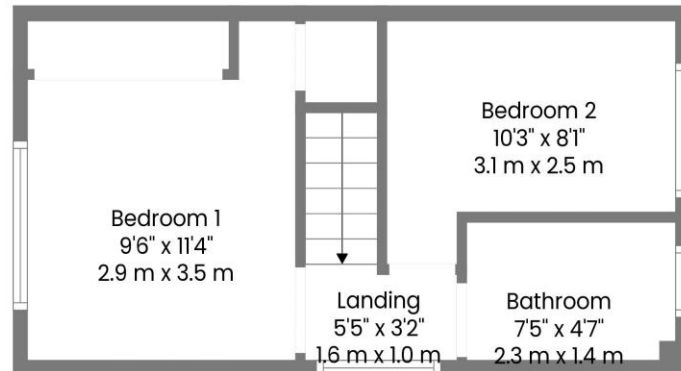

Floor 2

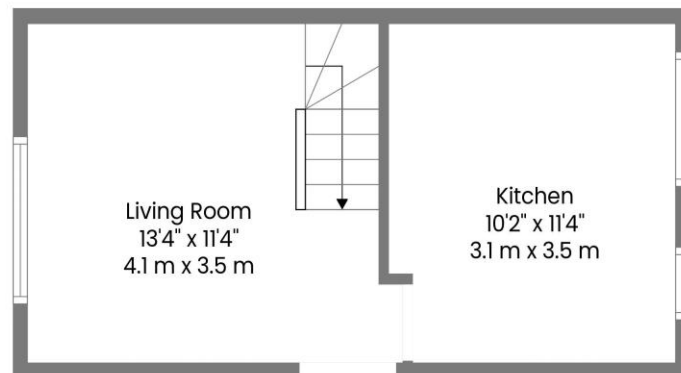

Floor 1