



Highfield Street, City Centre, Liverpool L3 6LH

- Two Bedroom Upper Floor Apartment
- Ideal For First Time Buyers & Investors
- Entrance Hall, Living Room & Kitchen
- Three-Piece Family Bathroom Suite
- Prime Location In Centre Of Liverpool
- Bright & Well-Maintained Throughout
- Two Substantial Double Bedrooms
- Allocated Gated Off-Road Parking



Offers in Excess of £120,000









Description

Move Residential are thrilled to present to the sales market this delightful two bedroom upper floor apartment located on Highfield Street, enjoying a prime location in Liverpool's vibrant city centre, L3. Boasting generous and well-maintained accommodation throughout, this presents an opportunity not to be missed for first time buyers or investors looking to expand their portfolio. Accessed via a secure communal entrance, the apartment itself consists in brief of an entrance hall, bright and spacious reception room and a fitted kitchen. The sleeping accommodation consists of two substantial and well-presented double bedrooms, accompanied by a three-piece family bathroom suite. The windows, hot water system and heaters have all been recently replaced within the past few years, and externally the property further benefits from gated allocated parking.

Location

Enjoying the L3 postcode, the property boasts easy access to the popular Liverpool 1 shopping centre, the world heritage site of The Albert Docks and further amenities brought to you by the city of Liverpool. Tourist attractions including the city's cathedrals are close by, as are supermarkets, churches and schools and restaurants, bars, cafes and cinemas are all a stroll away. Just five minutes to both the Birkenhead and Wallasey tunnels, a short drive to the M62, M57 and M58 motorways and a handful of train links close by, the property sits in an ideal location for any commuter or city worker.

EPC Summary

Score	Energy rating	Current	Potential
92+	A		
81-91	B		
69-80	C	70 C	80 C
55-68	D		
39-54	E		
21-38	F		
1-20	G		

Additional Information

These particulars are thought to be materially correct though their accuracy is not guaranteed and they do not form part of any contract. All measurements are approximate and we have not tested any fitted appliances, electrical or plumbing installation or central heating systems. Floor plans are for illustration purposes only and their accuracy is not guaranteed.

Floor Plan

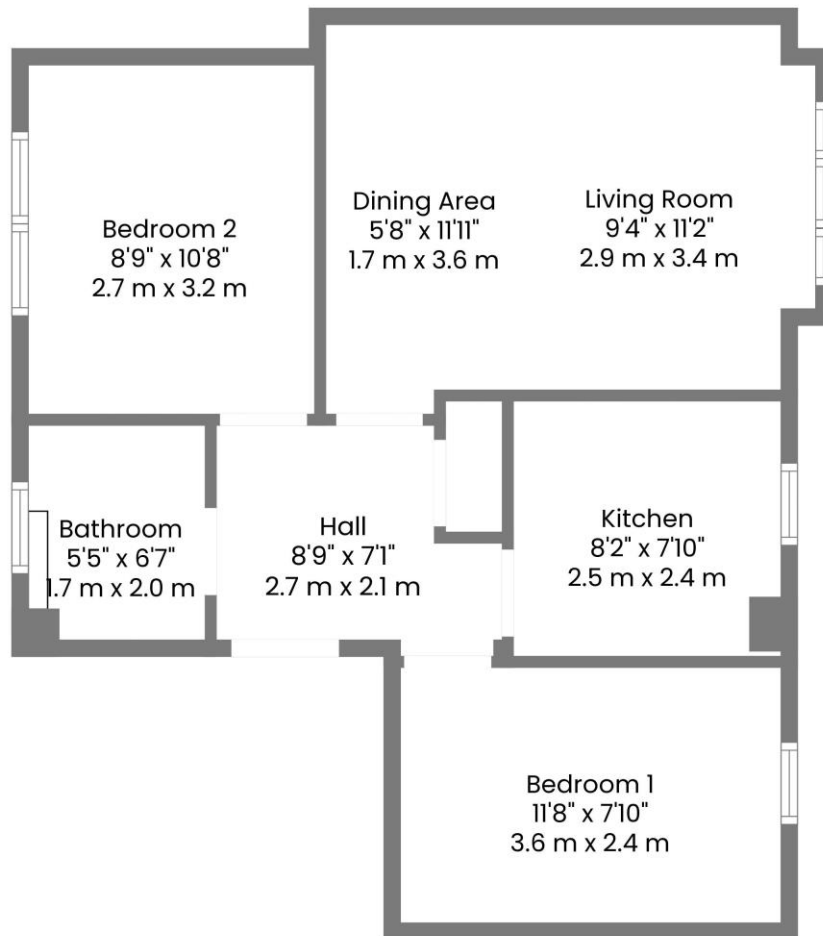

TOTAL: 534 sq. ft, 50 m²
FLOOR 1: 534 sq. ft, 50 m²
WALLS: 50 sq. ft, 4 m²