



Belvedere House, Princes Park, Liverpool, L8 3SR

- Lovely Two Bedroom First Floor Apartment
- Spacious & Beautifully Presented Throughout
- Entrance Hall & Welcoming Reception Room
- Ensuite To Master & Modern Main Bathroom
- Located In The Leafy Suburb Of Princes Park
- Well-Maintained Communal Entrance & Lift
- Two Bright & Substantial Double Bedrooms
- Benefits From Allocated Off-Road Parking



Offers Over £200,000







Description

Move Residential are thrilled to present to the market this delightful two bedroom first floor apartment, located in a desirable development in the leafy suburb of Princes Park, L8. Boasting spacious and beautifully presented accommodation throughout, this promises to make a wonderful future home for first time buyers looking to get on the property ladder, or those wanting to downsize. Accessed via a gated entrance and lift up to the first floor, you are welcomed into the apartment itself by an inviting entrance hall which leads through to a generous reception room. Bathed in natural light and finished in a neutral décor featuring attractive wood style flooring, this presents a welcoming space to relax and entertain guests. Continuing through you will find a modern kitchen complete with a range of fitted base and wall units and plentiful surface space. The sleeping accommodation consists of two substantial double bedrooms, the master enjoying the added luxury of deluxe ensuite facilities, and adding the finishing touch to the interior of this charming apartment is a contemporary style family bathroom suite. Further benefits include allocated off-road parking.

Location

Princes Park is a lush and vibrant suburb located in the L8 area of Liverpool. It is one of the most popular neighbourhoods in the city, offering a tranquil and picturesque setting whilst still being conveniently close to the city centre. The area is characterized by its tree-lined streets, Victorian homes, and excellent community amenities. The area is home to some of Liverpool's most beautiful parks, with its eponymous park being a particular highlight. Princes Park features picturesque lakes, ornate gardens, and a popular running track, making it an excellent place for outdoor activities or relaxing strolls. There are also numerous trendy cafes, restaurants, and bars in the vicinity, offering a diverse choice of cuisine and social activities. Local amenities include supermarkets, good schools, a large hospital and good transport links, including buses and trains to the city centre.

Floor Plan

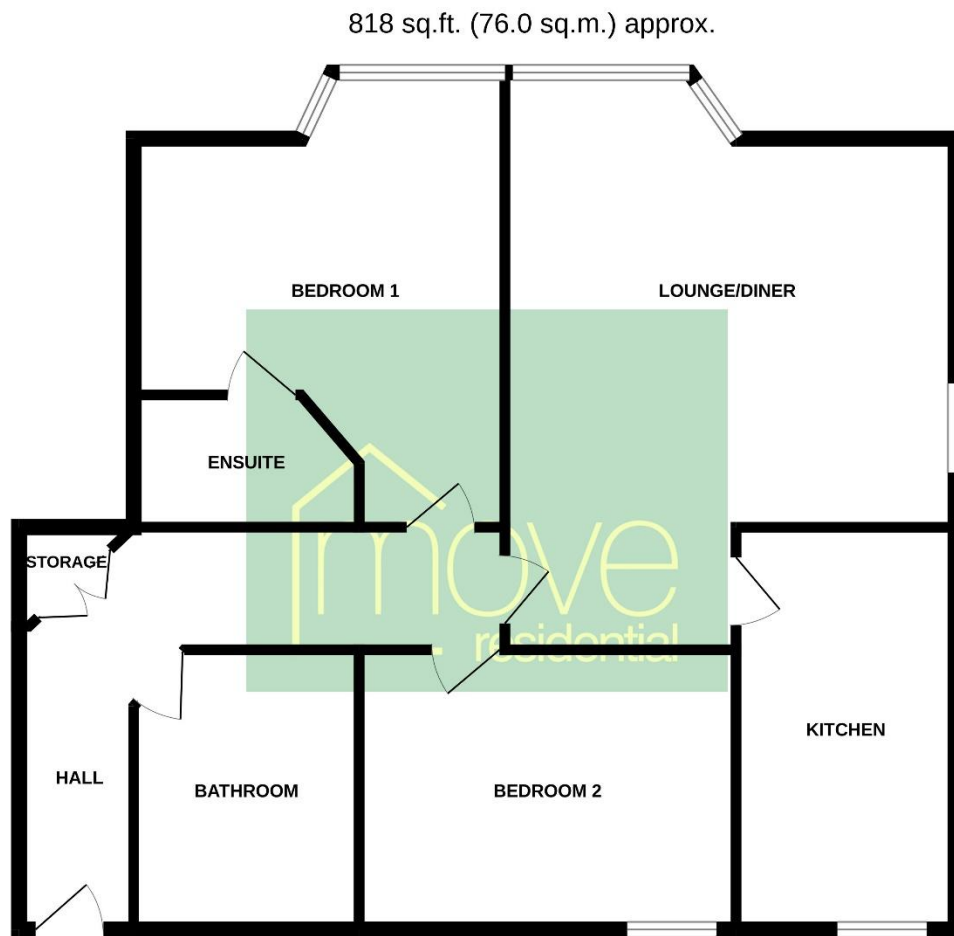

TOTAL FLOOR AREA : 818sq.ft. (76.0 sq.m.) approx.

Whilst every attempt has been made to ensure the accuracy of the floorplan contained here, measurements of doors, windows, rooms and any other items are approximate and no responsibility is taken for any error, omission or mis-statement. This plan is for illustrative purposes only and should be used as such by any prospective purchaser. The services, systems and appliances shown have not been tested and no guarantee as to their operability or efficiency can be given.
Made with Metropix ©2025

EPC Summary

Score	Energy rating	Current	Potential
92+	A		
81-91	B	82 B	82 B
69-80	C		
55-68	D		
39-54	E		
21-38	F		
1-20	G		

Additional Information

These particulars are thought to be materially correct though their accuracy is not guaranteed and they do not form part of any contract. All measurements are approximate and we have not tested any fitted appliances, electrical or plumbing installation or central heating systems. Floor plans are for illustration purposes only and their accuracy is not guaranteed.