



Waverley Drive, Prescot, Liverpool, L34 1PU

- Modern Four Bedroom Detached Property
- Well-Proportioned & Beautifully Presented
- Extended Open Plan Kitchen Diner & WC
- Ensuite to Master & Main Bathroom Suite
- Located in Highly Favoured Area of Prescot
- Entrance Hall & Spacious Through Lounge
- Three Double Bedrooms & Single Room
- Rear Garden, Off-Road Parking & Garage



£399,950



















Description

Move Residential are thrilled to present to the sales market this fabulous four bedroom detached home, enjoying a peaceful cul-de-sac location on Waverley Drive in a highly favoured residential area of Prescott, L34. Boasting a substantial extension, this modern property offers generous and beautifully presented accommodation throughout, promising to make a fantastic future home for growing families. Following through the inviting entrance hall, you are led into bright and spacious family lounge. Featuring plush carpeting and an eye-catching feature fireplace, this presents a welcoming space to relax and unwind, and flows seamlessly into a tastefully decorated dining which provides a charming setting for enjoying family mealtimes. At the heart of the home is a spectacular extended open plan kitchen diner which has evidently been designed to the very highest specifications, providing the ultimate entertaining space. The kitchen is complete with a range of sleek fitted base and wall units, complementary worktops providing plentiful surface space, and a selection of integrated appliances. The centre island boasts an integrated wine cooler and incorporates a breakfast bar, offering the ideal spot for more casual dining, and there is ample room to accommodate a dining table or sitting area. Two sets of bifold doors provide views and access out to the rear garden and, along with three velux windows above, illuminate the space in daylight. Concluding the ground floor is a convenient WC. Continuing up to the first floor you will find three generously sized double bedrooms and a well-proportioned single room, each finished to an excellent standard and receiving plenty of natural light. The master bedroom enjoys the added luxury of a modern ensuite shower room, and adding the finishing touch to this lovely home is a deluxe three-piece family bathroom suite. Externally the property further benefits from a delightful rear garden which backs onto woodland, enjoying privacy and seclusion. A neatly maintained lawn offers plenty of room for recreational activities whilst a smartly flagged patio area provides a serene spot for al-fresco dining. To the front, a double driveway accommodates off-road parking, whilst an integral garage offers additional storage space.

Location

Prescot is a town and civil parish, within the Metropolitan Borough of Knowsley in Merseyside, England. Historically part of Lancashire, it lies approximately eight miles to the east of Liverpool city centre. Easy access to the city centre includes the train station and motorways. Local amenities include shops, supermarkets and bus routes.

Floor Plan

GROUND FLOOR
755 sq.ft. (70.2 sq.m.) approx.

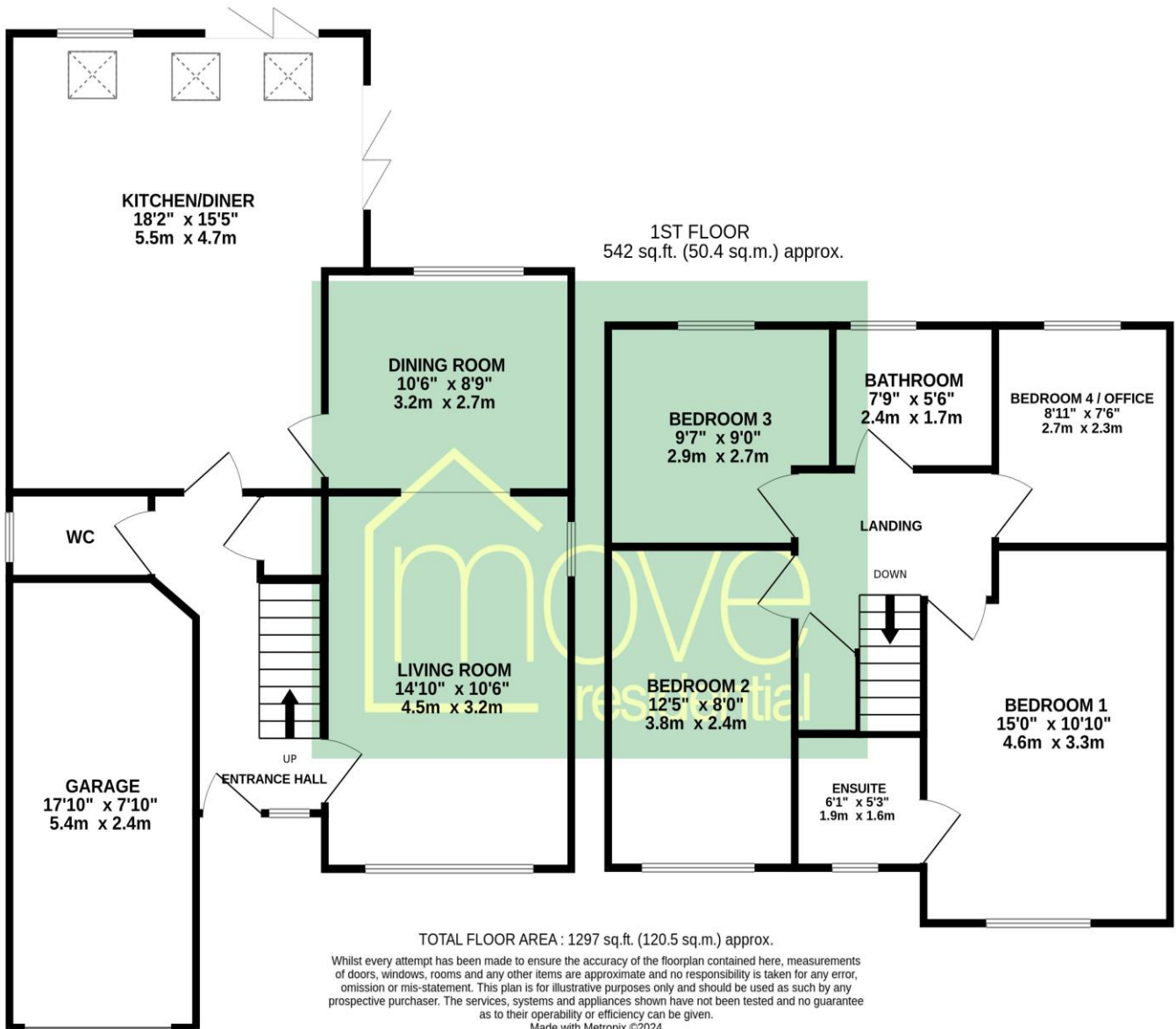

EPC Summary

Score	Energy rating	Current	Potential
92+	A		
81-91	B		83 B
69-80	C		
55-68	D	67 D	
39-54	E		
21-38	F		
1-20	G		

Additional Information

These particulars are thought to be materially correct though their accuracy is not guaranteed and they do not form part of any contract. All measurements are approximate and we have not tested any fitted appliances, electrical or plumbing installation or central heating systems. Floor plans are for illustration purposes only and their accuracy is not guaranteed.