



Commutation plaza, City Centre, Liverpool, L3 8HR

- Fantastic Two Bedroom Duplex Apartment
- Two Double Bedrooms with Mezzanine Level
- Bright & Spacious Living Space
- Allocated Off Road Parking
- Ideal City Centre Location - Close to Amenities
- Substantial Modern Fitted Kitchen
- En Suite to Master & Bathroom Suite
- Picturesque Views & Private Balcony Area



£169,950









Description

Move Residential is delighted to present this exquisite duplex apartment located on Commutation Plaza, L3. This stunning property boasts a well-thought-out layout, which includes a communal entrance hallway, vestibule, entrance hallway, lounge, kitchen, bedroom, and bathroom on the main level. Additionally, the mezzanine level offers another bedroom and an en-suite shower room, providing ample living space. For your convenience, there is allocated parking available, and the property is equipped with an efficient electric heating system.

Location

Commutation Plaza is situated within Commutation Row, which is in Liverpool City Centre, L3. The property is located within close proximity to London Road and Norton Street, local amenities include shopping facilities, universities and museums. The property gives easy access to public transport links including Lime Street Station and easy access to all major road networks.

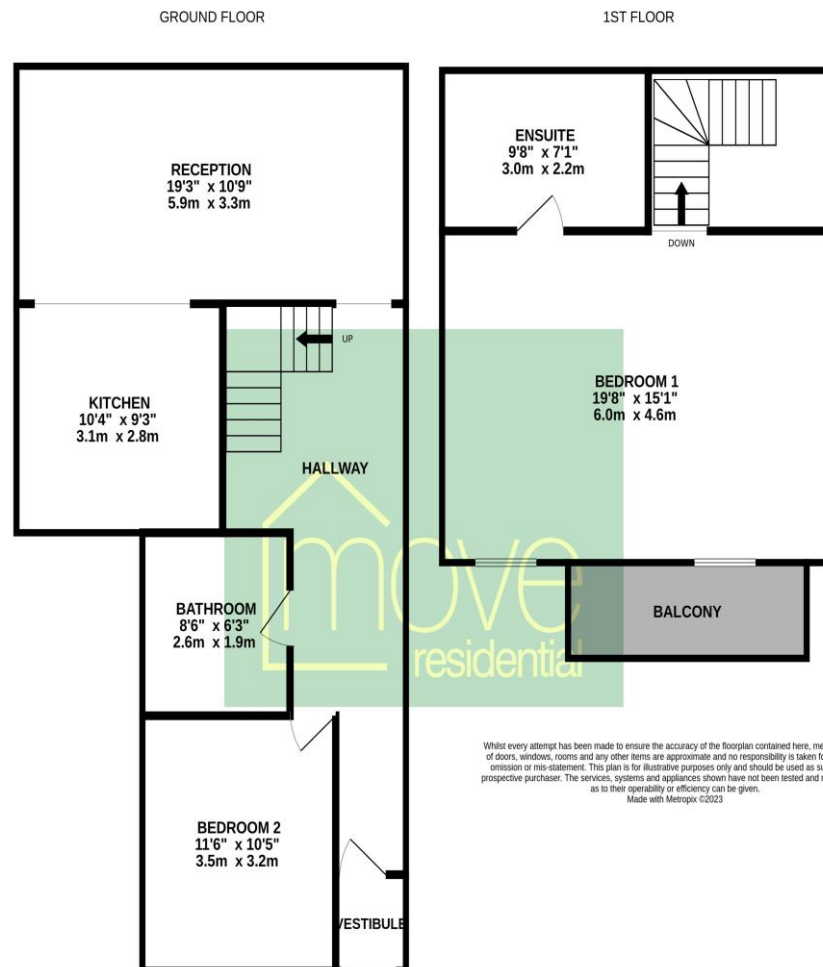

Whilst every attempt has been made to ensure the accuracy of the floorplan contained here, measurements of doors, windows, rooms and any other items are approximate and no responsibility is taken for any error, omission or mis-statement. This plan is for illustrative purposes only and should be used as such by any prospective purchaser. The services, systems and appliances shown have not been tested and no guarantee as to their operability or efficiency can be given.
Made with Metropix ©2023

Additional Information

These particulars are thought to be materially correct though their accuracy is not guaranteed and they do not form part of any contract. All measurements are approximate and we have not tested any fitted appliances, electrical or plumbing installation or central heating systems. Floor plans are for illustration purposes only and their accuracy is not guaranteed.