



## Ullet Road, Aigburth, Liverpool, L17 2AB

- One Bedroom Ground Floor Apartment
- Easy Access To Local Amenities
- Double Bedroom
- Three Piece Family Bathroom
- Sought After Area
- Spacious Living/Dining Room
- Separate Kitchen
- Secure Communal Entrance



Offers Over £105,000









## **Description**

Move Residential presents this charming ground floor apartment with one bedroom, located on Ullet Road in the highly desirable residential area of Aigburth, L17. Accessible through a secure communal entrance, the apartment offers a generously sized living/dining room, a comfortable double bedroom, a separate kitchen, and a modern three-piece bathroom. Its prime location grants convenient access to an array of amenities, including trendy local bars, shops, and restaurants.

## **Location**

Ullet Road is situated within the popular residential area of Aigburth, L17. The property's location gives easy access to all local amenities including local shops, restaurants and bars at nearby Lark Lane and Aigburth Road and the popular Sefton Park. A genuinely varied area of Liverpool with plenty of local character, popular with students, investors, professionals and families, property largely consists of traditional terraced housing appealing to both the buying and rental market. At the heart of the area is Sefton Park, Grade II listed and covering a massive 235 acres it has something for everyone including the spectacular Victorian Palm House. Further open space can be found nearby at the Green Flag rated Greenbank Park. Connecting Aigburth Road to Sefton Park, Lark Lane attracts students, young professionals and families alike to its bohemian mix of shops, restaurants, bars, regular Farmer's Market and unique atmosphere. Further shopping is also available on Aigburth Road and there is no shortage of sport and leisure facilities, including Greenbank Sports Academy, Sefton Park and Liverpool Cricket Clubs, the Mersey Bowman Lawn Tennis Club and several Yoga and Martial Arts centres. Schools in the area are well regarded, including private schools, The Belvedere Academy and Auckland College and St Margarets and St Hildas C of E High Schools. Travel connections include Aigburth and St Michael's train stations, main bus routes along Aigburth Road and easy routes to John Lennon Airport and the M62.

## Floor Plan

GROUND FLOOR  
555 sq.ft. (51.6 sq.m.) approx.

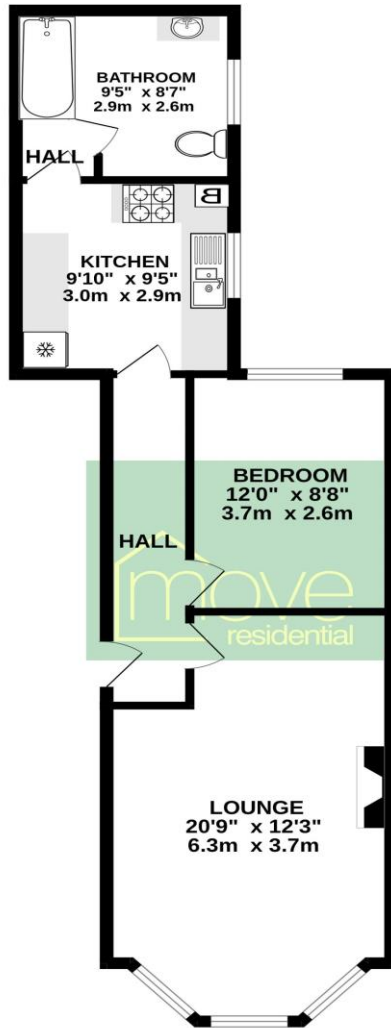

FLAT 1, 109 ULLET ROAD, LIVERPOOL. L17 2AB

TOTAL FLOOR AREA: 555 sq.ft. (51.6 sq.m.) approx.

Whilst every attempt has been made to ensure the accuracy of the floorplan contained here, measurements of doors, windows, rooms and any other items are approximate and no responsibility is taken for any error, omission or mis-statement. This plan is for illustrative purposes only and should be used as such by any prospective purchaser. The services, systems and appliances shown have not been tested and no guarantee as to their operability or efficiency can be given.  
Made with Metropix ©2023

## Additional Information

These particulars are thought to be materially correct though their accuracy is not guaranteed and they do not form part of any contract. All measurements are approximate and we have not tested any fitted appliances, electrical or plumbing installation or central heating systems. Floor plans are for illustration purposes only and their accuracy is not guaranteed.