

Astley & co



4a Reepham Road
Hellesdon
Norwich

Price: £275,000

Information

Great location near to the city centre for this semi-detached house with three bedrooms set in a good sized plot with versatile *outbuilding. The lounge has been knocked into dining room creating a lovely a large family space. The sun room is a contemporary lean-to style room with a warm roof and is usable all year round. Newly installed doors and windows. The plot is 150ft long with an enclosed and low maintenance garden. The outbuilding can be used for working from home office, studio, workshop or home gym, or as another reception room. The location is easy access to all essential amenities and easy transport routes including the bus service and walking distance to the centre of Norwich. Offered with no onward chain. *potentially separate negotiation.

Gas fired central heating. Energy Performance Rating C.

4a Reepham Road, Hellesdon

Norwich

Price £275,000

Astley & Co
ESTATE AGENTS

Description

Entrance Hall 15' 6" x 6' 6" (4.73m x 1.98m)

Lounge/Diner 23' 8" x 11' 11" (7.21m x 3.63m)

Kitchen 11' 2" x 7' 9" (3.40m x 2.36m)

Sun room 11' 10" x 9' 8" (3.60m x 2.94m)

First Floor Landing

Bedroom 1 12' 0" x 11' 4" (3.65m x 3.45m)

Bedroom 2 11' 7" x 10' 10" (3.53m x 3.30m)

Bedroom 3 7' 11" x 7' 9" (2.41m x 2.36m)

First Floor Landing 8' 5" x 7' 9" (2.56m x 2.36m)

Family Bathroom 5' 8" x 5' 8" (1.72m x 1.72m)

Garden

Garden Room

Summary of accommodation

- Semi Detached House
- Three Bedrooms
- Open Lounge and Diner
- Separate Sun Lounge
- Garden Room (Separate Negotiation)
- No Chain

Score	Energy rating	Current	Potential
92+	A		
81-91	B		86 B
69-80	C	69 C	
55-68	D		
39-54	E		
21-38	F		
1-20	G		

Astley & Co Estate Agents

Email: yvonne@astleyandco.com

Website: www.astleyandco.com

Tel: 01603 415182

Fax:

GROUND FLOOR
612 sq.ft. (56.9 sq.m.) approx.

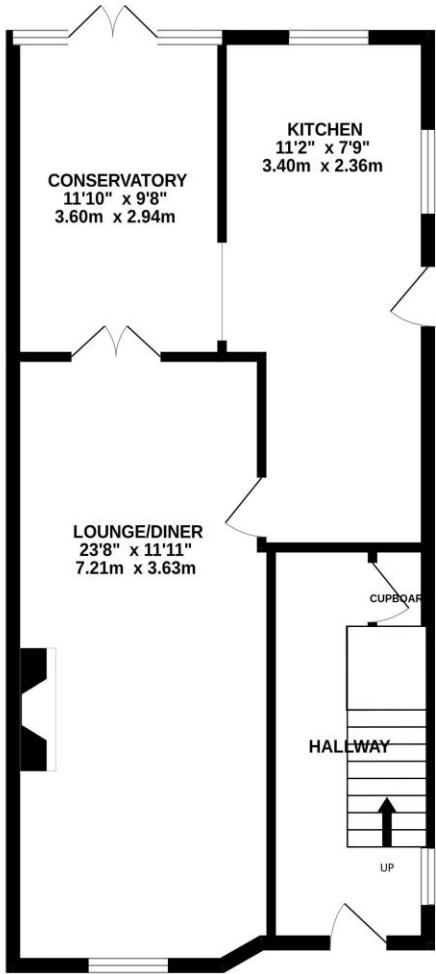

1ST FLOOR
395 sq.ft. (36.7 sq.m.) approx.

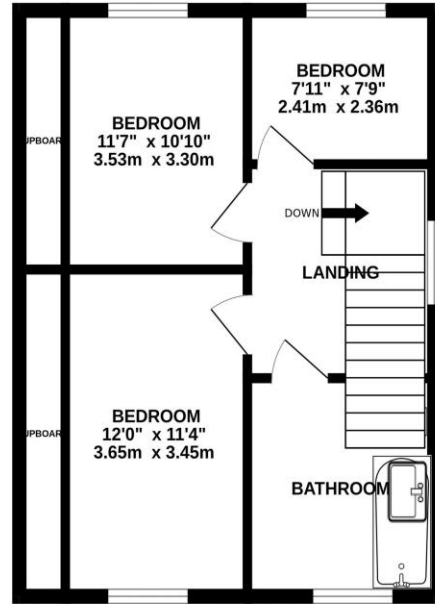

TOTAL FLOOR AREA: 1008 sq.ft. (93.6 sq.m.) approx.

Whilst every attempt has been made to ensure the accuracy of the floorplan contained here, measurements of doors, windows, rooms and any other items are approximate and no responsibility is taken for any error, omission or mis-statement. This plan is for illustrative purposes only and should be used as such by any prospective purchaser. The services, systems and appliances shown have not been tested and no guarantee as to their operability or efficiency can be given.
Made with Metropix ©2024

