



Stoneacre
Properties



Field End Gardens, Leeds, LS15 0QH
£260,000

Offered for sale is this charming semi detached bungalow. The property is located in a sought after location close to all local amenities including schools, shops and transport links. The property comprises of: porch, kitchen, lounge, two bedrooms and shower room. Externally the property benefits from a large driveway and a detached brick built garage fitted with power and lights. Don't miss the opportunity to make this bungalow your new home call us on 0113 260 9111 to arrange a viewing.

Porch



Door to the side elevation. Double glazed windows.

LOUNGE



Double glazed window to the front elevation. Central heating radiator.

KITCHEN



Range of wall and base units. Integrated electric cooker with gas hob and extractor fan above. Sink and drainer. Space for fridge/freezer. Plumbing for washing machine. Double glazed window to the front elevation. Central heating radiator.

BEDROOM ONE



Double glazed window to the rear, Central heating radiator. Fitted wardrobes.

BEDROOM TWO



Double glazed window to the rear elevation. Central heating radiator.

SHOWER ROOM



Double glazed window to the side. Shower cubicle. Low flush w.c. Wash hand basin. Heated towel rail.

EXTERNAL



To the front is a lawned garden and driveway. To the rear is a garden that is mainly laid to lawn and a brick built garage.

GARAGE



Power and lights.

Floor Plan

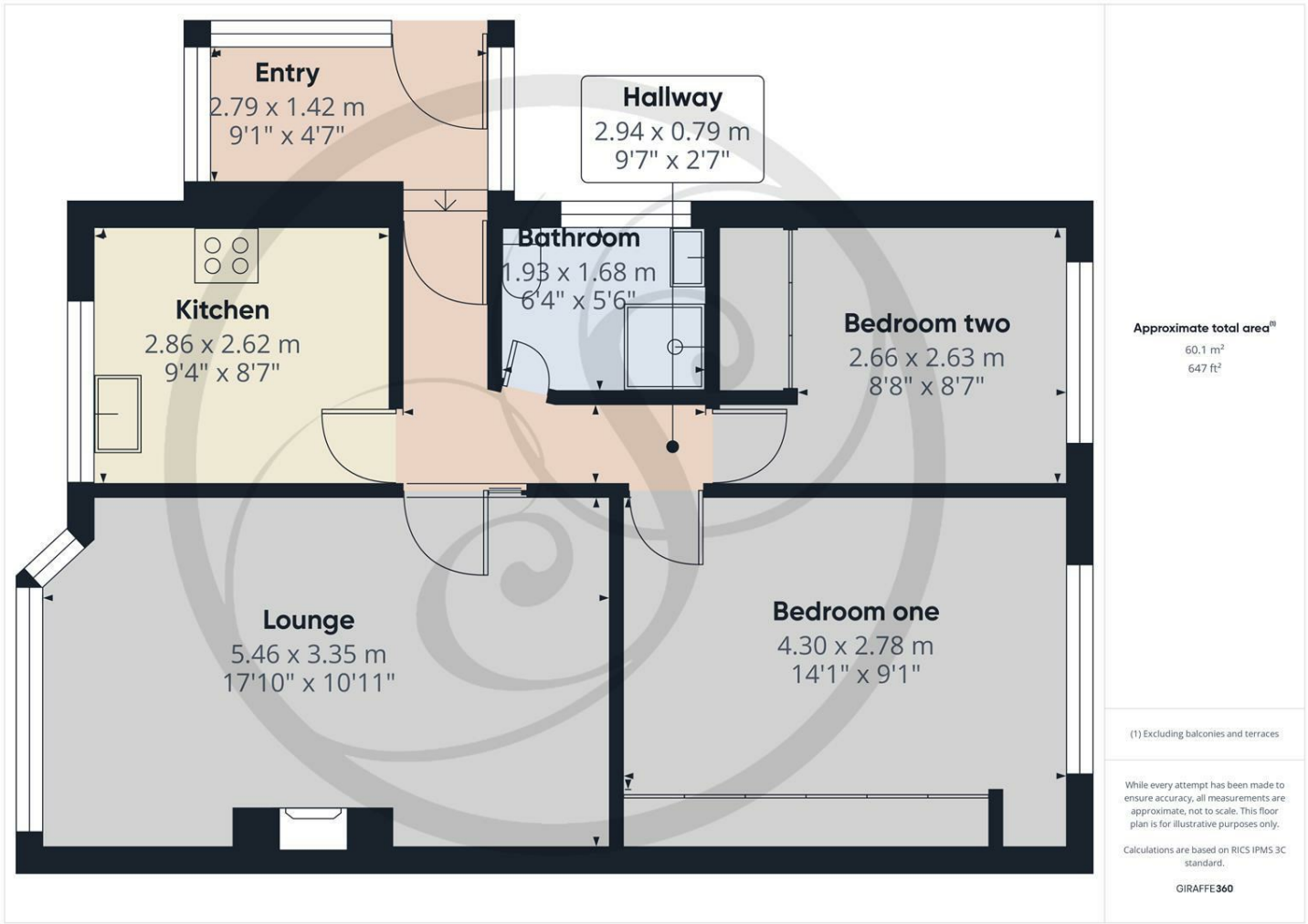

Area Map

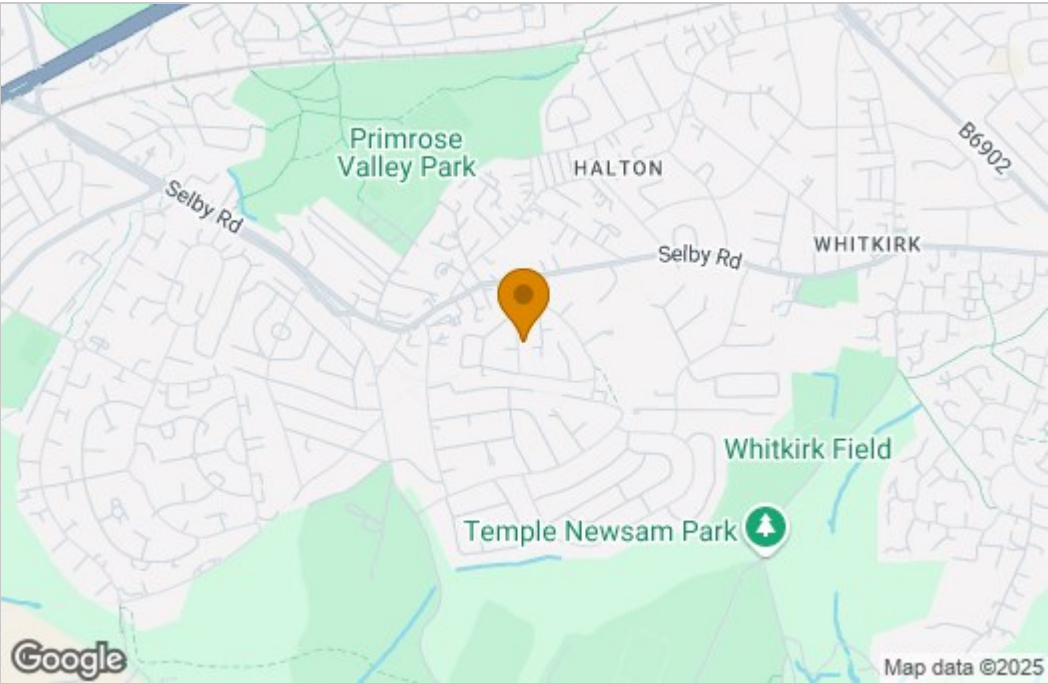

Energy Efficiency Graph

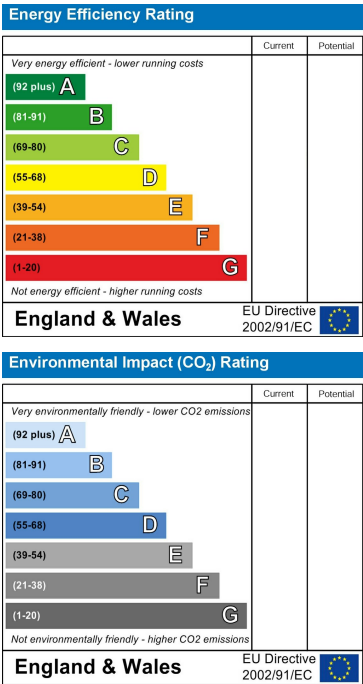

These particulars, whilst believed to be accurate are set out as a general outline only for guidance and do not constitute any part of an offer or contract. Intending purchasers should not rely on them as statements of representation of fact, but must satisfy themselves by inspection or otherwise as to their accuracy. No person in this firm's employment has the authority to make or give any representation or warranty in respect of the property.

