



Stoneacre
Properties



Ryedale Court, Leeds, LS14 6RQ

£95,000

Offered for sale is this upper floor flat that would be an ideal purchase for a first time buyer or investor. The property is in a popular area and has good access to local amenities such as shops and transport links. Comprising: entrance, lounge, kitchen, bedroom and bathroom. Viewings are highly recommended.

Entrance

Central heating radiator.

Lounge



Central heating radiator. Window to front.

Kitchen



Fitted with a range of wall and base units with work surfaces over incorporating a sink and drainer unit. Electric oven and hob with cooker hood over. Plumbing for washing machine. Space for fridge/freezer. Central heating radiator. Window to front. Additional storage cupboard.

Bedroom



Central heating radiator. Window to rear.

Bathroom



Fitted with a bath with shower over, wash hand basin and wc.

External



Communal parking.

Floor Plan

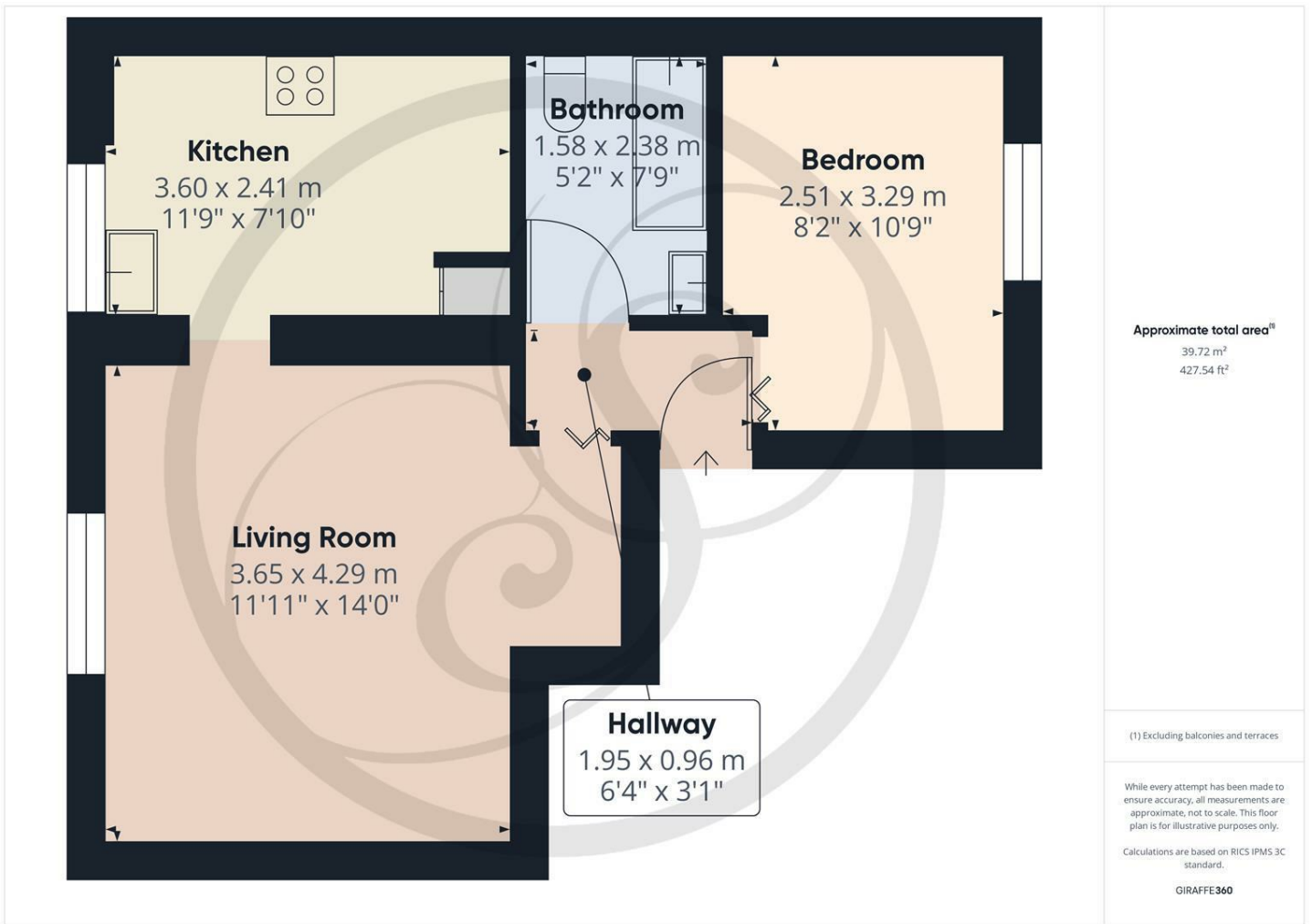

Area Map

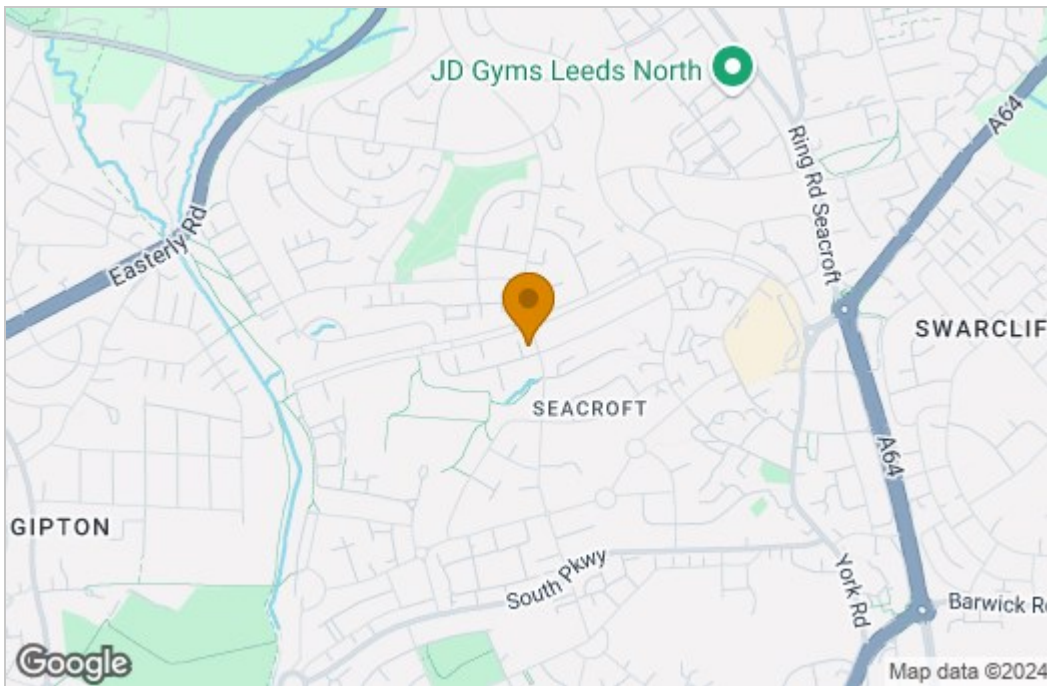

Energy Efficiency Graph

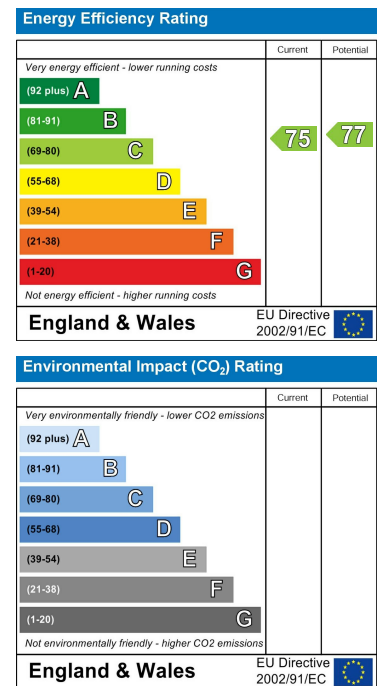

These particulars, whilst believed to be accurate are set out as a general outline only for guidance and do not constitute any part of an offer or contract. Intending purchasers should not rely on them as statements of representation of fact, but must satisfy themselves by inspection or otherwise as to their accuracy. No person in this firm's employment has the authority to make or give any representation or warranty in respect of the property.

