



Stoneacre
Properties



Lulworth Avenue, Leeds, LS15 8LW

£220,000

Stoneacre Properties are proud to present for sale this beautifully presented two bedroom semi detached bungalow, located in a sought after location near Crossgates. Close to local amenities, schools and transport links such as Crossgates train station. The property comprises of a kitchen, lounge, two bedrooms and a bathroom. Externally the property boasts gardens to the front and back. Driveway and garage to the side.

KITCHEN

Fitted with a range of wall and base units, with integrated double oven, gas stove and cooker hood above. Plumbing for a washing machine. Space for fridge freezer. Double glazed windows to the rear. Door to side.

LOUNGE

Feature fire place. Central heating radiator. Double glazed windows and door to the rear.

INNER HALLWAY

Loft access.

BEDROOM ONE

Double glazed bay window to the front. Central heating radiator.

BEDROOM TWO

Double glazed window to the front. Central heating radiator.

BATHROOM

Fitted with a bath, wc, wash hand basin and shower cubicle. Central heating radiator. Frosted window to the side.

EXTERNAL

To the front of the property is an easy maintenance garden, gated driveway leading down the side to the garage at the rear. To the rear is a raised deck area and a lawn.

GARAGE

Up and over door. Power.

Floor Plan

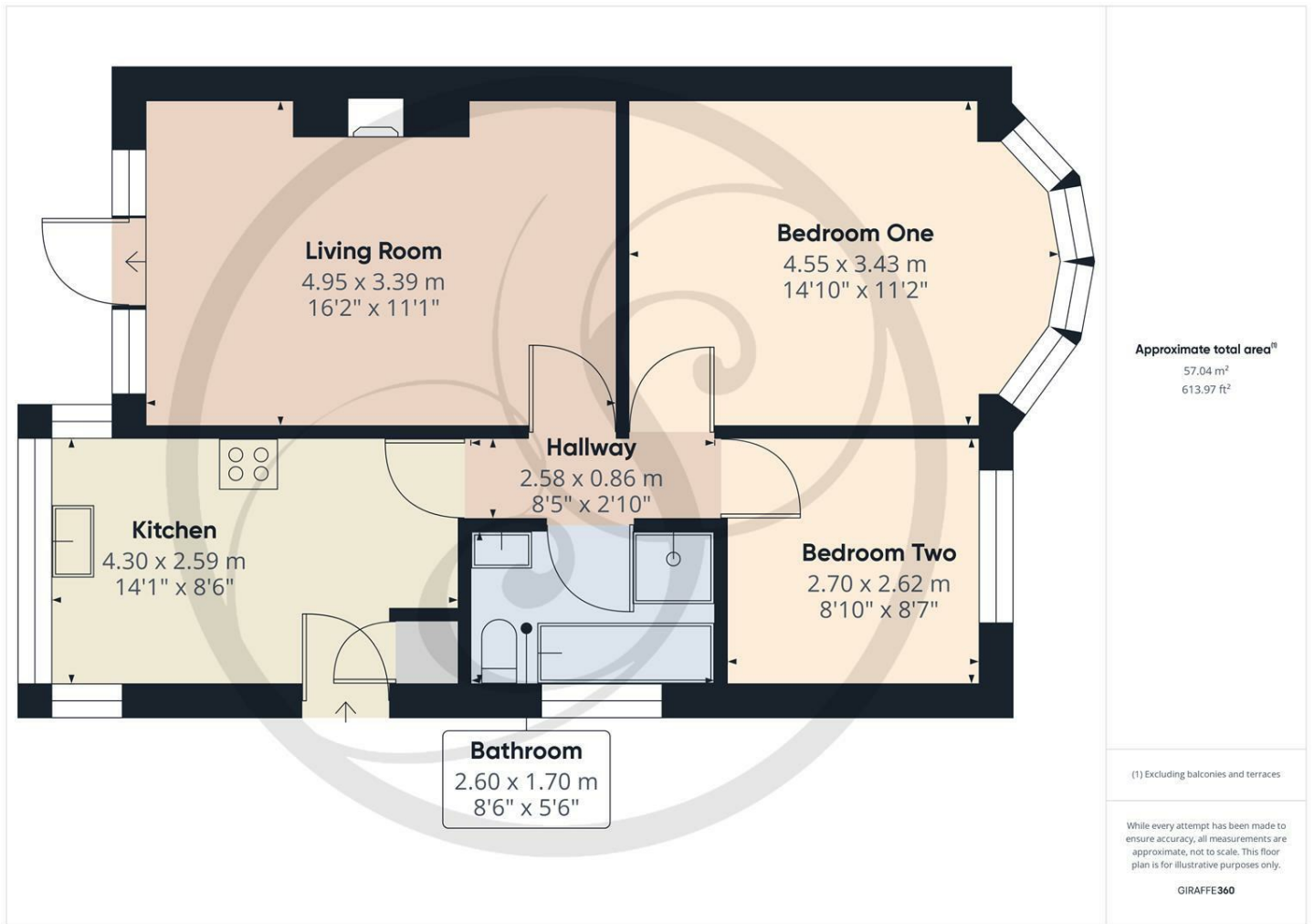

Area Map

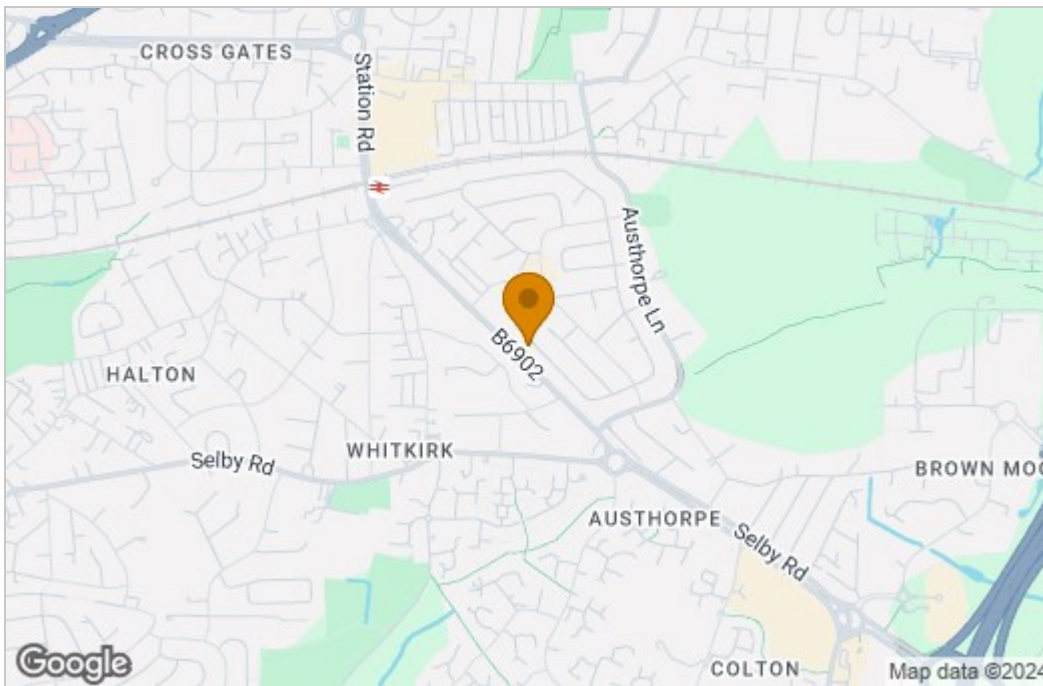

Energy Efficiency Graph

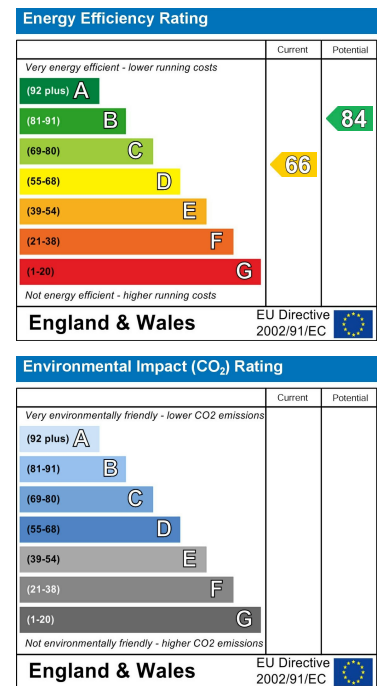

These particulars, whilst believed to be accurate are set out as a general outline only for guidance and do not constitute any part of an offer or contract. Intending purchasers should not rely on them as statements of representation of fact, but must satisfy themselves by inspection or otherwise as to their accuracy. No person in this firm's employment has the authority to make or give any representation or warranty in respect of the property.

