



Stoneacre
Properties



Pearsons Way, Leeds, LS14 6GB

£135,000

Stoneacre Properties are delighted to be able to offer for sale this ideal investment opportunity with a tenant in situ. This modern apartment with an allocated parking space is located moments away from all local amenities and fantastic transport links into the city and beyond. The property briefly comprises; Communal entrance & entrance hallway into the flat. Open plan kitchen/lounge area, two bedrooms and a bathroom. Allocated parking and visitor parking available as well. Early viewings are advised to avoid disappointment. Early viewings recommended.

ENTRANCE HALL

Two built in storage cupboards.

OPEN PLAN LIVING/KITCHEN



Large open plan living/kitchen area. The kitchen is fitted with a range of floor and wall units, integrated electric oven. Plumbing for a washing machine. Double glazed window to the front. Juliet balcony to front. Central heating radiator.

BEDROOM ONE



Double glazed window. Central heating radiator.

BEDROOM TWO



Double glazed window. Central heating radiator

BATHROOM



Fitted with a bath with shower over, wc, wash hand basin and central heating radiator.

EXTERNAL



Allocated parking space.

Floor Plan

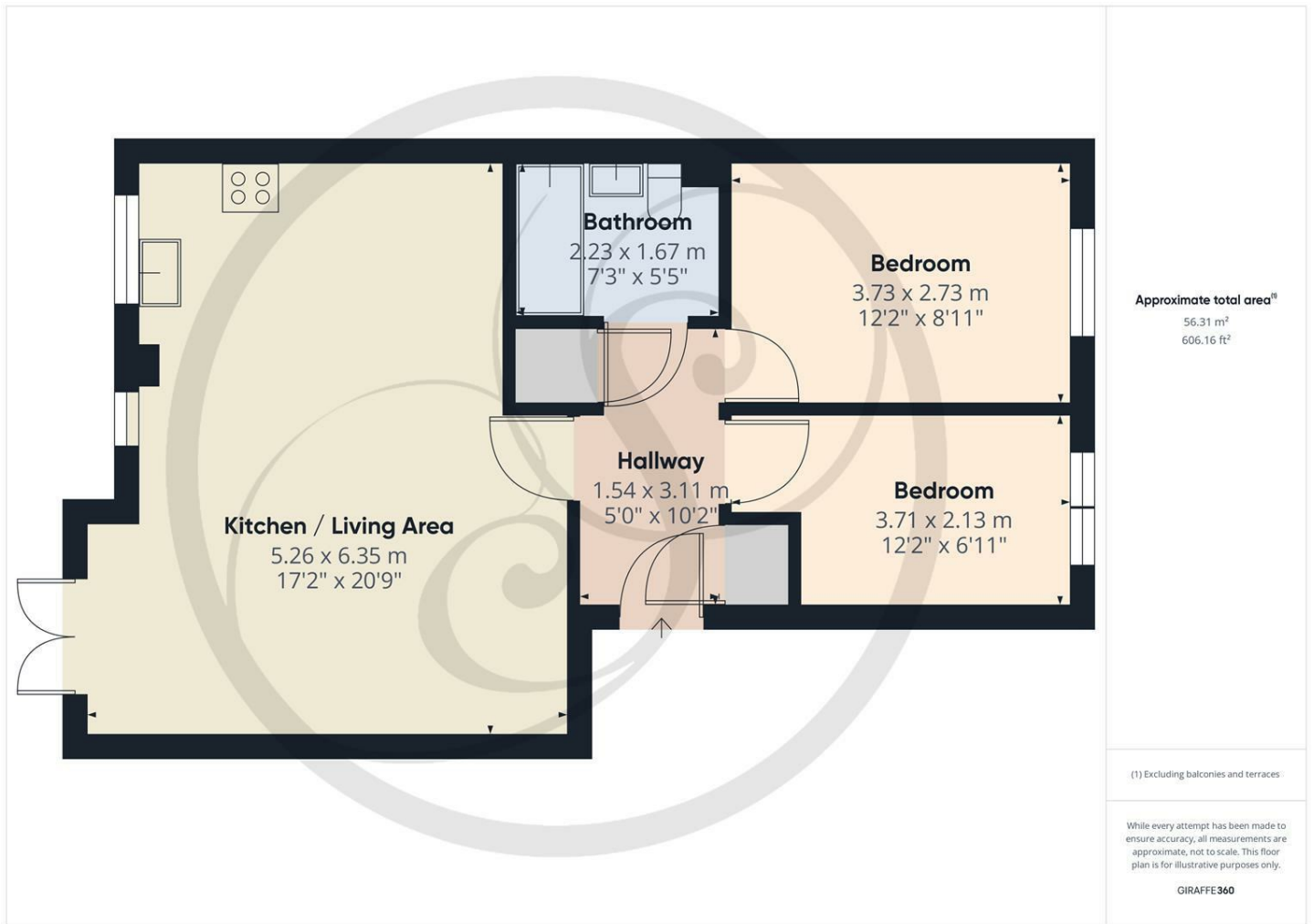

Area Map

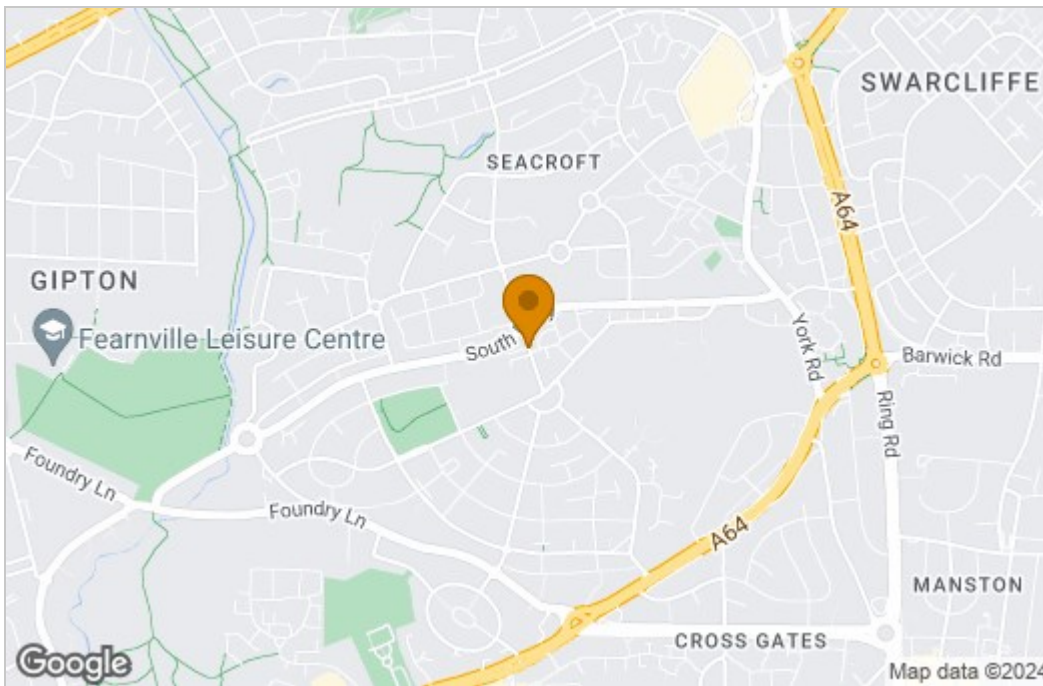

Energy Efficiency Graph

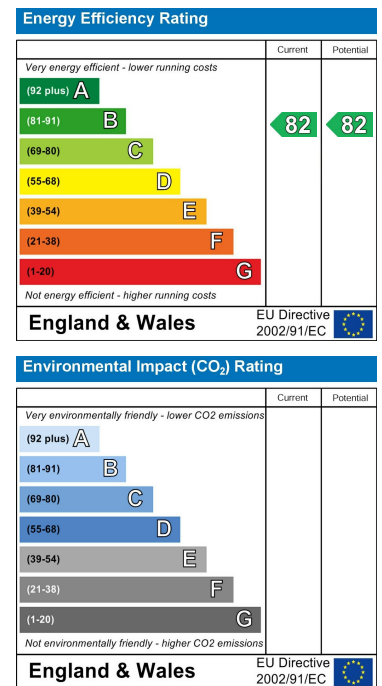

These particulars, whilst believed to be accurate are set out as a general outline only for guidance and do not constitute any part of an offer or contract. Intending purchasers should not rely on them as statements of representation of fact, but must satisfy themselves by inspection or otherwise as to their accuracy. No person in this firm's employment has the authority to make or give any representation or warranty in respect of the property.

