



Stoneacre
Properties



Clock Tower Lofts, Leeds, LS15 0QL

£75,000

Stoneacre Properties are delighted to be able to offer for sale a one bedroom apartment, located on the ground floor of a modern purpose built block. The flat, which has its own entrance, is located in the heart of Halton and is therefore moments away from all local amenities as well as being close to transport links into Leeds City Centre. Offered as a ready made investment with a tenant in situ. The accommodation comprises of a lounge, modern kitchen, bedroom and bathroom. Off street parking is also included.

Early viewings are advised. Please call a member of our team for further information.

Floor Plan

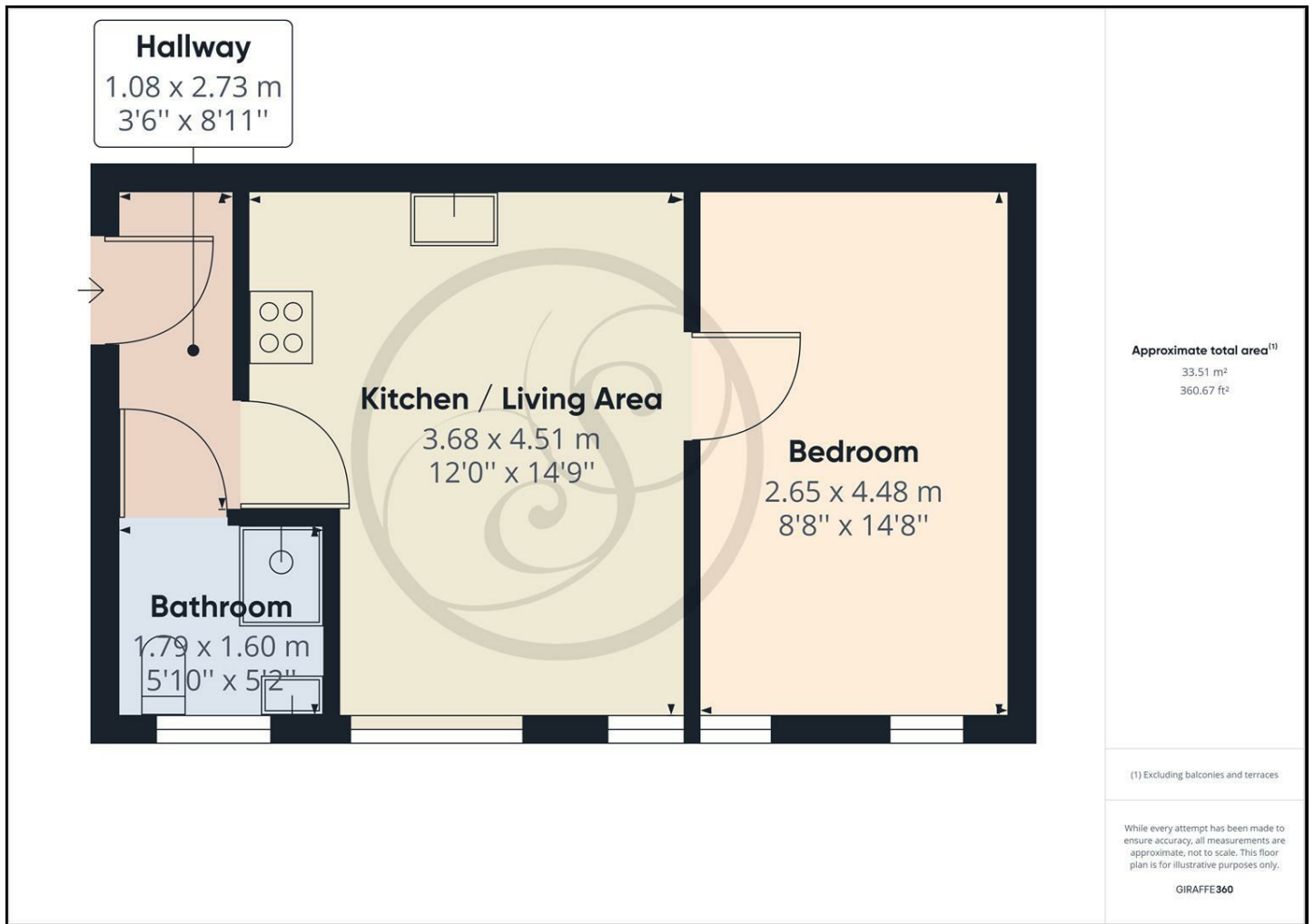

Area Map

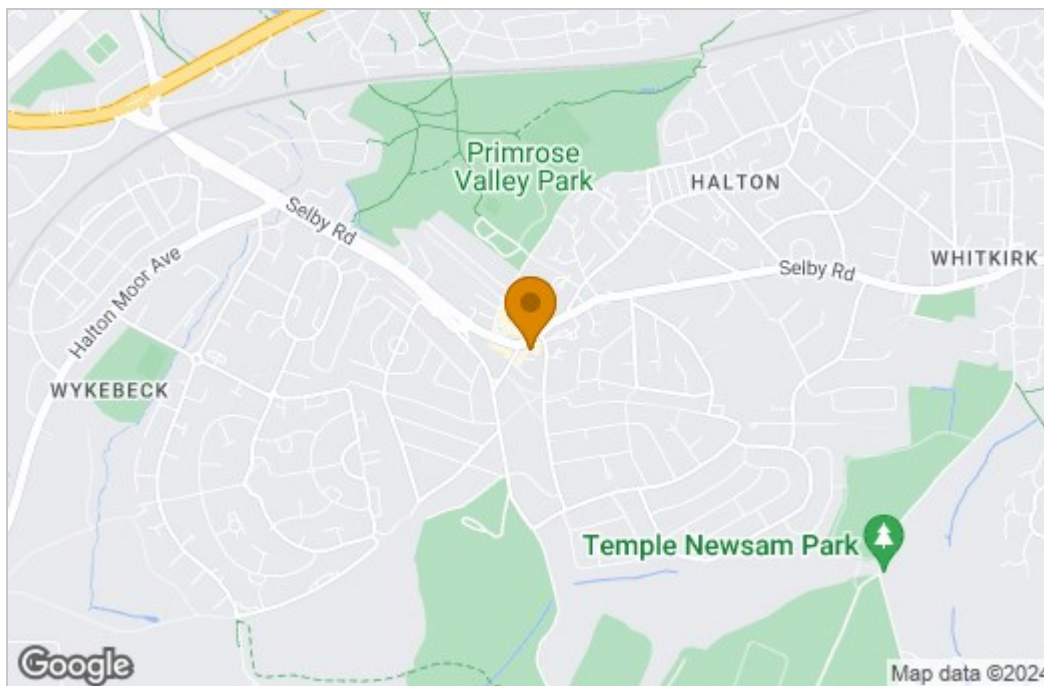

Energy Efficiency Graph

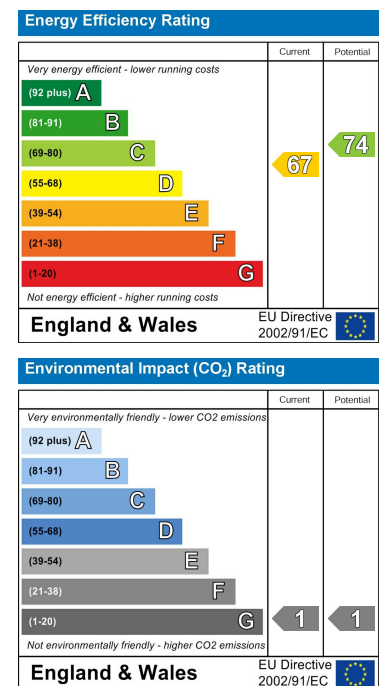

These particulars, whilst believed to be accurate are set out as a general outline only for guidance and do not constitute any part of an offer or contract. Intending purchasers should not rely on them as statements of representation of fact, but must satisfy themselves by inspection or otherwise as to their accuracy. No person in this firm's employment has the authority to make or give any representation or warranty in respect of the property.

