

Magnificent river facing penthouse with views towards Battersea Park and Power Station from the corner positioned Reception with slimline walnut herringbone parquet flooring into the Kitchen with integrated appliances concealed LED lighting and marble worktops.

The Master Bedroom is river facing with ample fitted wardrobes and full ensuite bathroom and separate shower. Bedroom three is next door and also boast river views. Bedroom two overlooks has an ensuite shower and over looks the patio which is accessed from the reception and there are stairs leading up to a private roof top terrace.



£5,250,000

**Penthouse**  
Capital Building  
Vauxhall  
SW8 5BL

**1201A**

3 Bedroom Penthouse

Total area:  
162.2 sqm / 1746 sqft

Living area:  
16100 x 5910 mm

Bedroom 1:  
4565 x 3090 mm

Bedroom 2:  
3265 x 3330 mm

Bedroom 3:  
3030 x 4115 mm

Patio + Roof Garden:  
85.3 sqm



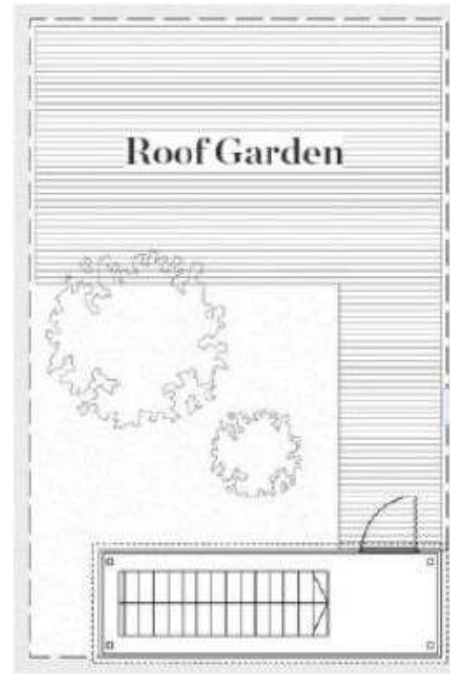

Central London  
↗

Thames River

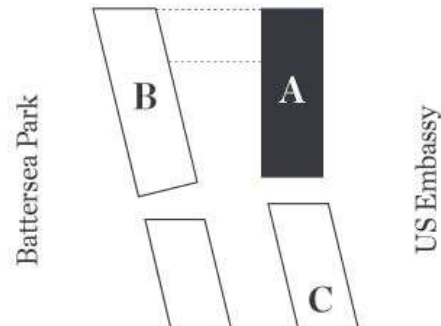

Fine & Country Fulham  
100-102 Wandsworth Bridge Road  
London  
SW6 2TF

0207 731 0031

[www.fineandcountry.com](http://www.fineandcountry.com)

- Penthouse
- Three Double Bedrooms
- Two Terraces
- Three Double Bedrooms
- Walnut Herringbone Parquet Floor
- Marble Flooring

Agents Note: Whilst every care has been taken to prepare these sales particulars, they are for guidance purposes only. All measurements are approximate and are for general guidance purposes only and whilst every care has been taken to ensure their accuracy, they should not be relied upon and potential buyers are advised to recheck the measurements before committing to any expense. Floor plans are not to scale. Internal photographs are reproduced for general information and it must not be inferred that any item shown is included in the property. The photographs may only represent part of the property and as they appeared at the time of being taken. No guarantee can be given as to the working condition of the various services and appliances. The agent has not tested any apparatus, equipment, fixtures or fittings or services and it is in the buyer's interests to check the working condition of any appliances.