



**15 New Meadow
Ivybridge
Devon
PL21 9PT
Guide Price £400,000**



15 New Meadow Ivybridge Devon PL21 9PT

FLOORPLAN

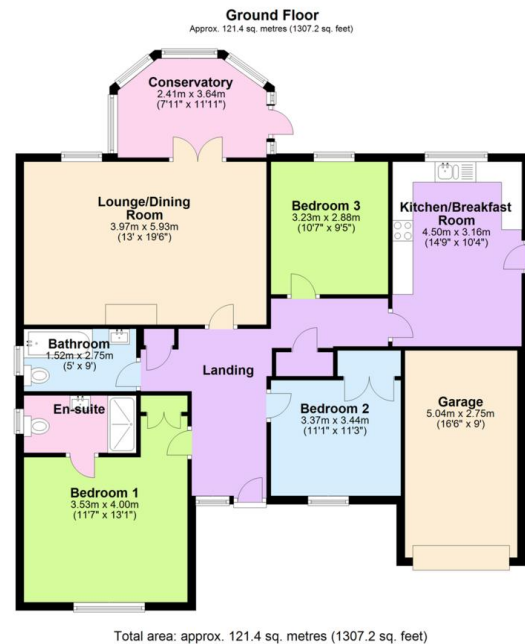

3



2



1



E



D 59



1307.
2
SQFT

Guide Price £400,000

SUMMARY

A 3 bedroom detached bungalow set within the corner of this small cul de sac on the western side of Ivybridge, convenient for local facilities and amenities. The bungalow offers an entrance hall, spacious lounge/diner, conservatory, modern kitchen/breakfast room, the 3 bedrooms, en suite shower/WC and family bathroom/WC, whilst externally there is a corner plot, parking and a garage. The bungalow is gas centrally heated and Upvc double glazed. No chain. EPC D 59.

No Chain | Garage And Parking | Gas Central Heating | Upvc Double Glazed | En Suite Shower/WC | Spacious Lounge/Diner | Modern Kitchen/Breakfast Room | Upvc Double Glazed Conservatory | Tucked Away Corner Plot | 3 Bedroom Detached Bungalow

CONTACT

19 Fore Street

Ivybridge

Devon

PL21 9AB

EMAIL

info@millingtontunncliff.co.uk

TEL

01752 896020

www.millingtontunncliff.co.uk