



**23 Chesterton Close
Plymouth
Devon
PL5 3SB**

Guide Price £172,500



23 Chesterton Close Plymouth Devon PL5 3SB

FLOORPLAN

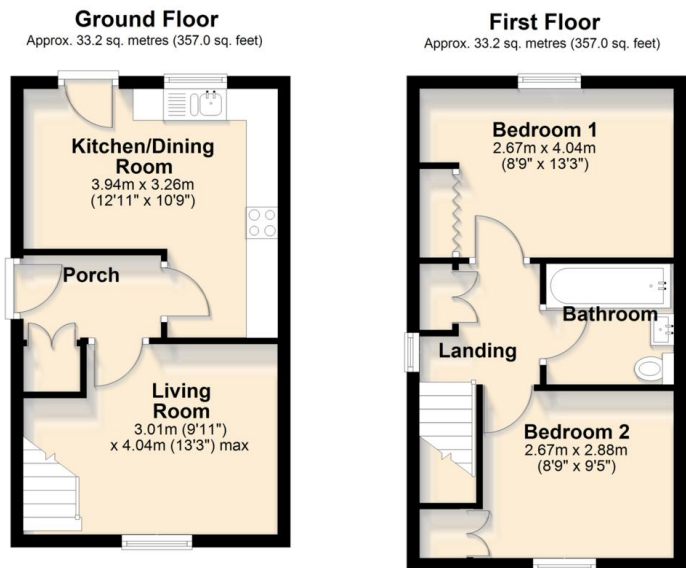

Total area: approx. 66.3 sq. metres (713.9 sq. feet)



2



1



1



B



D 58



713.9
SQFT

Guide Price £172,500

SUMMARY

A modern 2 double bedroom end terraced house located on this popular cul de sac served by most local facilities and amenities. The house offers an entrance hall, living room and kitchen/diner on the ground floor, together with landing, the 2 bedrooms and bathroom/WC on the upper floor. externally there is an enclosed garden at rear and two allocated car hardstands at side. The property is Upvc double glazed and has E7 heating. A perfect FTB or investment opportunity. No chain. EPC D 58.

EPC D 58 | Located At End Of Popular Cul De Sac | No Chain | Ideal FTB or Investment Opportunity | Two Allocated Car Hardstands | Enclosed Rear Garden | Upvc Double Glazing | E7 Heating | End Terraced | 2 Double Bedroom Modern House

CONTACT
19 Fore Street
Ivybridge
Devon
PL21 9AB

EMAIL
info@millingtontunnicliff.co.uk

TEL
01752 896020

www.millingtontunnicliff.co.uk