



MILLINGTON TUNNICLIFF

www.millingtontunncliff.co.uk

Woodburn Close, Ivybridge, PL21 9JQ

Guide Price £275,000

3 1 3



This three bedroom semi detached property is brought to the open market for the first time since it was built. Enjoying a southerly facing garden, the property is offered for sale with no onward chain and benefits from accommodation briefly comprising, lounge, dining area, fitted kitchen, sun room, three bedrooms and family shower room. Externally there are front and rear gardens and garage with driveway to the side. EPC C 69.

01752 896020 | info@millingtontunncliff.co.uk | 19 Fore Street, Ivybridge, Devon, PL21 9AB



MILLINGTON TUNNICLIFF

www.millingtontunncliff.co.uk

Key Features

- Semi Detached Home
- Three Bedrooms
- Lounge, Dining Area & Sun Room To The Ground Floor
- Fitted Kitchen
- Family Shower Room
- Garage & Driveway
- Southerly Facing Rear Garden
- Gas Central Heating & Double Glazing
- Cul De Sac Location
- No Onward Chain

Ground Floor

Approx. 41.6 sq. metres (447.2 sq. feet)

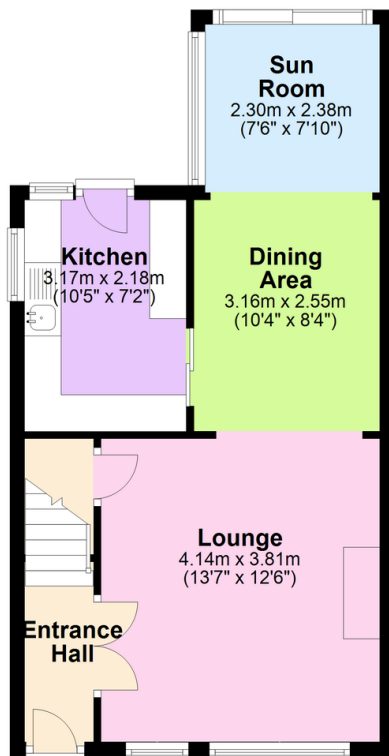

First Floor

Approx. 35.8 sq. metres (385.5 sq. feet)

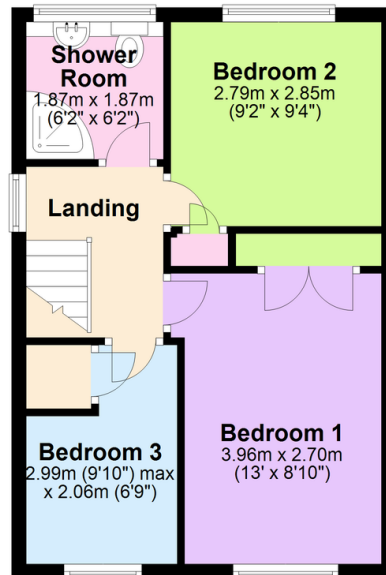

Total area: approx. 77.4 sq. metres (832.8 sq. feet)

01752 896020 | info@millingtontunncliff.co.uk | 19 Fore Street, Ivybridge, Devon, PL21 9AB