



MILLINGTON TUNNICLIFF

www.millingtontunnickliff.co.uk

Erme Drive, Ivybridge, PL21 9BN

£435,000

3 1 1



01752 896020 | info@millingtontunnickliff.co.uk | 19 Fore Street, Ivybridge, Devon, PL21 9AB



MILLINGTON TUNNICLIFF

www.millingtontunncliff.co.uk

- Detached Bungalow
- L Shaped Lounge/Diner
- Master Bedroom With Dressing Room
- Conservatory
- Garage & Driveway
- Three Bedrooms
- Fitted Kitchen
- Bathroom With Separate WC
- Attractive Gardens With Countryside Views
- No Onward Chain

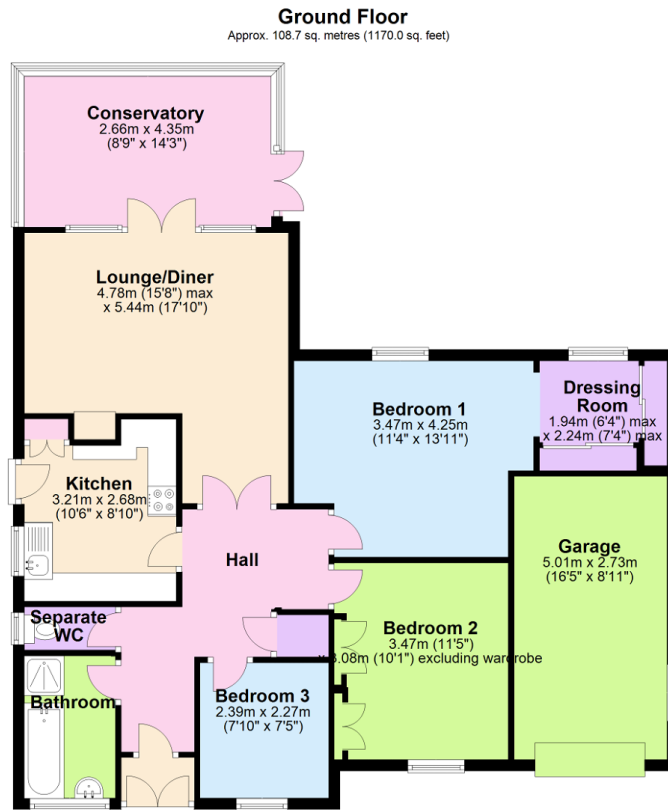

Total area: approx. 108.7 sq. metres (1170.0 sq. feet)

A delightful bungalow situated within close walking distance of the town, enjoying elevated views over the surrounding countryside. Located in a quiet cul-de-sac and offered for sale with no onward chain, the bungalow offers spacious accommodation to include; L shaped lounge/diner, fitted kitchen, three bedrooms, dressing room, bathroom with separate WC and conservatory. Outside there is a lovely lawned garden with patio area and garage with driveway parking. EPC D 67

01752 896020 | info@millingtontunncliff.co.uk | 19 Fore Street, Ivybridge, Devon, PL21 9AB