





## Manor Close, Ivybridge, PL21 9BQ

£220,000

 3  1  2



A 3 bedroom town house located centrally convenient for Manor primary school and a short walk from Ivybridge centre. The property has an entrance hall, living room and modern kitchen/diner on the ground floor, together with landing, the 3 bedrooms and modern bathroom on the upper floor. The house is Upvc double glazed, has gas central heating, a small garden and offers no onward chain. EPC C 72.



# MILLINGTON TUNNICLIFF

[www.millingtontunncliff.co.uk](http://www.millingtontunncliff.co.uk)

## Key Features

- 3 Bedroom Mid Terraced House
- Modern Fitted Kitchen/Diner
- Modern Bathroom/WC
- Upvc Double Glazing
- Gas Central Heating
- Small Gardens
- EPC C 72
- Convenient For Manor Primary School
- Convenient For Ivybridge Centre
- No Chain

### Ground Floor

Approx. 36.1 sq. metres (389.0 sq. feet)

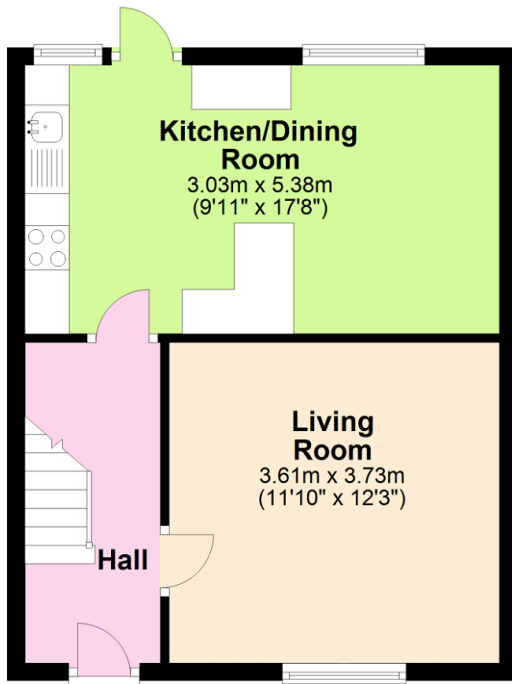

### First Floor

Approx. 35.8 sq. metres (385.4 sq. feet)

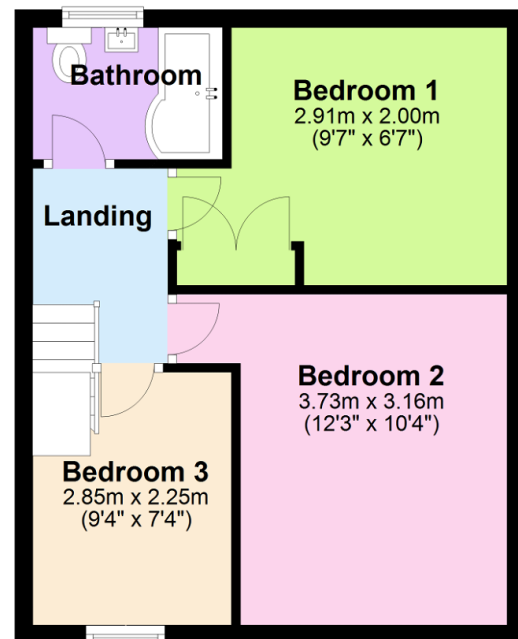

Total area: approx. 71.9 sq. metres (774.4 sq. feet)

01752 896020 | [info@millingtontunncliff.co.uk](mailto:info@millingtontunncliff.co.uk) | 19 Fore Street, Ivybridge, Devon, PL21 9AB