



The Square, Ermington, Ivybridge, PL21 9LP

£219,950

2 1 1



SPACIOUS APARTMENT IN VILLAGE LOCATION A spacious two double bedroom ground floor apartment positioned in the sought after village of Ermington. Offering light and airy accommodation the apartment briefly comprises; dining hallway, kitchen, lounge/diner, two double bedrooms, bathroom and utility room. Outside there is a private terrace and communal parking area. EPC D 59.



Key Features

- Leasehold Apartment With 999 Year Lease
- Two Double Bedrooms
- Fitted Kitchen
- Utility Room With WC
- Village Location
- Spacious Accommodation
- Lounge/Diner With French Doors To Private Terrace
- Bathroom
- Off Road Parking
- Please Enquire For Further Information On Sale Conditions

Ground Floor

Approx. 103.5 sq. metres (1114.3 sq. feet)

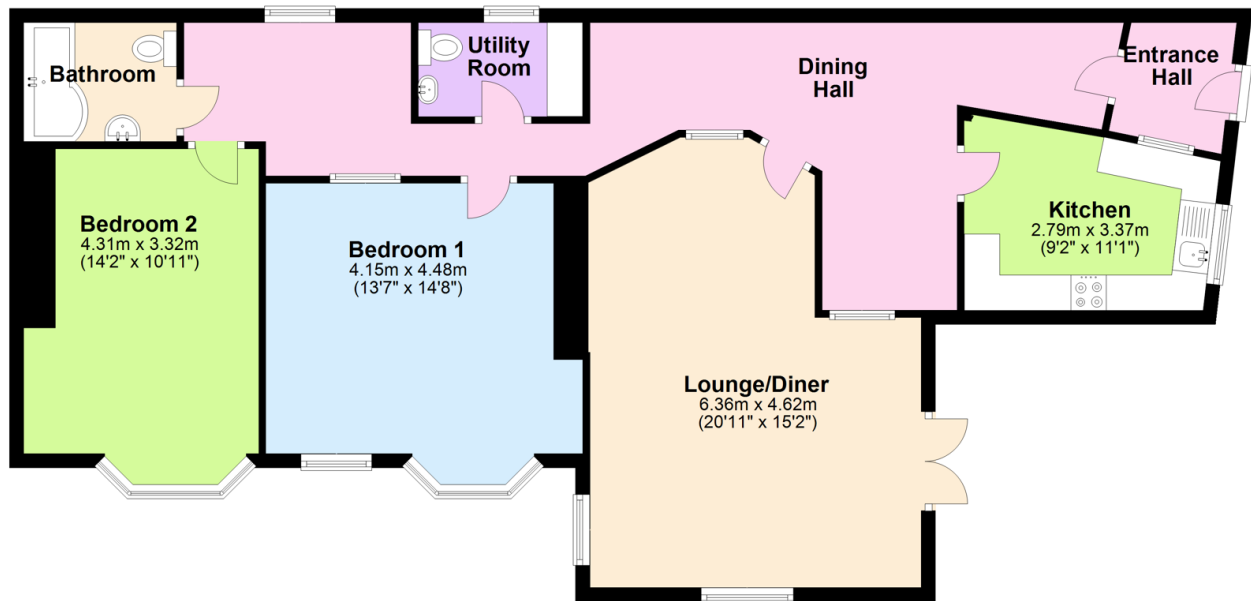

Total area: approx. 103.5 sq. metres (1114.3 sq. feet)