



Guide Price

£300,000

Freehold

2x  1x  1x 

**Middle Village,
Haywards Heath, West
Sussex, RH16**

OVER 60?

Secure this property
for up to **59% less!**

cubitt&west
Helping you move forwards



Main features

- Freehold coach house
- Cul-de-sac location
- The convenience of a garage with power & off-road parking
- 2 storage cupboards in hallway & large insulated loft
- Refitted kitchen & bathroom
- Bathroom with bath tub & separate shower cubicle
- Combination boiler recently installed
- Close to local Co-op and walking distance to train station

Accommodation

FIRST FLOOR

Entrance Hallway

Lounge/Diner: 16'3 x 12'10 (4.96m x 3.91m)

Kitchen: 12'5 x 6'9 (3.79m x 2.06m)

Bedroom 1: 12'8 x 10'2 (3.86m x 3.10m)

Bedroom 2: 9'0 x 8'9 (2.75m x 2.67m)

Bathroom

OUTSIDE

Garage: 19'11 x 8'9 (6.07m x 2.67m)

Off- Road Parking

First Floor
Approx. 61.9 sq. metres (666.8 sq. feet)

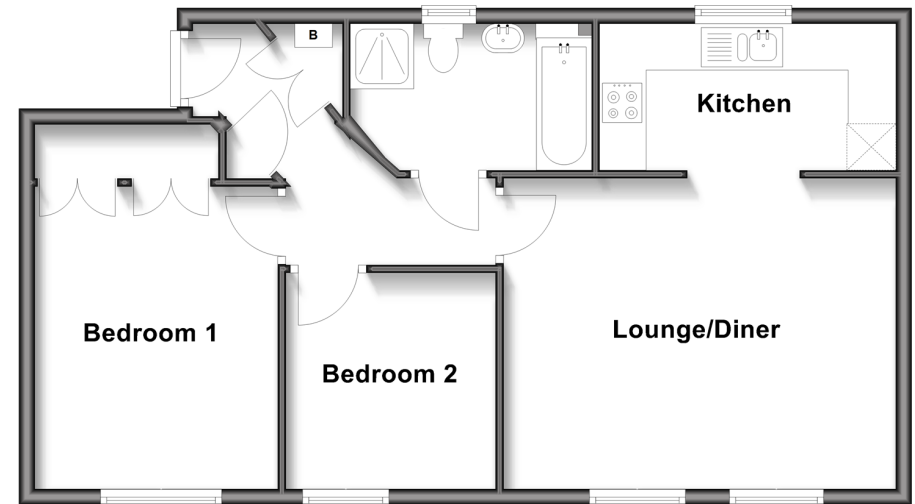

Call Haywards Heath - 01444 411132 ■ cubittandwest.co.uk

■ Legal advice should be taken to verify fixtures/fittings, planning, alterations and/or lease details
 ■ Through a Homewise Home For Life Plan people aged 60+ can secure this property for up to 59% less, by purchasing a Lifetime Lease.

■ Appliances & services are untested, dimensions are approximate and floor plans are not to scale