



Guide Price
£450,000

Freehold

3x  1x  3x 

**Franklynn Road,
Haywards Heath, West
Sussex, RH16**

OVER 60?

Secure this property
for up to **59% less!**

cubitt & west
Helping you move forwards



Main features

- No forward chain
- Large sunny rear garden
- Off road parking
- Walking distance to town & train station
- Re-fitted kitchen with integral appliances & refitted bathroom
- Open fire place
- Recently installed combination boiler

Accommodation

GROUND FLOOR

Entrance Hallway
 Lounge: 13'11 x 9'0 (4.24m x 2.75m)
 Dining Room: 11'9 x 10'9 (3.58m x 3.28m)
 Kitchen: 10'6 x 9'3 (3.20m x 2.82m)
 Study: 8'11 x 6'11 (2.72m x 2.11m)

FIRST FLOOR

Landing
 Bedroom 1: 12'0 x 9'0 (3.66m x 2.75m)
 Bedroom 2: 10'9 x 10'7 (3.28m x 3.23m)
 Bedroom 3: 9'10 x 9'0 (3.00m x 2.75m)
 Bathroom

OUTSIDE

Front & Rear Garden
 Off Road Parking

Ground Floor

Approx. 42.4 sq. metres (456.2 sq. feet)

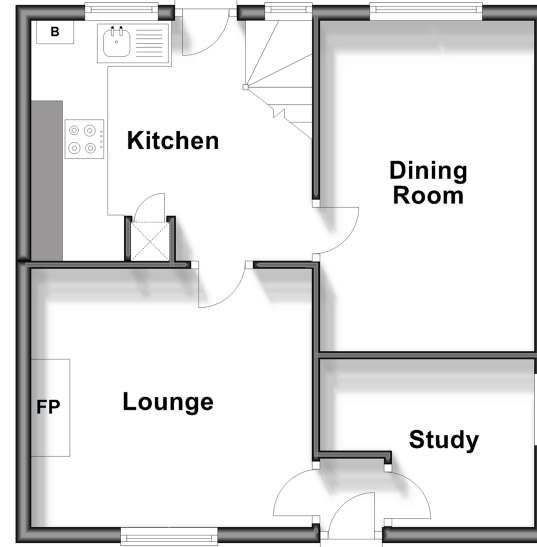

First Floor

Approx. 42.3 sq. metres (455.0 sq. feet)



Call Haywards Heath - 01444 411132 ■ cubittandwest.co.uk

■ Legal advice should be taken to verify fixtures/fittings, planning, alterations and/or lease details
 ■ Through a Homewise Home For Life Plan people aged 60+ can secure this property for up to 59% less, by purchasing a Lifetime Lease.

■ Appliances & services are untested, dimensions are approximate and floor plans are not to scale



22705933/20240930/MG/DD