



2,114
CELTIC
STREET
G20 0BU



No other agency has nearing 500 five star Google reviews 0800 074 8585



The kitchen, measuring 1.86m x 3.00m, is thoughtfully designed with both style and functionality in mind. Featuring modern fitted units, generous countertop space, and room for integrated appliances, it is ideal for those who love to cook. Its sleek finishes and practical layout make it a delightful space to prepare meals and enjoy casual dining.

The living room is the heart of the home, offering a bright and spacious area to relax or entertain. Measuring 4.04m x 3.64m, it benefits from a large window that floods the room with natural light, creating a warm and inviting atmosphere. With ample space for a variety of furniture configurations, this room is perfect for cozy evenings in or hosting friends and family.



The bathroom, measuring 1.86m x 1.77m, is stylish and modern, featuring a three-piece suite. It includes a bathtub with an overhead shower, a WC, and a washbasin. Neutral tiling and thoughtful design create a relaxing and practical space for everyday use.



The primary bedroom is a generously sized retreat, measuring 3.47m x 3.21m. This tranquil space easily accommodates a double bed, bedside tables, and wardrobe or storage options. The room's large window allows plenty of natural light, while its layout provides a peaceful sanctuary for rest and relaxation. The second bedroom, at 2.94m x 2.13m, is a versatile space suited to a variety of needs. Whether used as a guest room, home office, or nursery, it offers comfort and flexibility. The room's cozy proportions and natural light make it a welcoming and functional addition to the home.



The communal back garden offers a peaceful outdoor space, ideal for relaxing or socializing. Surrounded by mature trees and greenery, this well-maintained area provides a sense of privacy and calm. The lawn is spacious and versatile, perfect for outdoor activities, while the pathways ensure easy access for residents.

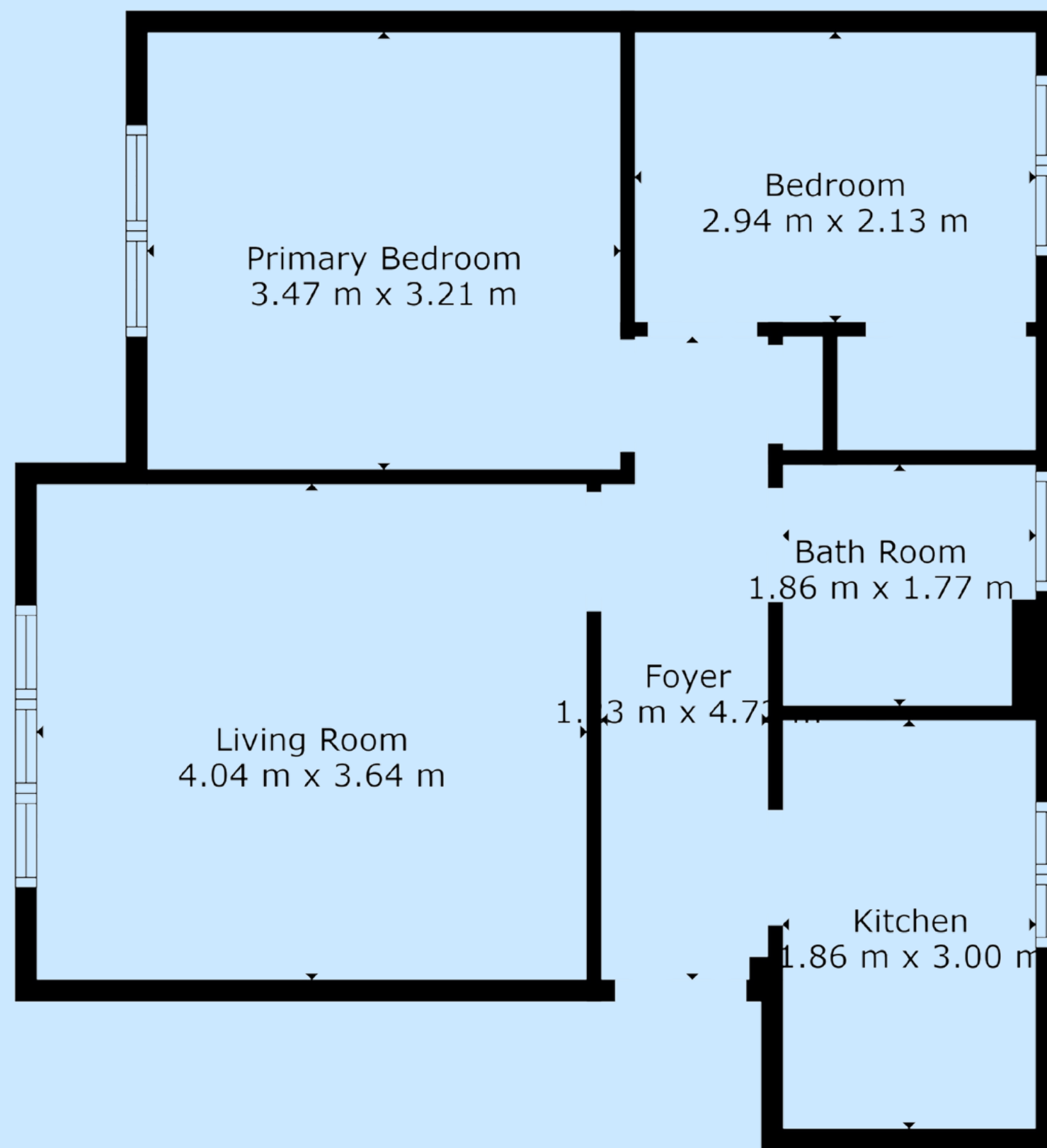

TOTAL: 50 m2
FLOOR 1: 50 m2

