





Nestled away from the main road, this charming upper cottage flat with splendid views and south facing gardens, is in walk-in condition, offering a blend of comfort and convenience. The property boasts a private entrance, with stairs leading to the main living area. Upon entry, you're welcomed by a bright entrance hallway that guides you to a well-proportioned lounge perfect for relaxing or entertaining.

MQ Assisted Move, Part Exchange and 95% mortgages are available.

The flat features two spacious bedrooms, one of which comes with a generous storage cupboard. The well-appointed kitchen is both practical and stylish, ideal for everyday meals. The shower room offers flexibility, with the option to install a bath if desired.

An abundance of storage space is available throughout, including a floored attic with electricity. Externally, the property benefits from a private driveway, large wooden shed and a secluded south facing garden, perfect for enjoying outdoor space.

Additional features include double glazing, gas central heating, and proximity to key amenities such as Wishaw University Hospital, the town centre, sports centre, and Wishaw train station, with easy access to regular bus routes. This flat offers a fantastic opportunity for first-time buyers, downsizers, or investors looking for a low-maintenance, move-in-ready home.

MQ Estate Agents are open 7 days a week: Monday to Friday 8am to 8:30pm & Saturday & Sunday 8.30am - 8pm to arrange your viewing or valuation appointment.







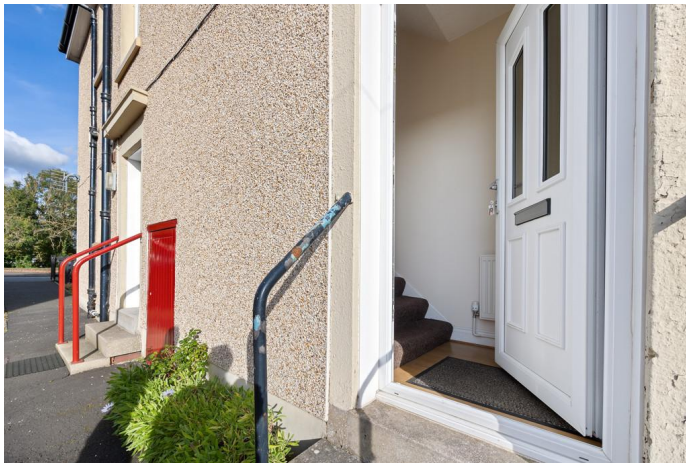

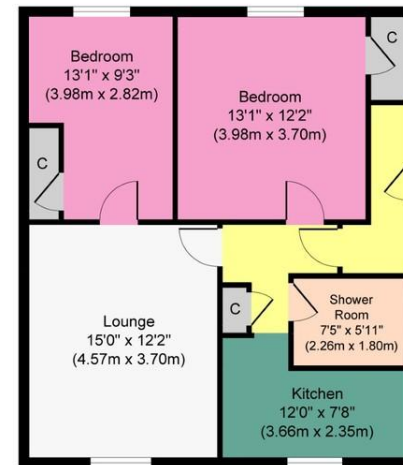

Approximate Floor Area
694 sq. ft
(64.52 sq. m.)

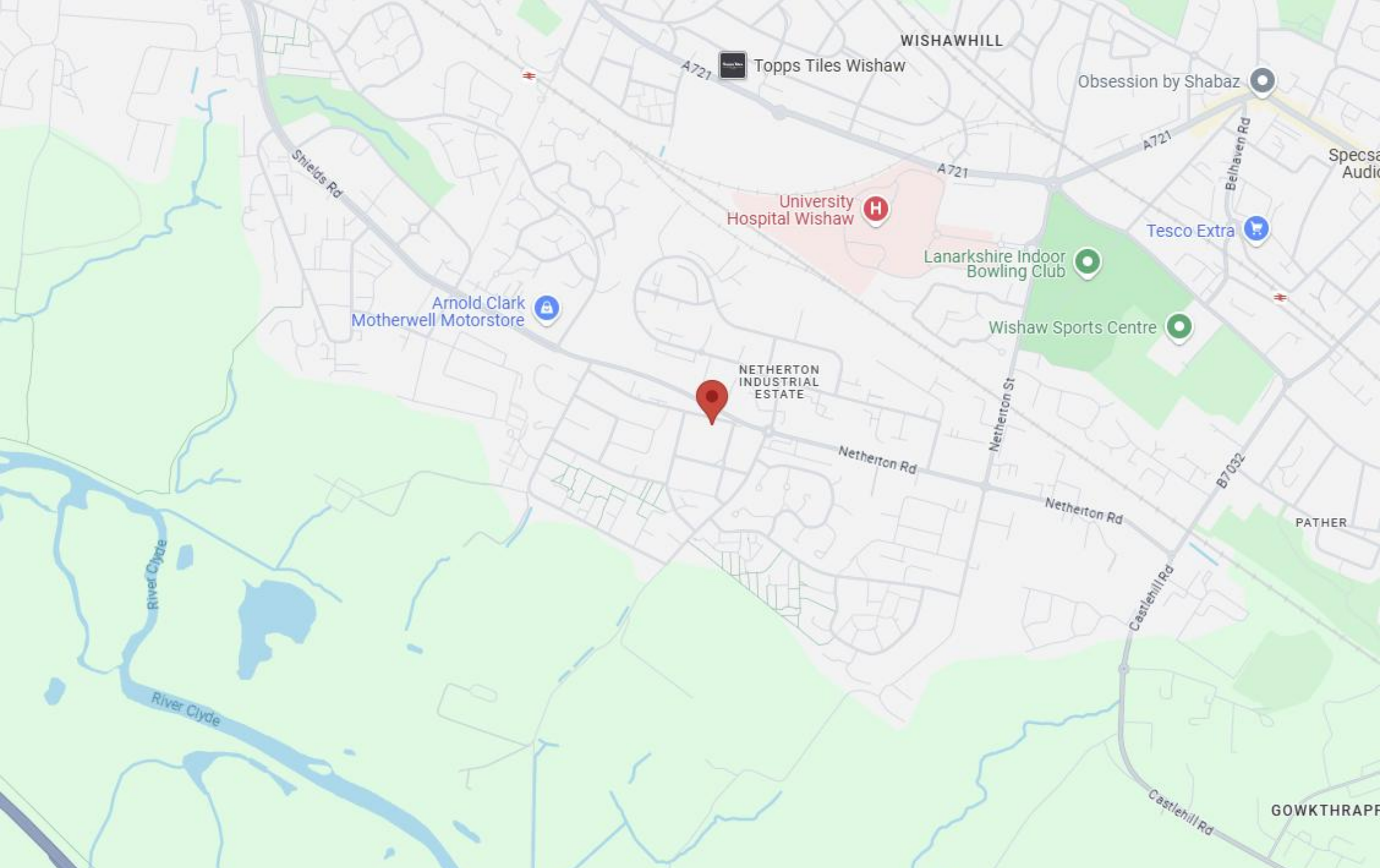

Call free on 0800 074 8585

www.mqestateagents.co.uk

We are registered with the Office of Fair Trading and the Property Ombudsman. You can be confident that the service is not only regulated but also fully transparent. Whilst every precaution to ensure accuracy has been taken during the preparation of these particulars, if there is any aspect which is critical to your interest or which you find misleading, please contact us for further information. In accordance with the terms of the Property Misdescriptions Act, we wish to clarify all kitchen appliances or indeed and other mechanical items, apparatus or appliances relating to this property, including the central heating system, has not been inspected or tested and therefore MQ Estate Agents Limited do not warrant either now or at a later date their correct functions. Please note photographs taken with a wide angled lens and all measurements are approximate and are taken with a laser tape measure, therefore MQ Estate Agents Limited cannot guarantee true room sizes and will not be held responsible.