

72 Gilbertfield Wynd, Cambuslang, South Lanarkshire, G72 8WR

Offers Over £250,000





Welcome to this exquisite modern semi-detached home, perfectly situated in a highly sought-after family development in Cambuslang, on the south-east outskirts of Glasgow. This stunning property boasts contemporary design and luxurious finishes throughout, ensuring a comfortable and stylish living experience.

MQ Assisted Move, Part Exchange and 95% mortgages are available.

#### Key Features:

**Spacious Lounge:** The inviting lounge is ideal for relaxation and entertaining, featuring ample natural light and modern décor.

**Gourmet Kitchen:** The sleek and stylish kitchen is equipped with top-of-the-line appliances and abundant counter space, perfect for the culinary enthusiast.

**Separate Sitting Room with Office Space:** This versatile space offers a cosy sitting area, with an adjacent office nook, making it ideal for work-from-home arrangements.

**Three Bedrooms:** The home includes three well-proportioned bedrooms, each designed for comfort and tranquillity. The master bedroom is a true retreat, complete with an en-suite shower room.

**Modern Bathroom:** The contemporary family bathroom is finished to the highest standard, featuring elegant fixtures and fittings.

**Enclosed Rear Garden:** The level and enclosed rear garden is perfect for outdoor activities and gatherings, providing a safe and private space for children and pets to play.



Front Garden & Driveway: The low-maintenance front garden primarily serves as a spacious driveway, offering ample parking for multiple vehicles.

Located in the vibrant community of Cambuslang, this home offers the perfect blend of suburban tranquillity and urban convenience, with easy access to local amenities, schools, and transport links. Don't miss the opportunity to make this luxurious modern home yours.

Contact us today to schedule a viewing!

MQ Estate Agents are open 7 days a week: Monday to Friday 8am to 9pm & Saturday & Sunday 8.30am - 9pm to arrange your viewing or valuation appointment.

#### LOUNGE

16' 9" x 10' 6" (5.13m x 3.21m)

#### KITCHEN

11' 2" x 8' 0" (3.42m x 2.45m)

#### SITTING ROOM

#### MASTER BEDROOM

13' 8" x 11' 9" (4.19m x 3.58m)

#### BEDROOM TWO

12' 8" x 6' 8" (3.06m x 2.84m)

#### BEDROOM THREE

9' 4" x 8' 1" (2.85m x 2.47m)

#### BATHROOM

#### EN-SUITE SHOWER ROOM

#### WC





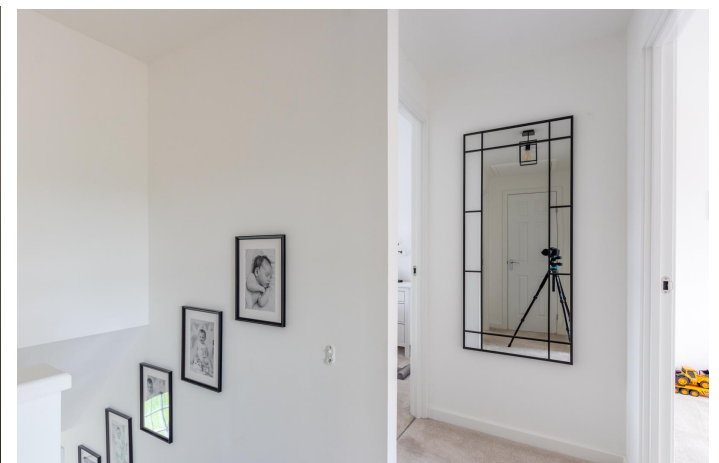

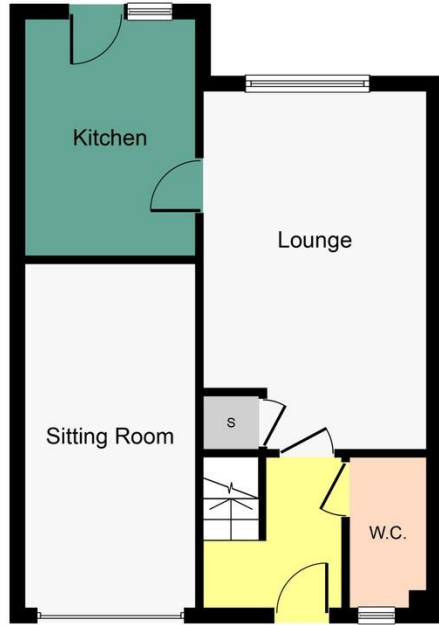

Ground Floor

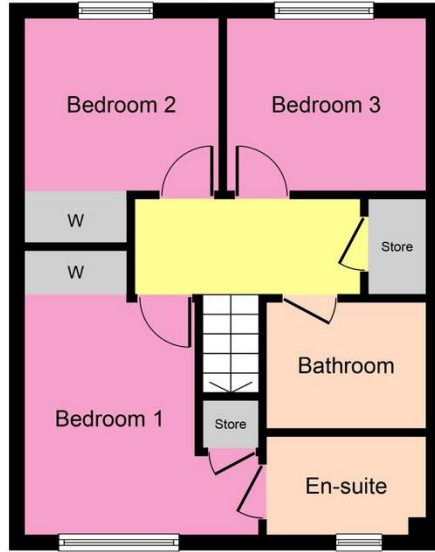

First Floor



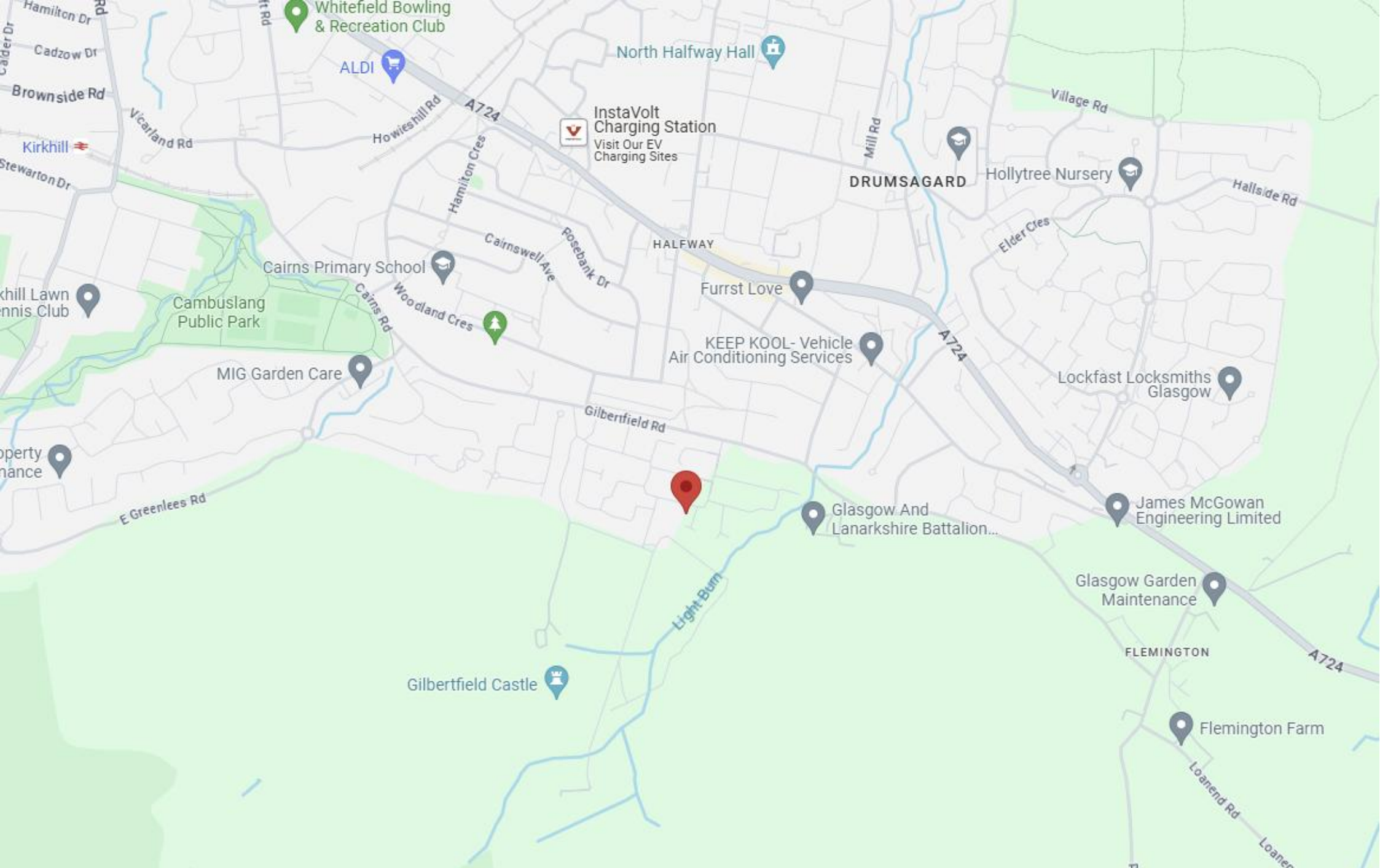

Call free on 0800 074 8585

[www.mqestateagents.co.uk](http://www.mqestateagents.co.uk)

We are registered with the Office of Fair Trading and the Property Ombudsman. You can be confident that the service is not only regulated but also fully transparent. Whilst every precaution to ensure accuracy has been taken during the preparation of these particulars, if there is any aspect which is critical to your interest or which you find misleading, please contact us for further information. In accordance with the terms of the Property Misdescriptions Act, we wish to clarify all kitchen appliances or indeed and other mechanical items, apparatus or appliances relating to this property, including the central heating system, has not been inspected or tested and therefore MQ Estate Agents Limited do not warrant either now or at a later date their correct functions. Please note photographs taken with a wide angled lens and all measurements are approximate and are taken with a laser tape measure, therefore MQ Estate Agents Limited cannot guarantee true room sizes and will not be held responsible.