



Elm Park Gardens, SW10

£1,795,000

A wonderful apartment with access to communal gardens. This property boasts perfectly balanced space and comprises of three bedrooms, a utility room, separate study and a large reception room.

Elm Park Gardens is ideally situated between the King's Road and Fulham Road. South Kensington, Gloucester Road and Sloane Square tube stations are all within walking distance.

Features

- Lift
- Leasehold (180 years)
- Three Bedrooms
- Excellent Natural Light
- Separate Study & Utility Room
- Access To Communal Gardens

Elm Park Gardens, London, SW10

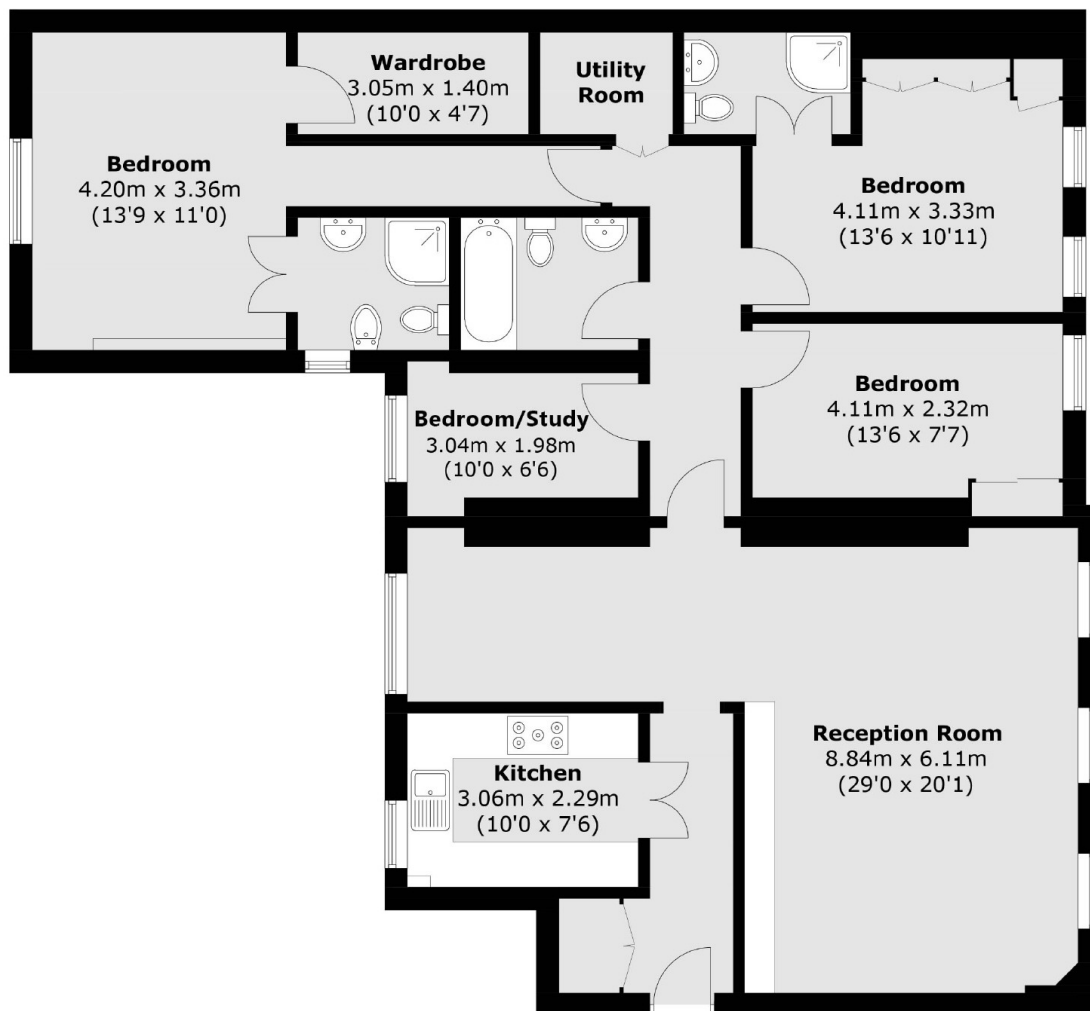

THIRD FLOOR

Total area (approx.): 128.2 sq. m (1,379.9 sq. ft)