



## Elm Park Gardens, SW10

£2,150,000

A wonderful apartment with access to communal gardens. This property boasts perfectly balanced space and comprises of three bedrooms, a utility room, separate study and a large reception room.

Elm Park Gardens is ideally situated between the King's Road and Fulham Road. South Kensington, Gloucester Road and Sloane Square tube stations are all within walking distance.

### Features

- Lift
- Leasehold (180 years)
- Three Bedrooms
- Excellent Natural Light
- Separate Study & Utility Room
- Access To Communal Gardens

# Elm Park Gardens, London, SW10

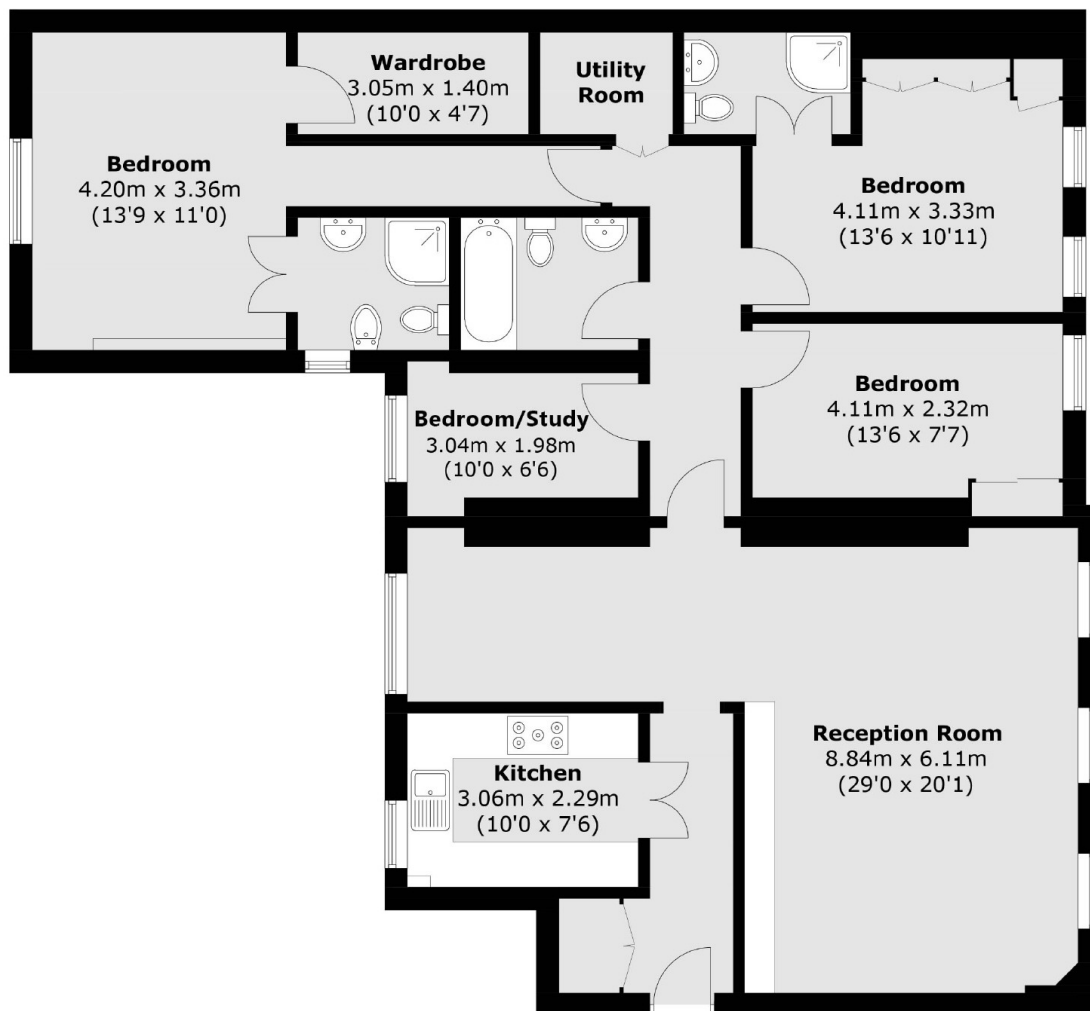

## THIRD FLOOR

Total area (approx.): 128.2 sq. m (1,379.9 sq. ft)