



Pooles Lane, SW10

£1,200 Per week

A four double bedroom, two bathroom semi detached house set in a beautiful quiet gated development. The house benefits from an amazing living space which leads directly out onto the large private patio garden.

Pooles Lane is a gated development ideally located south of the King's Road. Chelsea Harbour and Fulham Broadway both offer a number of transport links and local amenities.

Features

- Four Double Bedrooms
- Two Bathrooms
- Private Parking
- Gated Development
- Conservatory
- Patio Garden

Pooles Lane, London, SW10

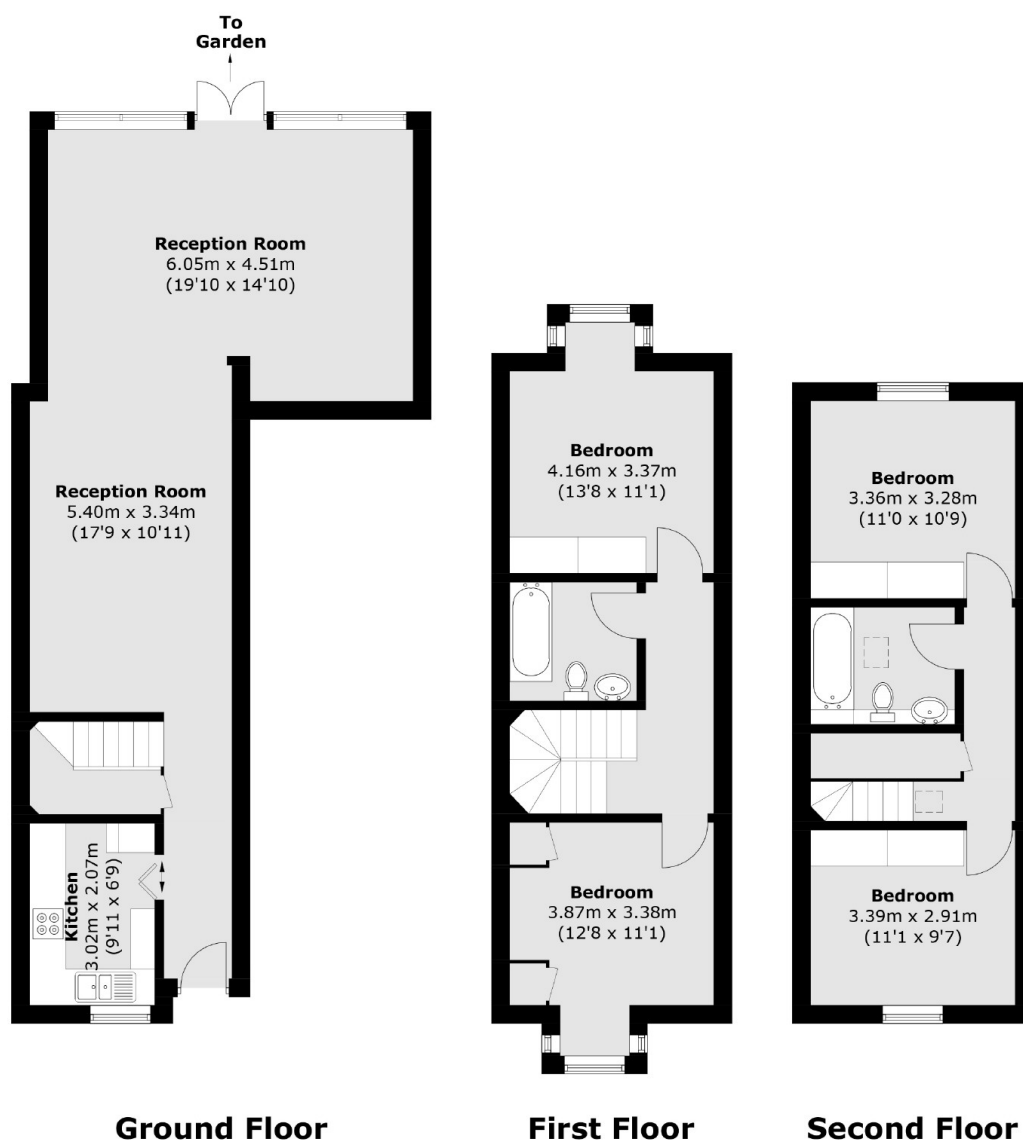

Total area (approx.): 132.0 sq. m (1,420.9 sq. ft)

Dexters

Chelsea and Belgravia
45 Sloane Avenue
London
SW3 3DH
Lettings
020 7590 9500

Energy Rating: C. We aim to make our particulars both accurate and reliable. However they are not guaranteed; nor do they form part of an offer or contract. If you require clarification on any points then please contact us, especially if you're traveling some distance to view. Please note that appliances and heating systems have not been tested and therefore no warranties can be given as to their good working order.

RICS Regulated
Estate Agent
and Letting Agent

dexters.co.uk