



Smith Street, SW3

£895,000

A magnificent one bedroom apartment ideally positioned south of the King's Road. This property has plenty of character throughout and benefits from a share of the freehold.

Smith Street runs south of the King's Road to Burton Court. Duke of York Square, Pavilion Road and Peter Jones are all within easy walking distance.

Features

- Share Of Freehold
- Separate Storage
- Period Building
- Popular Location
- Great Condition
- Low Service Charge

Smith Street, London, SW3

Smith Street, SW3

Approximate Internal Area

527 sq ft/ 49 sq m

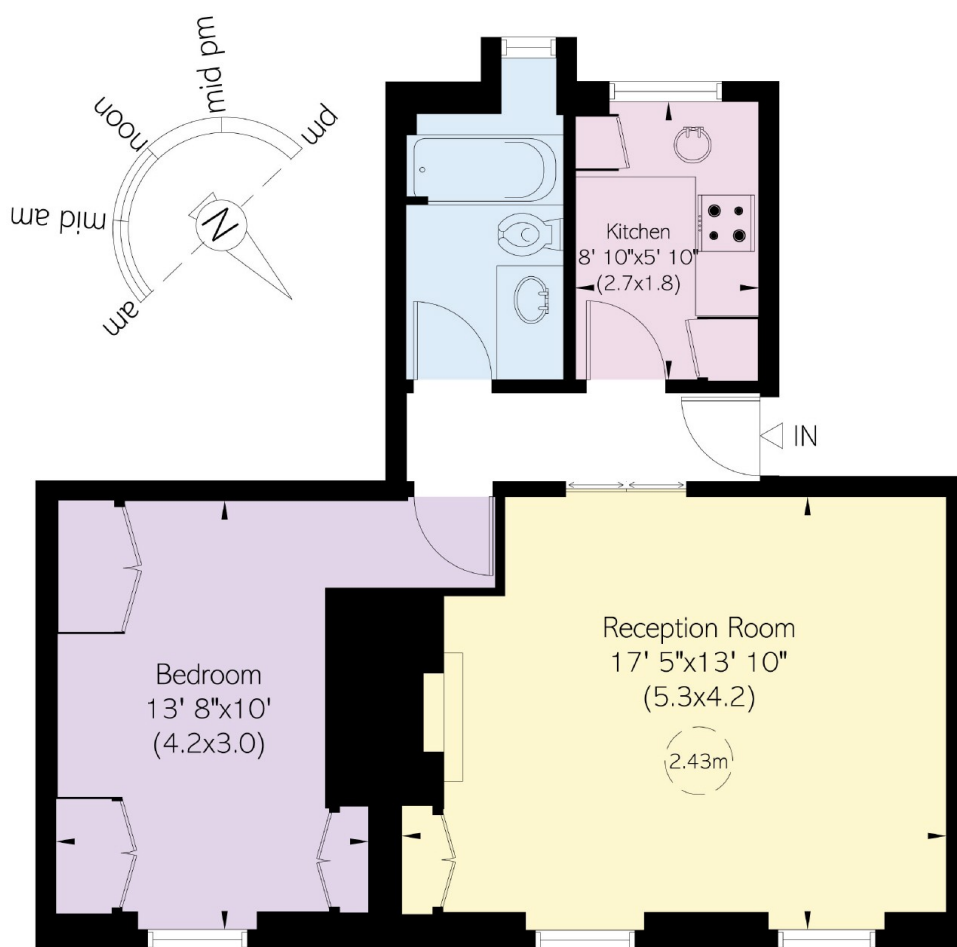

Second Floor