



Draycott Place, SW3

£920 Per week

Two double bedroom apartment to let in a beautiful red brick period building. This flat has direct lift access, wood floors throughout and a south facing living room. Perfect for professional tenants and students.

The apartment is located between Sloane Avenue and the Kings Road in the heart of Chelsea. Close to many shops, bars and restaurants, this a super exciting area to live in.

Features

- Two Double Bedrooms
- Wood Flooring
- Second Floor With Lift Access
- Open Plan Kitchen
- South Facing Living Room
- Period Building

Draycott Place, London, SW3

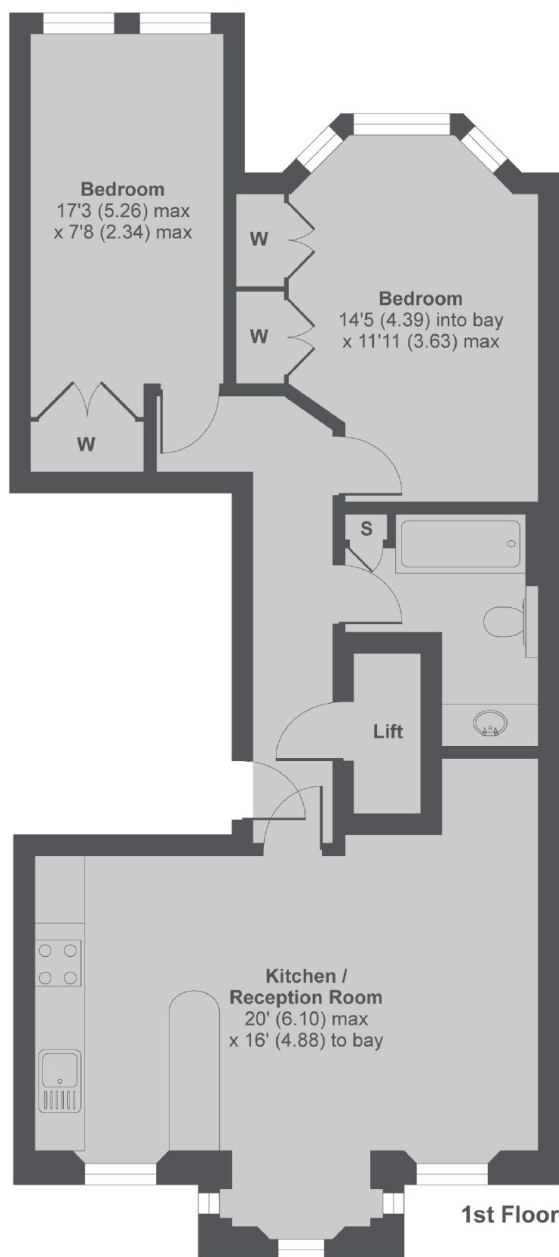

Draycott Place SW3

MAIN HOUSE APPROX FLOOR AREA 712 SQ.FT 66.1 SQ.M (INCLUDES LIFT)

Copyright nichecom.co.uk 2017 Produced for Dexters REF : 195883

Dexters

Chelsea and Belgravia
45 Sloane Avenue
London
SW3 3DH
Lettings
020 7590 9500

Energy Rating: C. We aim to make our particulars both accurate and reliable. However they are not guaranteed; nor do they form part of an offer or contract. If you require clarification on any points then please contact us, especially if you're traveling some distance to view. Please note that appliances and heating systems have not been tested and therefore no warranties can be given as to their good working order.

 **RICS** Regulated
Estate Agent
and Letting Agent

dexters.co.uk