



First Street, SW3

£1,795,000

A unique property in the heart of Chelsea. This freehold maisonette has two private entrances and plenty of development potential, giving an incoming purchaser the opportunity to create a wonderful home while adding value.

First Street is a quiet one way street located south of Walton Street. Pavilion Road, Harrods and the King's Road are all within walking distance.

Features

- Freehold
- Two Bedrooms
- Two Private Entrances
- Quiet Location
- Split Level Apartment
- Development Opportunity

First Street, London, SW3

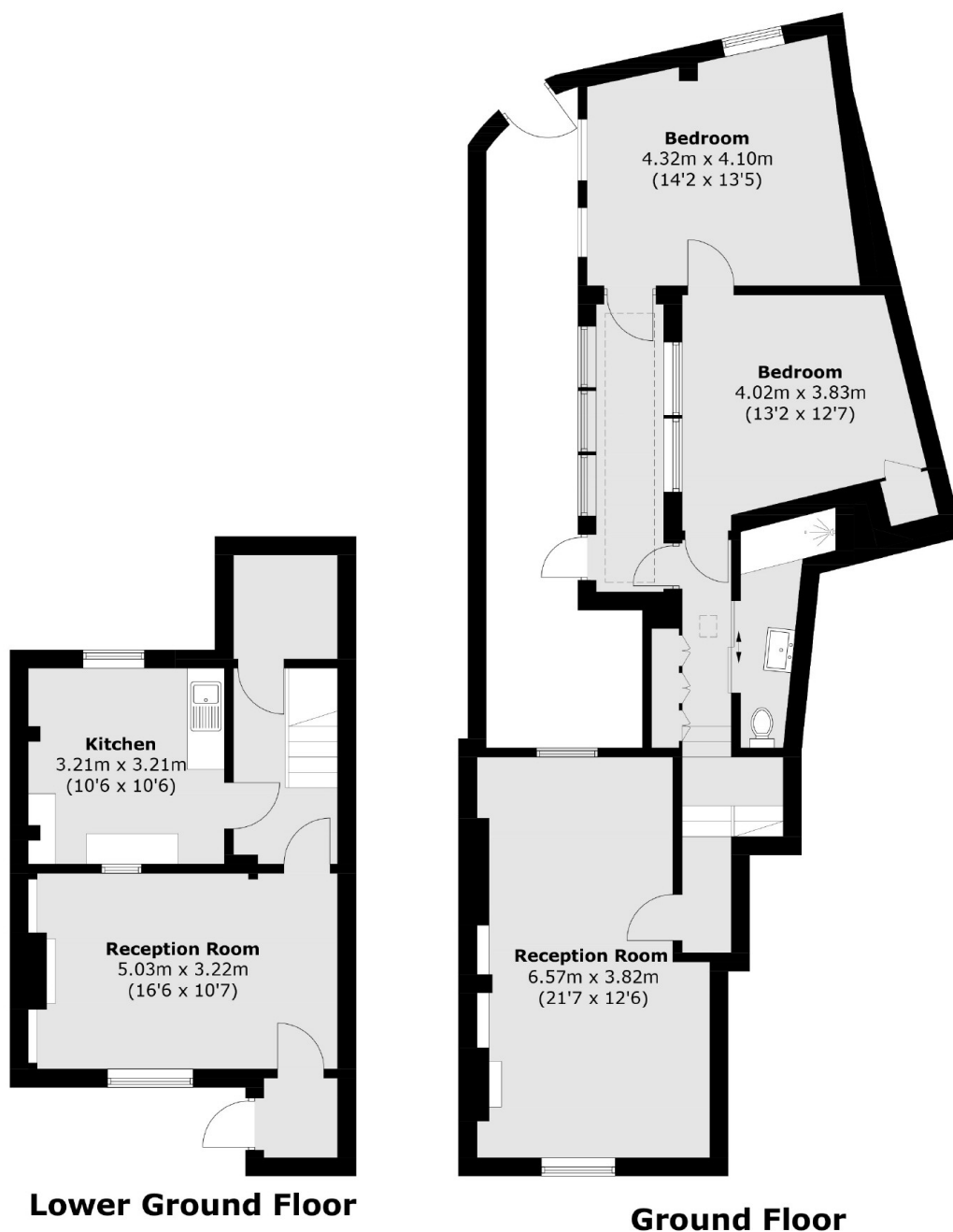

Total area (approx.): 110.3 sq. m (1,187.2 sq. ft)
(Including Basement) (Excluding Patio)