

Sloane Avenue, SW3

£460 Per week

A recently refurbished studio on the eighth floor of a popular portered block with a lift. The studio has an abundance of built in storage, an open plan kitchen and expansive views of the city skyline.

Sloane Avenue Mansions is ideally located between Kings Road and Brompton Road in the heart of Chelsea. Just moments from all the exciting shops and restaurants of Sloane Avenue, Fulham Road, Walton Street and Kings Road.

Features

- Studio
- Lift
- Porter
- Recently Refurbished
- Wooden Floors
- Eighth Floor

Sloane Avenue, London, SW3

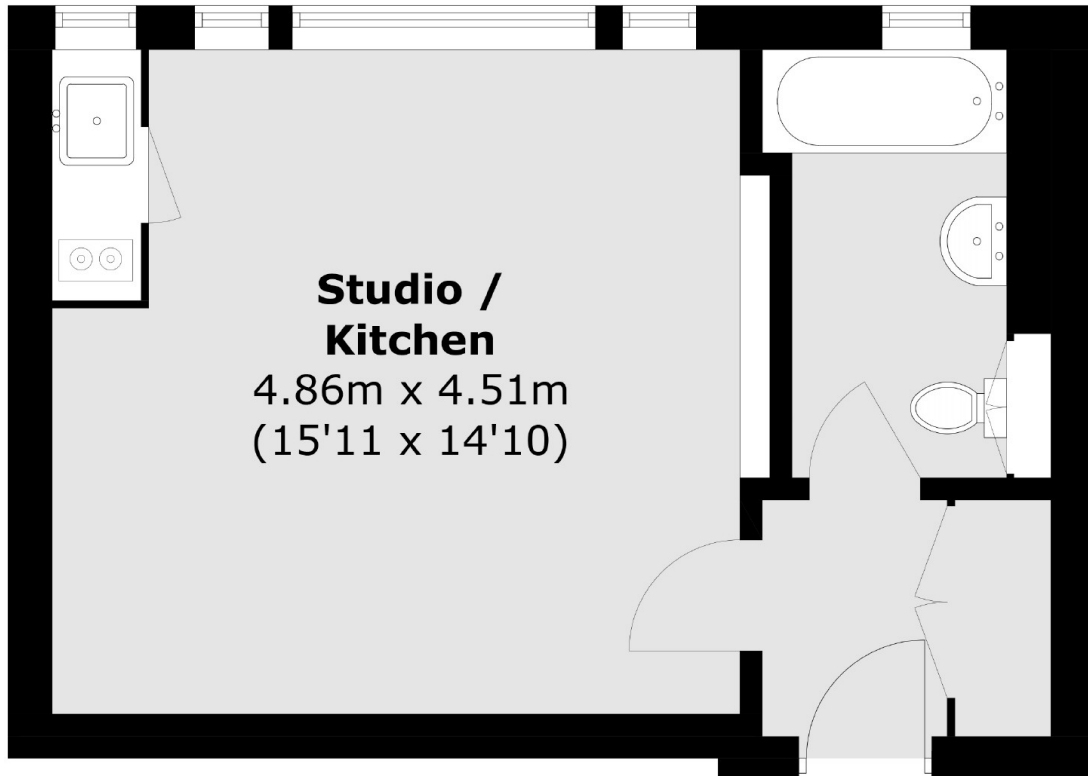

Total area (approx.): 30.8 sq. m (331.5 sq. ft)