



## Chelsea Manor Street, SW3

£770 Per week

An opportunity to be the first person to live in this brand newly refurbished one bedroom flat in a popular mansion block on Chelsea Manor Street. The flat has been done up to the highest standard throughout.

Chesil Court is located on Chelsea Manor Street. Located just south of the World famous Kings Road and all of the boutiques, restaurants and delights that it has to offer.

### Features

- Brand Newly Refurbished
- One Bedroom
- Ground Floor
- Portered Building
- Separate Kitchen
- Built In Storage

# Chelsea Manor Street, London, SW3

## Ground Floor

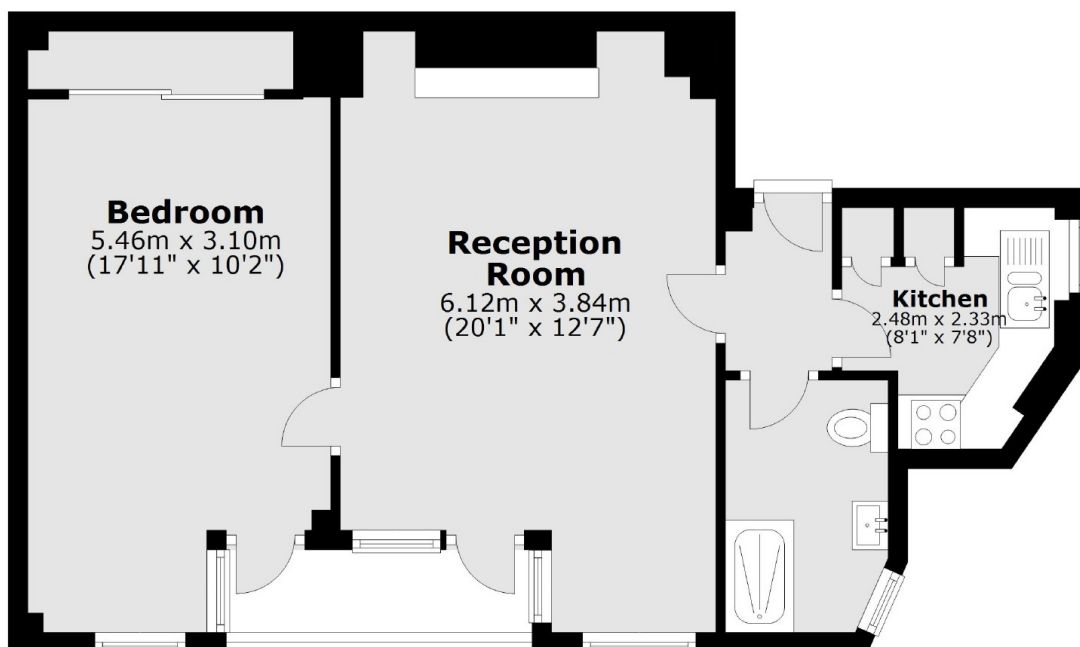

Total area: approx. 51.4 sq. metres (553.5 sq. feet)