



Chelsea Cloisters, SW3

£265,000

A refurbished studio apartment located on the eighth floor of a portered building. This property would work excellently as a buy to let investment or London base.

Chelsea Cloisters is located between Sloane Square and South Kensington tube stations. The world famous shops and restaurants the King's Road have to offer are also within walking distance.

Features

Eighth Floor
Great Condition
Long Leasehold
Porter
Popular Location
Studio Apartment

Chelsea Cloisters, London, SW3

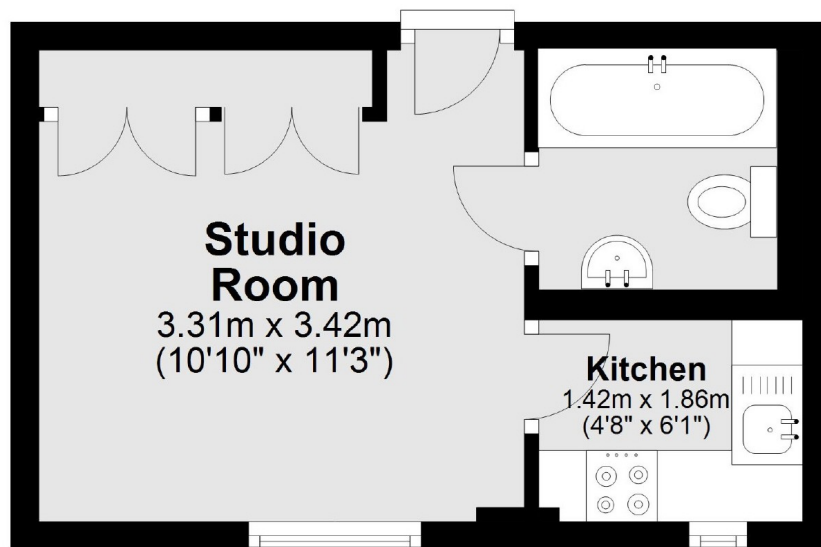

Total area: approx. 17.8 sq. metres (191.9 sq. feet)