



Sloane Avenue, SW3

£519 Per week

A top floor one bedroom flat to let in a very popular art deco portered building in the heart of Sloane Square in Chelsea. The property is perfect for a single professional or student.

Sloane Avenue is situated in the heart of Chelsea and moments from the King's Road and the Fulham Road making it ideally positioned for the many local amenities. Sloane Square and South Kensington offer the closest transport links (Circle, District and Piccadilly lines).

Features

- One Bedroom
- Built in Storage
- Modern Bathroom
- Top Floor
- Open Plan Kitchen
- On Site Porter

Sloane Avenue, London, SW3

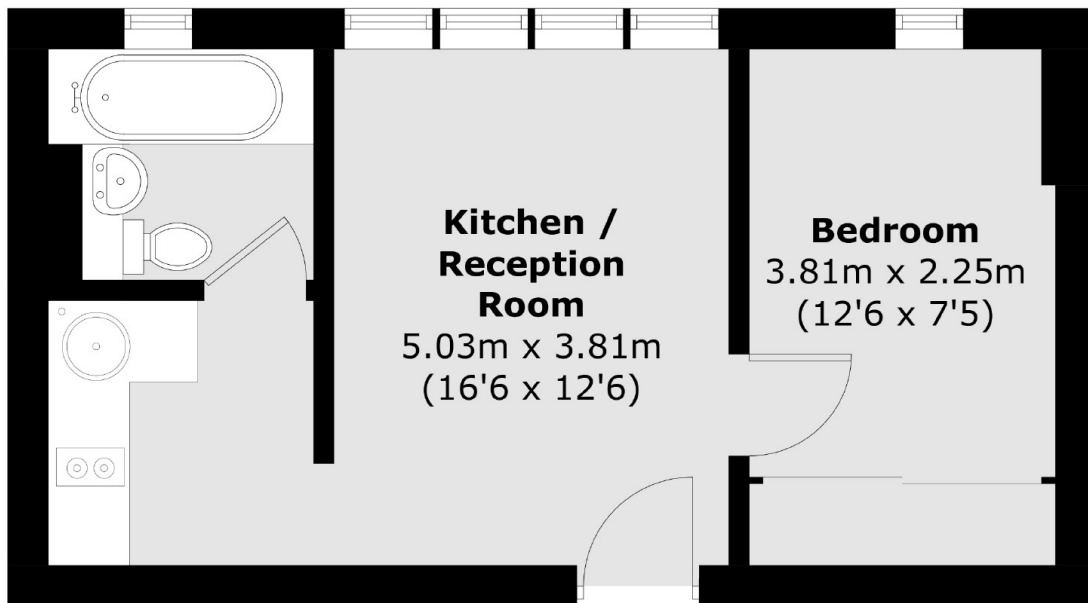

Total area (approx.): 28.3 sq. m (304.6 sq. ft)