



Upper Berenger Walk, SW10 £295,000

A bright studio now in need of refurbishment within the World's End Estate. The property is located on the fourth floor (with lift) and would be an excellent London base or rental investment.

Upper Berenger Walk is located within the World's End Estate, tucked away from the hustle and bustle of the Kings Road and Chelsea Embankment. An array of shops, transport links, restaurants and cafés are moments away.

Features

- Lift
- Studio
- Unmodernised
- Fourth Floor
- Leasehold
- Great Rental Investment

Upper Berenger Walk, London, SW10

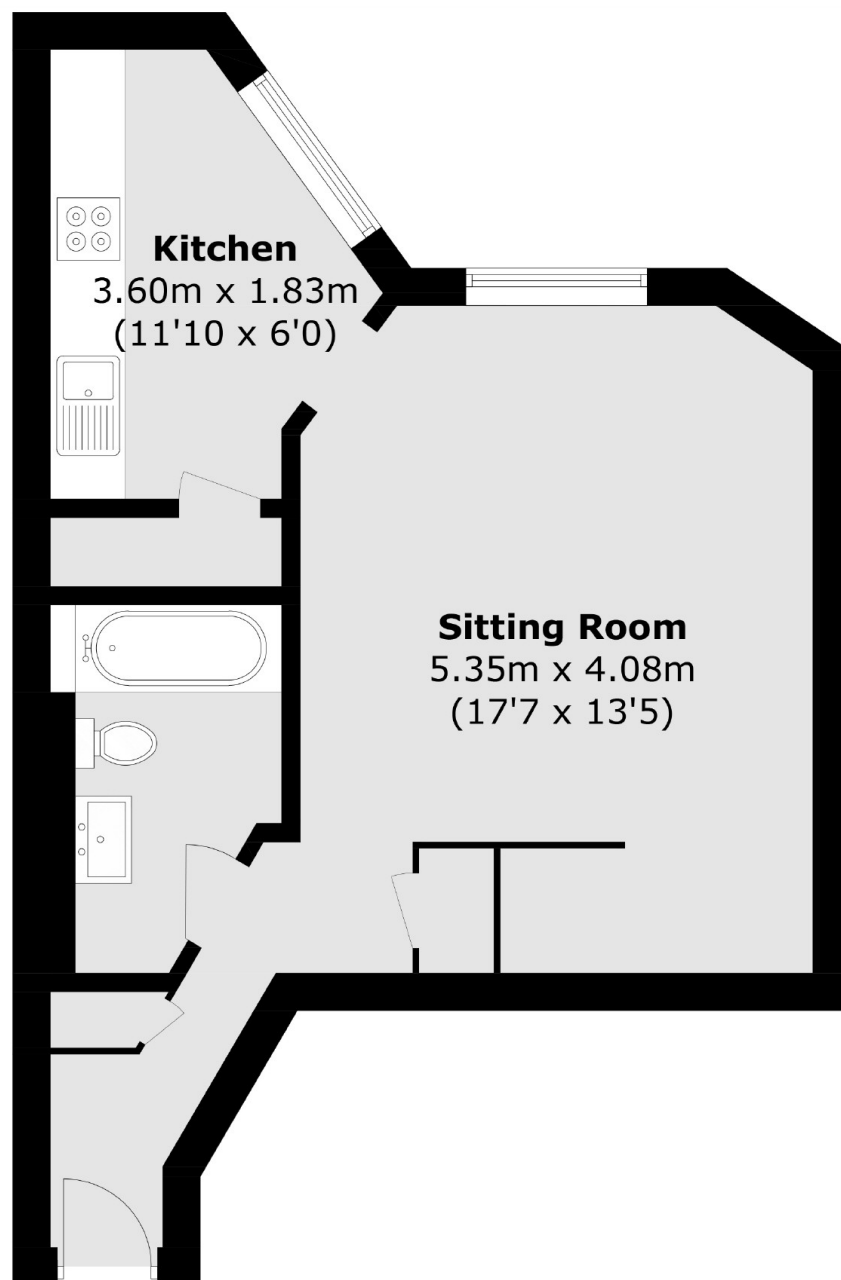

Fourth Floor

Total area (approx.): 39.3 sq. m (423.0 sq. ft)